



90 HUDSON

JERSEY CITY

FOR FURTHER INFORMATION,
PLEASE CONTACT:

NEIL SETH 212 841 5063
neil.seth@cushwake.com

DAVID TOWNES 917 993 5515
david.townes@cushwake.com

ALANA FRIEDMAN 201 508 5258
alana.friedman@cushwake.com



11,403 SF GROUND RETAIL PRIME HUDSON STREET LOCATION

Approximately 100' Frontage
on Grand Street and
Possibilities to Expand

- State-of-the-art Class A office building
- Rare retail opportunity on Grand St.
- Across from a brand new CVS and Row House coming soon
- Located on the Light Rail and within 2 blocks of the Exchange Place PATH Station
- Over 5mm SF of office RSF within 3 blocks
- Over 3K residential units (built/planned) within 3 blocks
- Directly across from 99 Hudson—to be the tallest building in NJ
- Flexible divisions
- High ceilings
- Manhattan skyline and waterfront views

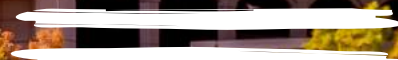
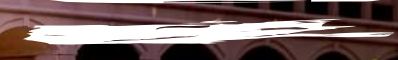
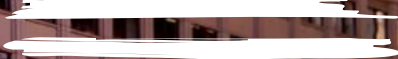
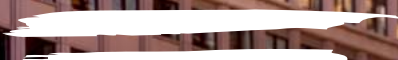

99 HUDSON

JERSEY CITY



CUSHMAN &
WAKEFIELD



HUDSON STREET

YORK STREET

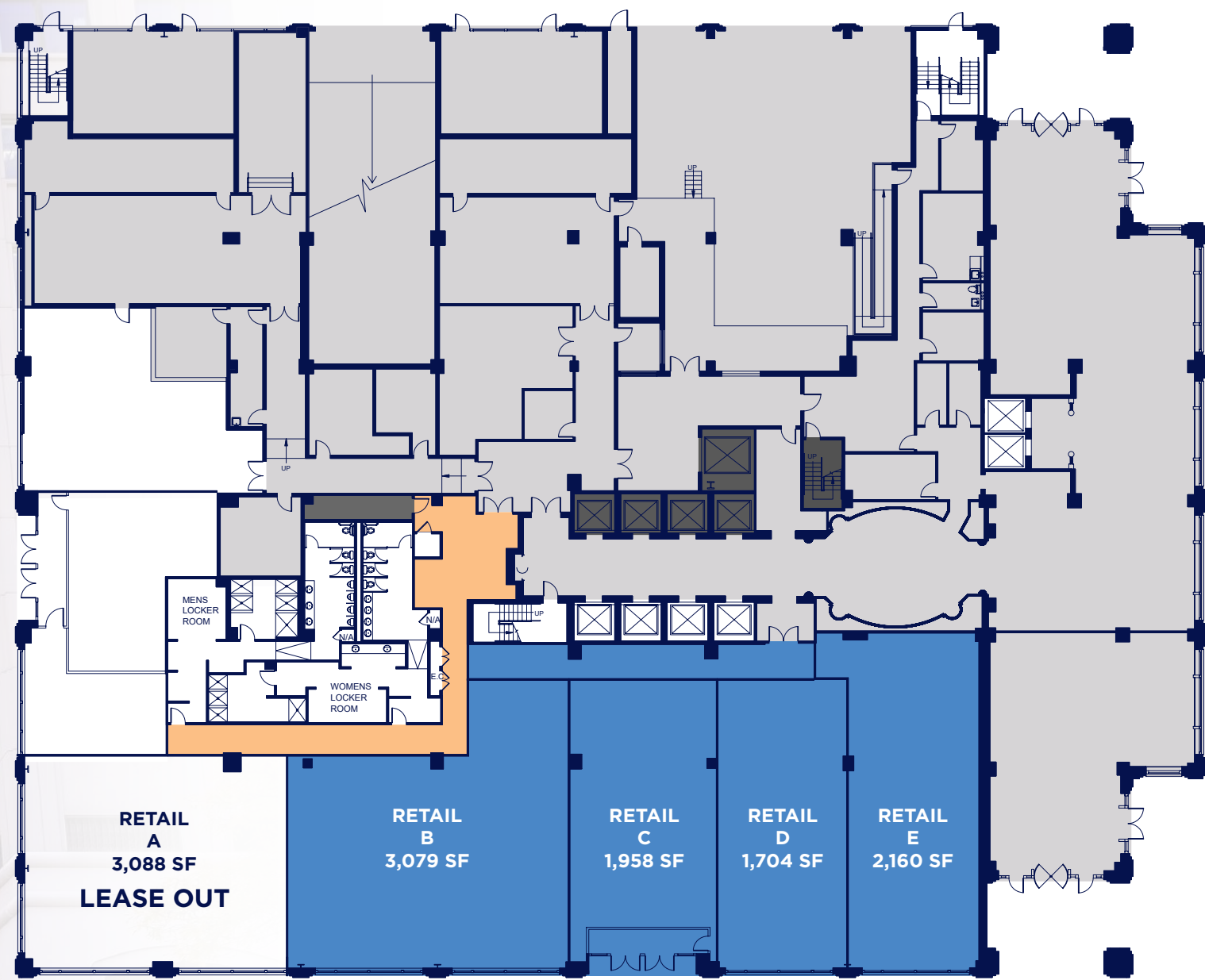

GRAND STREET

Decorative blue brush strokes above the title.

90 HUDSON

JERSEY CITY

Decorative blue brush strokes below the title.

WHERE INNOVATION
WORKS WITH ACCESS,
VIBRANCY, AND A
SPOT-ON VIEW.

RETAIL CO-TENANCY:

CVS, Row House, CAVA, B. Good,
Au Bon Pain, Whole Foods, Starbuck’s,
Gregory’s Coffee

OFFICE CO-TENANCY:

Lord Abbott, TD Ameritrade, Goldman
Sachs, RBS, Bank of America, Citigroup,
Fidelity Investments

FOR FURTHER INFORMATION,
PLEASE CONTACT:

NEIL SETH **212 841 5063**
neil.seth@cushwake.com

DAVID TOWNES **917 993 5515**
david.townes@cushwake.com

ALANA FRIEDMAN **201 508 5258**
alana.friedman@cushwake.com





90 HUDSON

JERSEY CITY

FOR FURTHER INFORMATION,
PLEASE CONTACT:

NEIL SETH **212 841 5063**
neil.seth@cushwake.com

DAVID TOWNES **917 993 5515**
david.townes@cushwake.com

ALANA FRIEDMAN **201 508 5258**
alana.friedman@cushwake.com