

HIGH TECH CREATIVE SPACE  
AVAILABLE FOR LEASE



# 1555 East Orangewood Drive | Phoenix, AZ



## Property Features

- Convenient Location with Easy Access to Midtown Phoenix
- Close to Restaurant Amenities
- Immediate Freeway Access via SR-51 Highway
- Common Conference Room for Use
- Covered Parking Available
- High Tech Space
- Great Lobby Entrance
- Suite 1: ±1,894 RSF
- **Lease Rate: \$20.00/SF Full Service Gross Less Janitorial**

For more information:

**Gordon Raguse**  
Managing Director  
+1 602 224 4452  
gordon.raguse@cushwake.com

2555 E. Camelback Rd, Suite 400  
Phoenix, Arizona 85016  
ph:+1 602 954 9000  
fx:+1 602 468 8588  
**cushmanwakefield.com**



# 1555 East Orangewood Drive

Phoenix, AZ

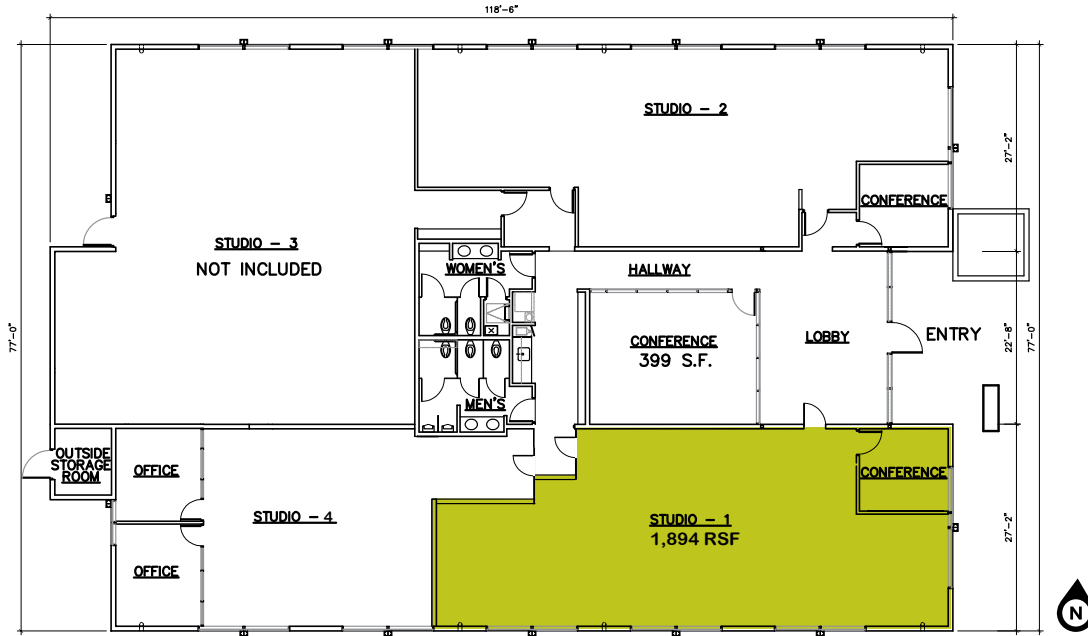

For more information:

**Gordon Raguse**  
Managing Director  
+1 602 224 4452  
gordon.raguse@cushwake.com

2555 E. Camelback Rd, Suite 400  
Phoenix, Arizona 85016  
ph:+1 602 954 9000  
fx:+1 602 468 8588  
cushmanwakefield.com



The information contained herein was obtained from sources we consider reliable. We cannot be responsible, however, for errors, omissions, prior sales, withdrawal from the market or change in price. Seller and broker make no representation as to the environmental condition of the property and recommend purchaser's independent investigation.

