

4115-4119
Business Center
Fremont, California

- » ±7,700 SF
- » APN 525 1250 058
- » ±2,837 SF Office

- » ±3,119 SF Mezzanine
(not included in the total SF)
- » Two Separate Entrances

- » ±3.76/1000 Parking
- » ±14' Clear Height

- » Monthly HOA
±\$504.35
- » 2 Grade Level Doors

For Sale



CHIP SUTHERLAND
Executive Vice President
Lic. 01014633
+1 408 453 7410
chip.sutherland@cbre.com

LISA WALSH STUDER
Client Services Coordinator
Lic. 01264320
+1 408 467 7530
lisa.studer@cbre.com

CBRE, Inc.
225 W Santa Clara Street
12th Floor
San Jose, CA 95113
www.cbre.com/siliconvalley

CBRE

Site Plan



4115-4119
Business Center



For Sale

4115-4119
Business Center
Fremont, California

CHIP SUTHERLAND
Executive Vice President
Lic. 01014633
+1 408 453 7410
chip.sutherland@cbre.com

LISA WALSH STUDER
Client Services Coordinator
Lic. 01264320
+1 408 467 7530
lisa.studer@cbre.com

CBRE, Inc.
225 W Santa Clara Street
12th Floor
San Jose, CA 95113
www.cbre.com/siliconvalley

Floor Plan

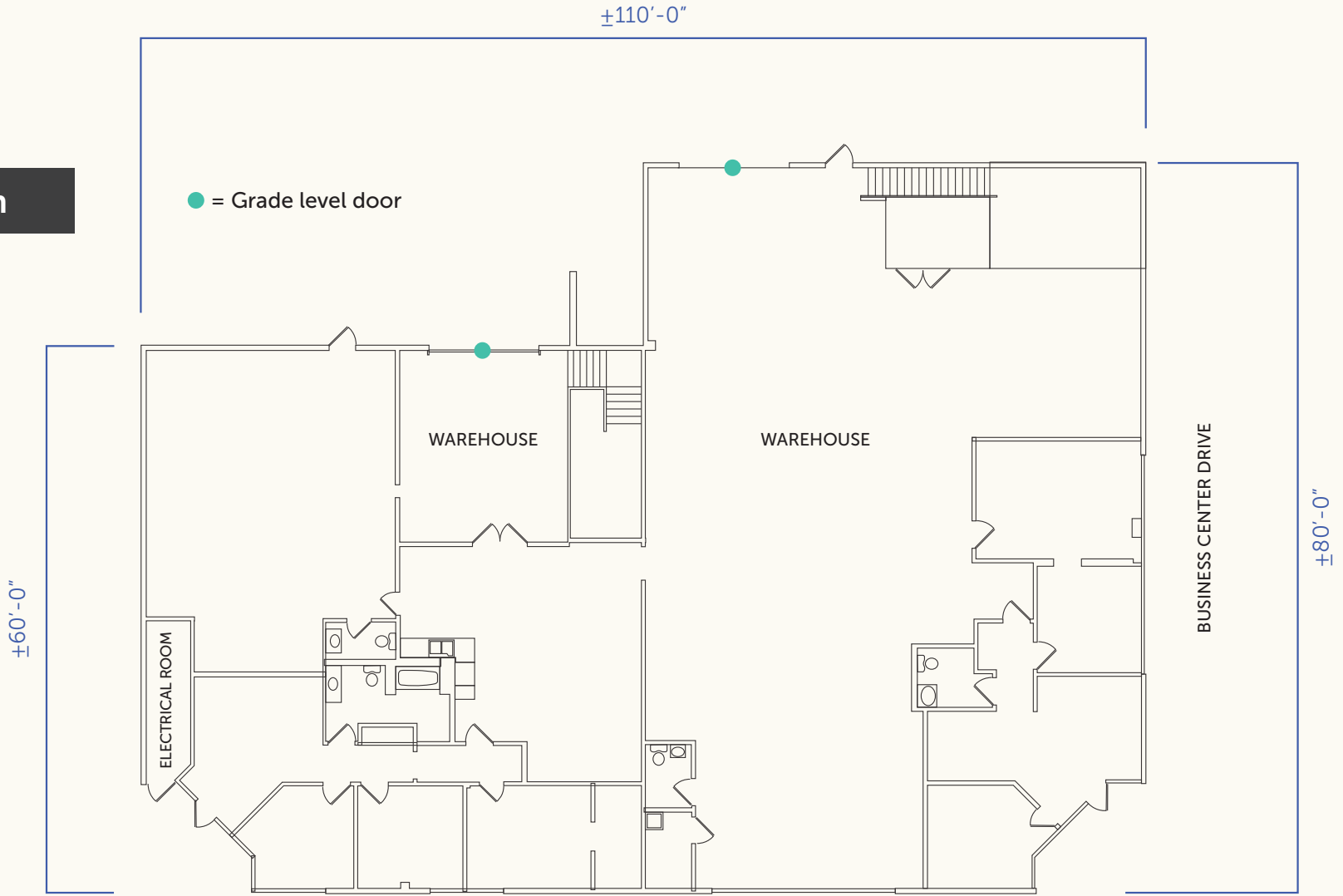

For Sale

4115-4119
Business Center
Fremont, California

CHIP SUTHERLAND
Executive Vice President
Lic. 01014633
+1 408 453 7410
chip.sutherland@cbre.com

LISA WALSH STUDER
Client Services Coordinator
Lic. 01264320
+1 408 467 7530
lisa.studer@cbre.com

CBRE, Inc.
225 W Santa Clara Street
12th Floor
San Jose, CA 95113
www.cbre.com/siliconvalley

Amenities Aerial



For Sale

4115-4119
Business Center
Fremont, California

CHIP SUTHERLAND
Executive Vice President
Lic. 01014633
+1 408 453 7410
chip.sutherland@cbre.com

LISA WALSH STUDER
Client Services Coordinator
Lic. 01264320
+1 408 467 7530
lisa.studer@cbre.com

CBRE, Inc.
225 W Santa Clara Street
12th Floor
San Jose, CA 95113
www.cbre.com/siliconvalley

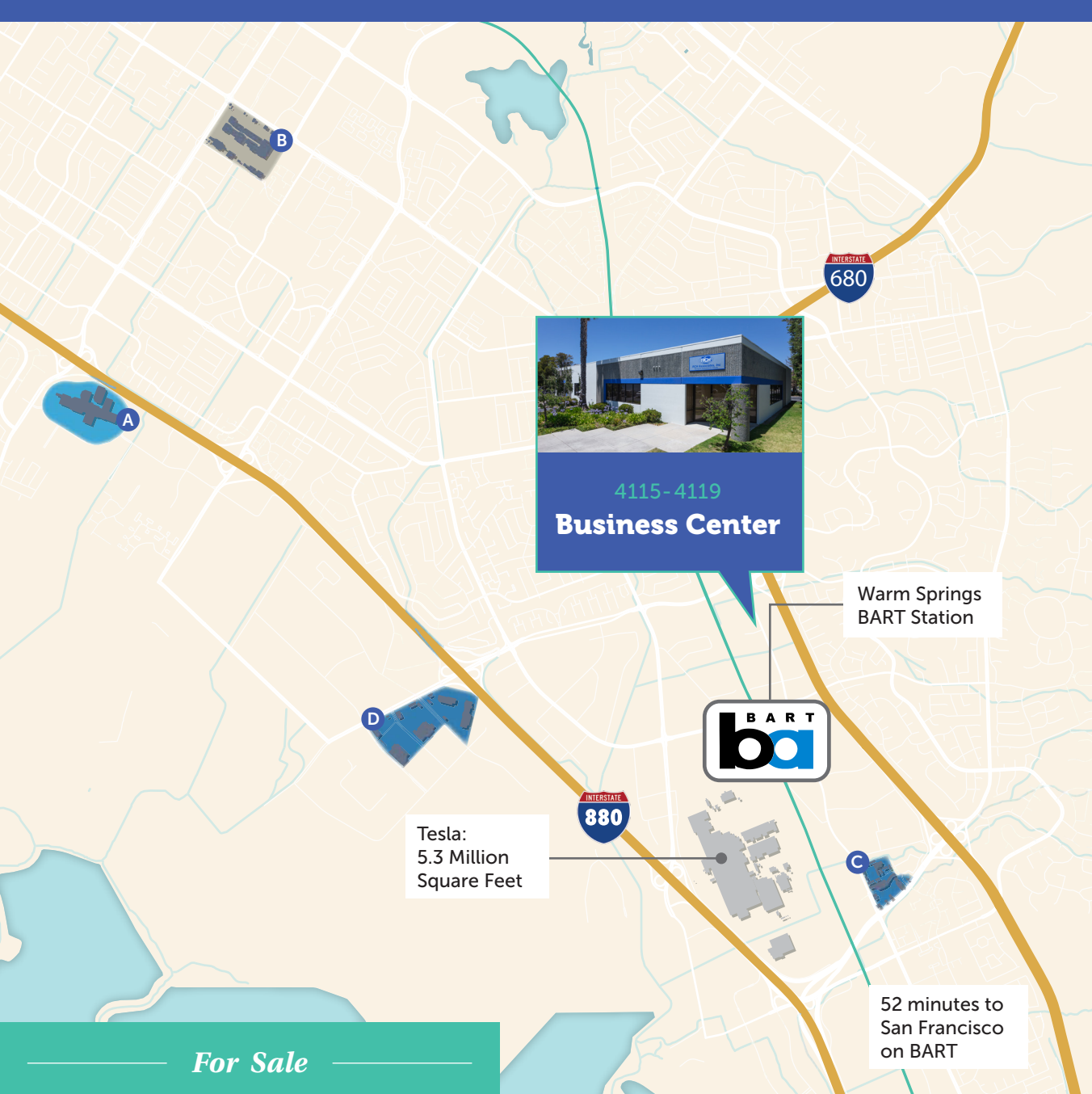

Amenities Map

A Newpark Mall

- | | | | |
|-------------------|-------------------|----------------------|---------------|
| RETAIL | Forever 21 | RESTAURANT | COFFEE |
| Sears | Hollister Co. | Taqueria La Tita | Starbucks |
| Bath & Body Works | Macy's | Pieology | |
| Charlotte Russe | Victoria's Secret | Anderson Bakery | |
| Disney Store | JCPenney | Hibachi San | |
| Express | | Hi Seoul Korean Cafe | |

B 11 minutes to Fremont Hub

- | | |
|------------------------|---------------------------|
| RETAIL | RESTAURANT |
| Target | Jack's Brewing Company |
| Marshalls | Popeyes Louisiana Kitchen |
| Sprouts Farmers Market | Nothing Bundt Cakes |
| Ross Dress for Less | Posh Bagel |
| Michaels | Amia Bakery |
| Safeway | MOD Pizza |
| CVS Pharmacy | Chili's Grill & Bar |
| Staples | COFFEE |
| GameStop | Starbucks |
| Payless ShoeSource | |

C Warm Springs Plaza

- | | | |
|---------------------|---------------------------|---------------|
| RETAIL | RESTAURANT | COFFEE |
| Ross Dress for Less | Beyond Thai | Starbucks |
| DD's Discounts | Chaat House | Tea Papa |
| CVS Pharmacy | Grand Harbor | |
| | Little Dipper Shabu Shabu | |
| | ZPizza | |
| | Denny's | |

D Pacific Commons Shopping Center

- | | |
|-----------------------|------------------------|
| RETAIL | RESTAURANT |
| Nordstrom Rack | In-N-Out Burger |
| DSW | Claim Jumper |
| Kohl's | Panera Bread |
| Target | P.F. Changs |
| Men's Warehouse | Market Broiler |
| Lowe's | Blaze Pizza |
| Costco | Buffalo Wild Wings |
| Dick's Sporting Goods | The Habit Burger Grill |
| Carter's | |
| Old Navy | COFFEE |
| Ulta Beauty | Tapioca Express |

For Sale

4115-4119
Business Center
 Fremont, California

CHIP SUTHERLAND
 Executive Vice President
 Lic. 01014633
 +1 408 453 7410
 chip.sutherland@cbre.com

LISA WALSH STUDER
 Client Services Coordinator
 Lic. 01264320
 +1 408 467 7530
 lisa.studer@cbre.com

CBRE, Inc.
 225 W Santa Clara Street
 12th Floor
 San Jose, CA 95113
 www.cbre.com/siliconvalley



4115-4119

Business Center

Fremont, California

CHIP SUTHERLAND
Executive Vice President
Lic. 01014633
+1 408 453 7410
chip.sutherland@cbre.com

LISA WALSH STUDER
Client Services Coordinator
Lic. 01264320
+1 408 467 7530
lisa.studer@cbre.com

CBRE, Inc.
225 W Santa Clara Street
12th Floor
San Jose, CA 95113
www.cbre.com/siliconvalley

© 2018 CBRE, Inc. All rights reserved. This information has been obtained from sources believed reliable, but has not been verified for accuracy or completeness. You should conduct a careful, independent investigation of the property and verify all information. Any reliance on this information is solely at your own risk. CBRE and the CBRE logo are service marks of CBRE, Inc. All other marks displayed on this document are the property of their respective owners.

CBRE

For Sale