

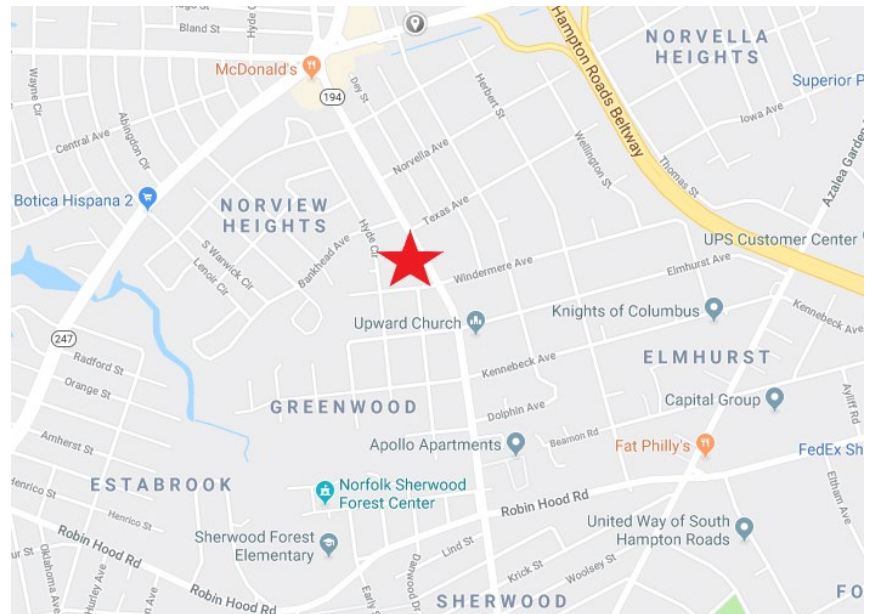

### Property Features

- 5,541 total SF:
  - ± 1,293 SF office space with bathroom
  - ± 4,248 SF warehouse space
- Three 8' x 8' grade level loading doors:
  - Two drive-through bays
- Single phase, 120/240 V electric
- 10'9" clear height
- C-C zoning (Community Commercial)
- Available for immediate occupancy
- **Sale Price: \$215,000 (\$38.80 PSF)**



For more information, contact:

**GEOFF POSTON, CCIM, SIOR**  
Vice President  
757 213 4161  
geoff.poston@thalhimer.com

**BRETT SAIN**  
Associate  
757 213 4153  
brett.sain@thalhimer.com

The Town Center of Virginia Beach  
222 Central Park Ave., Suite 1820  
Virginia Beach, VA 23462  
www.thalhimer.com

Independently Owned and Operated / A Member of the Cushman & Wakefield Alliance

Cushman & Wakefield | Thalhimer © 2015. No warranty or representation, express or implied, is made to the accuracy or completeness of the information contained herein, and same is submitted subject to errors, omissions, change of price, rental or other conditions, withdrawal without notice, and to any special listing conditions imposed by the property owner(s). As applicable, we make no representation as to the condition of the property (or properties) in question.



For more information, contact:

**GEOFF POSTON, CCIM, SIOR**  
Vice President  
757 213 4161  
[geoff.poston@thalhimer.com](mailto:geoff.poston@thalhimer.com)

**BRETT SAIN**  
Associate  
757 213 4153  
[brett.sain@thalhimer.com](mailto:brett.sain@thalhimer.com)

The Town Center of Virginia Beach  
222 Central Park Ave., Suite 1820  
Virginia Beach, VA 23462  
[www.thalhimer.com](http://www.thalhimer.com)

Independently Owned and Operated / A Member of the Cushman & Wakefield Alliance

Cushman & Wakefield | Thalhimier © 2015. No warranty or representation, express or implied, is made to the accuracy or completeness of the information contained herein, and same is submitted subject to errors, omissions, change of price, rental or other conditions, withdrawal without notice, and to any special listing conditions imposed by the property owner(s). As applicable, we make no representation as to the condition of the property (or properties) in question.

**BUILDING PLAN**

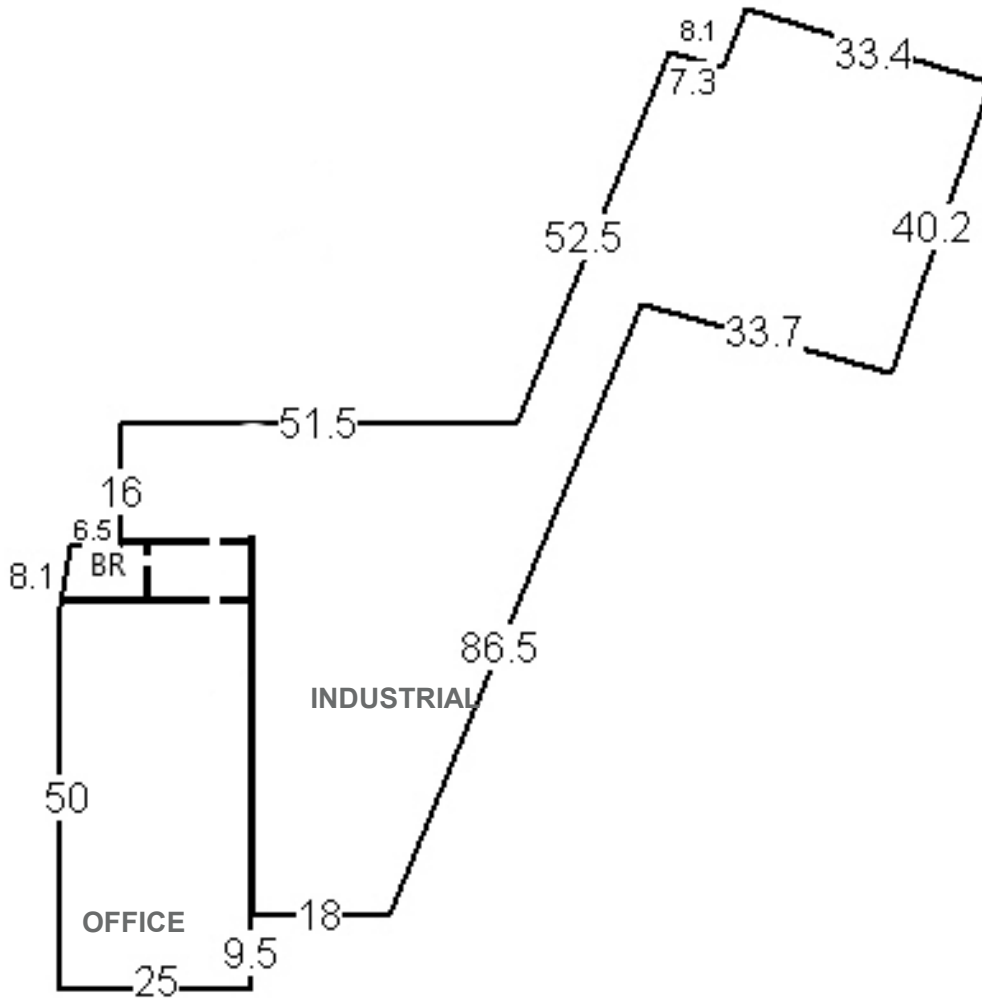

For more information, contact:

**GEOFF POSTON, CCIM, SIOR**  
Vice President  
757 213 4161  
geoff.poston@thalhimer.com

**BRETT SAIN**  
Associate  
757 213 4153  
brett.sain@thalhimer.com

The Town Center of Virginia Beach  
222 Central Park Ave., Suite 1820  
Virginia Beach, VA 23462  
www.thalhimer.com