

**Property Owner****Name:** REGIONAL MEDICAL SERVICES  
CENTER LLC**Mailing Address:** 303 N WALNUT ST STE 2  
HARRISON, AR 72601-4334**Type:** (CI) Comm. Impr.**Over 65 Freeze:** No**Tax Dist:** (1C) Harrison**Size (Acres):** 0.440**Extended Legal:** PT NE SE**Property Information****Physical Address:** 813 MAIN N**Subdivision:** HARRISON CITY ACREAGE 4-18-20**Block / Lot:** -- / --**S-T-R:** 04-18-20**Market and Assessed Values:**

	Estimated Market Value	Full Assessed (20% Mkt Value)	Taxable Value
<b>Land:</b>	\$23,950	\$4,790	\$4,790
<b>Building:</b>	461500	92300	92300
<b>Total:</b>	\$485,450	\$97,090	\$97,090

**Taxes:**

<b>Estimated Taxes:</b>	\$4,952
<b>Homestead Credit:</b>	\$0

Note: Tax amounts are estimates only. Contact the county tax collector for exact amounts.

**Land:**

Land Use	Size	Units
MAIN	19167	Sq. Ft.

**Special Assessments:**

Assessment	Tax Amount
S	\$18.00
<b>Totals: \$18.00</b>	

**Deed Transfers:**

Date	Book	Page	Deed Type	Stamps	Est. Sale	Grantee	Code	Type
6/5/2001	01	003928		0.00	\$0	REG.MEDICAL SERV.		
9/19/2000	00	006012		577.50	\$175,000	FAST		

**Details for Commercial Card 1:****Business Name(s):** REGIONAL MEDICAL SERVICES**Number of Units:****Site Work:** Excavate; Prep;**Foundation:** Concrete**Floor Struct:** Slab on Grade**Total Floor Area:** 11332**Floor Cover:** Asp.Tile**Ceilings:** None**Interior Finish:** DryWall

**Not a Legal Document.**  
Subject to terms and conditions.

[www.datascoutpro.com](http://www.datascoutpro.com)

**Struct. Frame:** Conc.Blk  
**Exterior Walls:** Conc.Blk  
**Ext. Wall Load:** LoadBear  
**Roof Struct.:** Wood.J&D  
**Roof Cover:**

**Insulation:** Ceilings;  
**Appliances:**  
**Plumbing:** None  
**Electric:** Avg.B  
**Misc:**

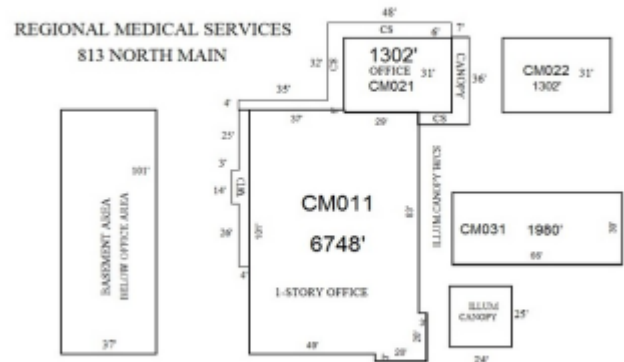

**Building: 1**

Age/YC	Condition	Effective Age	Stories	Grade
1960		27	1	
<b>Avg. Floor Area:</b>		<b>Common Wall:</b>		
<b>Avg. Perimeter:</b>		<b>Total Floor Area: 6748</b>		
<b>No. Floors:</b>		<b>Total Height:</b>		
<b>Avg. Floor Hgt:</b>		<b>Unit Multiplier: 1</b>		
<b>Occupancy</b>		<b>Heating/Cooling</b>	<b>Sprinkler</b>	
<b>Primary</b> Office Buildings - Comm. (100%)		N/A	N/A	
<b>Secondary</b> N/A		N/A	N/A	

**Building: 2**

Age/YC	Condition	Effective Age	Stories	Grade
1960		27	2	
<b>Avg. Floor Area:</b>		<b>Common Wall:</b>		
<b>Avg. Perimeter:</b>		<b>Total Floor Area: 2604</b>		
<b>No. Floors:</b>		<b>Total Height:</b>		

**Not a Legal Document.**  
 Subject to terms and conditions.

[www.datascoutpro.com](http://www.datascoutpro.com)

**Avg. Floor Hgt:****Unit Multiplier: 1**

<b>Occupancy</b>	<b>Heating/Cooling</b>	<b>Sprinkler</b>
<b>Primary</b> Office Buildings - Comm. (100%)	N/A	N/A
<b>Secondary</b> N/A	N/A	N/A

**Building: 3**

---

<b>Age/YC</b>	<b>Condition</b>	<b>Effective Age</b>	<b>Stories</b>	<b>Grade</b>
1960		27	1	

**Avg. Floor Area:****Common Wall:****Avg. Perimeter:****Total Floor Area:** 1980**No. Floors:****Total Height:****Avg. Floor Hgt:****Unit Multiplier: 1**

<b>Occupancy</b>	<b>Heating/Cooling</b>	<b>Sprinkler</b>
<b>Primary</b> SHOFFC (100%)	N/A	N/A
<b>Secondary</b> N/A	N/A	N/A

**Outbuildings and Yard Improvements:**

Item	Type	Size/Dim	Unit Multi.	Quality	Age
BASEMENT UNDER OFFICE	BASEMENT	3737			
Canopies	Office/Bank steel frame sec 15	536			
Canopies	Office/Bank steel frame sec 15	558			
CLOCK TOWER	CLOCK TOWER	4400			
Decks	Softwood, fir, pine, etc	302			
Paving	Asphalt, 3"-2" base	19176			
Paving	Concrete, 4" reinforced	158			
Paving	Concrete, 4" reinforced	409			
Paving	Concrete, 4" reinforced	536			
Paving	Parking bumpers (each)	18			
Signs	Metal, Painted Single face	3			
Signs	Wood, Painted Single face	8			
Canopies	Office/Bank steel frame sec 15	317			
Paving	Concrete, 4" reinforced	140			
Paving	Concrete, 6" reinforced	468			

Map:

---

