



CAPITOL
EQUITIES

DEVELOPMENT LAND FOR SALE

Learn more at capitolequities.com

HOOVER RD & STATE ROUTE 665 GROVE CITY, OH 43123

DEMOGRAPHICS (5-MILE; 2018)

Population:	67,750
5 Year Growth:	9.90%
Households:	25,515
Avg HH Income:	\$79,964
Employees:	25,637



DEVELOPMENT

Office/Medical
Outparcel (Retail/Office/Daycare)
Multifamily/Sr. Care/Assisted Living

PARCELS

7.42 acres
1.94 - 3.02 acres
10.2 acres

PURCHASE PRICE

Office/Medical \$275,000 per acre
Outparcels \$425,000 per acre
Multifamily/Sr. Care/Assisted Living \$225,000 per acre

LOCATION

- Prime location on Hoover Road @ Route 665
- Immediate access to I-71
- Next to brand new Mt Carmel Hospital Campus
- Adjacent to retail/commercial corridor and rapidly growing residential communities

LIKE TO GET MORE INFO?
We'd love to hear from you.

Todd Kemmerer

tkemmerer@capitolequities.com
P: 614.760.5660 x 126

J.R. Kern

jrkern@capitolequities.com
P: 614.760.5660 x 124

Capitol Equities Realty

P: 614.760.5660

580 N. Fourth Street, Suite 120
Columbus, Ohio 43215

capitolequities.com

The information contained herein was furnished by sources believed to be reliable, but it is not guaranteed, warranted or represented by Capitol Equities. The presentation of this property is submitted subject to errors, omissions, change of price or condition prior to sale or lease, or withdrawn without notice.



CAPITOL
EQUITIES

DEVELOPMENT LAND FOR SALE

HOOVER RD & STATE ROUTE 665 GROVE CITY, OH 43123

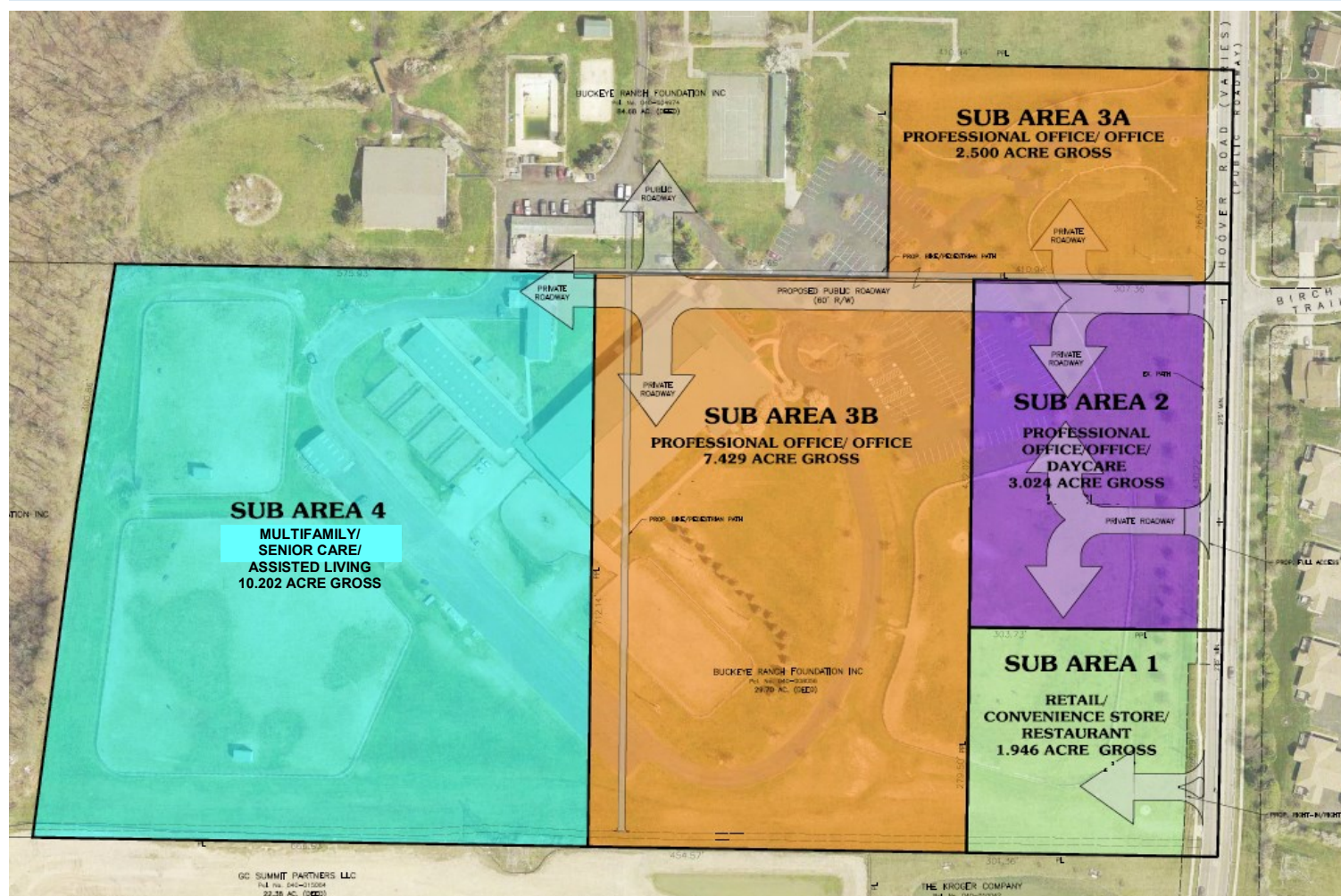

COMMUNITY + ACCESSIBILITY

- High traffic site at Route 665 (London Groveport Rd) and Hoover Road
- Close to retail & dining including: Kroger, Meijer, Strader's, CVS, Starbucks, McDonald's, Orangetheory Fitness, Tim Hortons, Wendy's, Petland, Waffle House, Subway, WesBanco, Key Bank and more
- Brand new Mt Carmel Medical Campus + Hospital just north of the site, as well as various medical offices including Ohio ENT, OSU Dermatology and more
- Easy interstate access to I-71 via Route 665
- Area distribution centers include Gap, Amazon, FedEx, T. Marzetti and more
- Next to new apartment communities including Grove City Summit, The Groves at 665, as well as expanding single-family home communities
- Site accessible to community walking and bike paths