

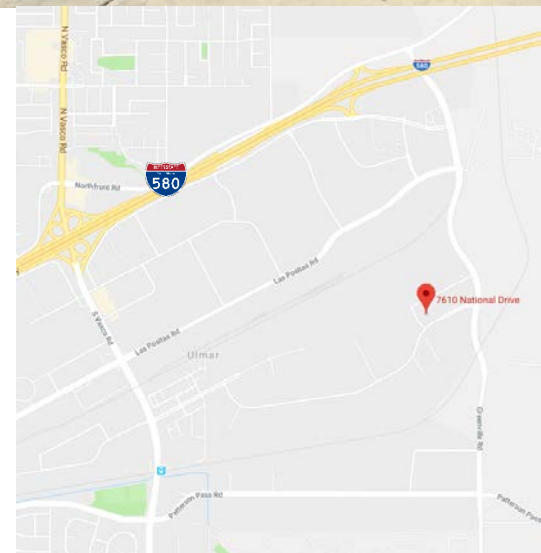

±4,060 SF Light Industrial Condo For Sale
Sale price: \$1,136,800 (\$280psf)

Property Highlights

- Size: ±4,060sf
- Approximately 50/50 office – warehouse
- Built in 2005
- HOA Dues are approximately \$0.15psf/month



For more information, please contact:

Chris Crabtree
Managing Director
+1 925 621 3850
chris.crabtree@cushwake.com

5000 Hopyard Road, Suite 205
Pleasanton, CA 94588
phone: +1 925 621 3840

FLOOR PLAN

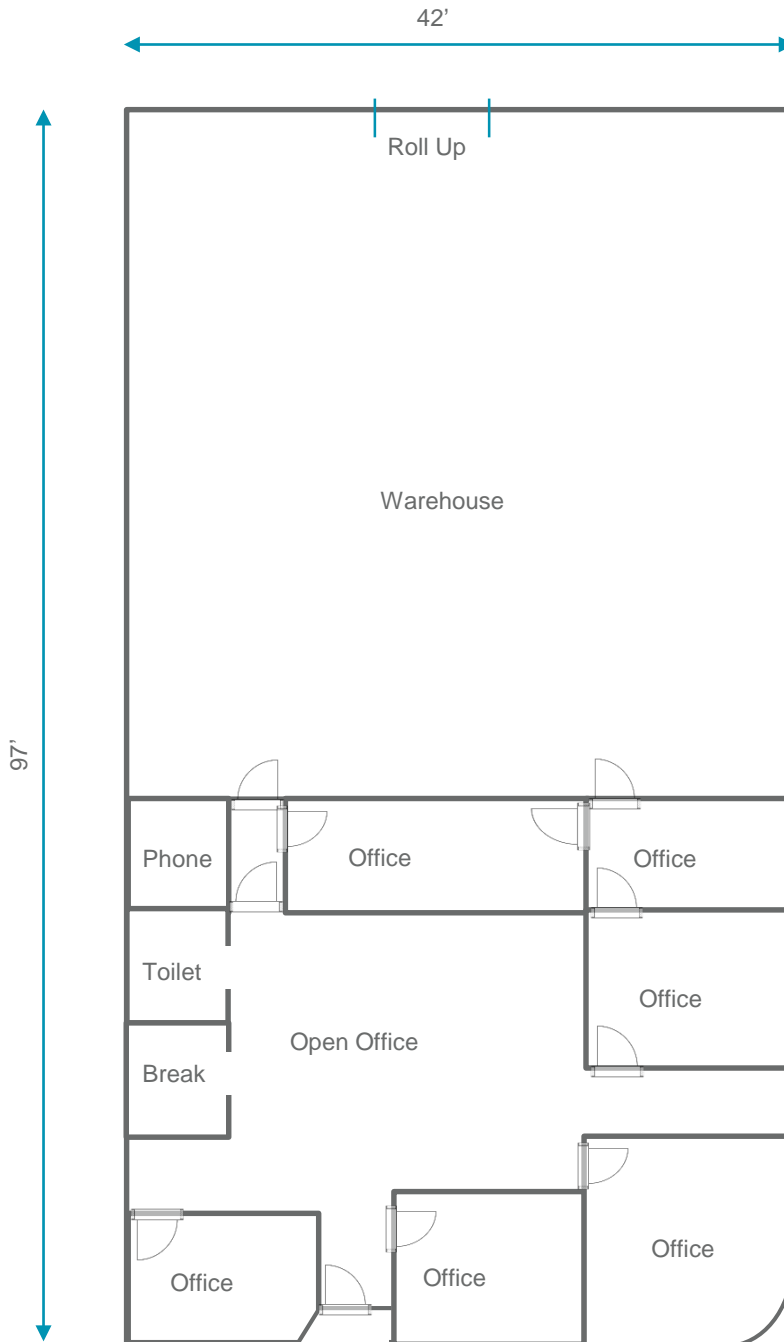

For more information, please contact:

Chris Crabtree
Managing Director
+1 925 621 3850
chris.crabtree@cushwake.com

5000 Hopyard Road, Suite 205
Pleasanton, CA 94588
phone: +1 925 621 3840

