



FOR LEASE
1201 E Yelm Avenue
Yelm, Washington



YELM PLAZA

First Western Properties, Inc. | 425.822.5522 | fwp-inc.com
11621 97th Lane NE, Kirkland, Washington 98034

1201 E YELM AVENUE:

- Available: 1,300 SF
- Former LimeBerry Frozen Yogurt
- Anchored by High Grossing Safeway
- Join: O’Bee Credit Union, Papa Murphy’s, Great Clips, & UPS Store
- Very Busy Center

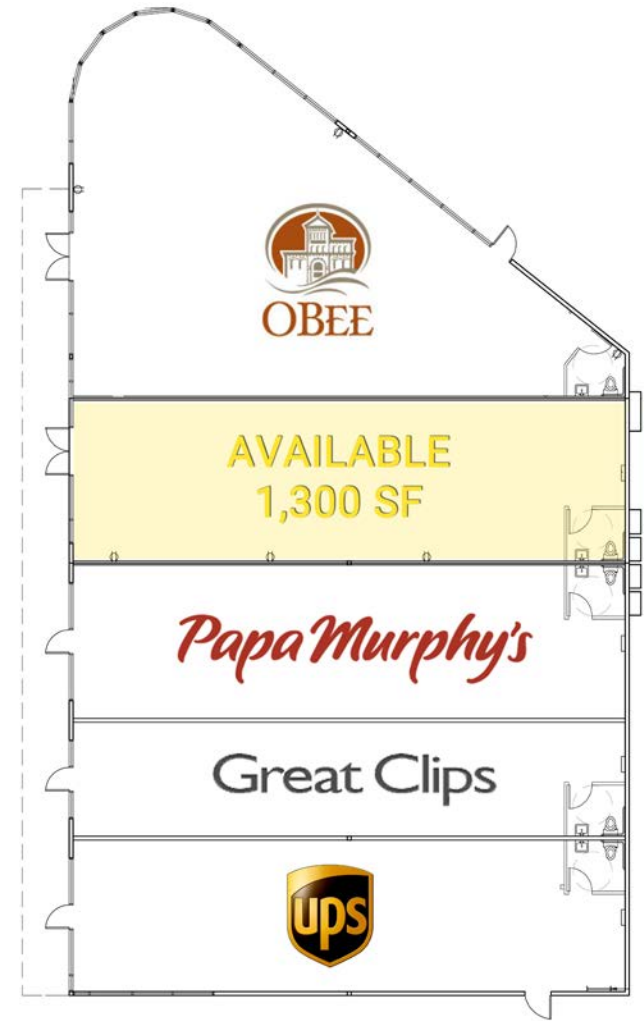

Population



Average HH Income

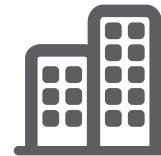

Daytime Population

Regis - 2018

	Population	Average HH Income	Daytime Population
Mile 1	3,589	\$69,601	2,610
Mile 3	17,776	\$68,527	4,512
Mile 5	23,612	\$71,785	5,533

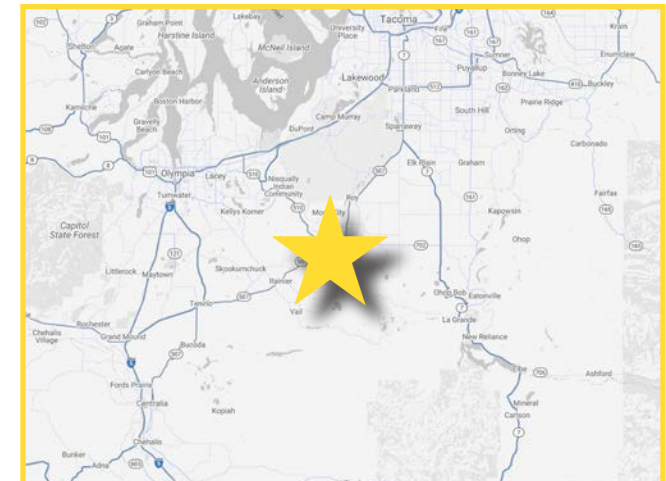

SITE

OBEE™
CREDIT UNION
Not a member? Not a problem!

ups

Papa Murphy's

Great Clips

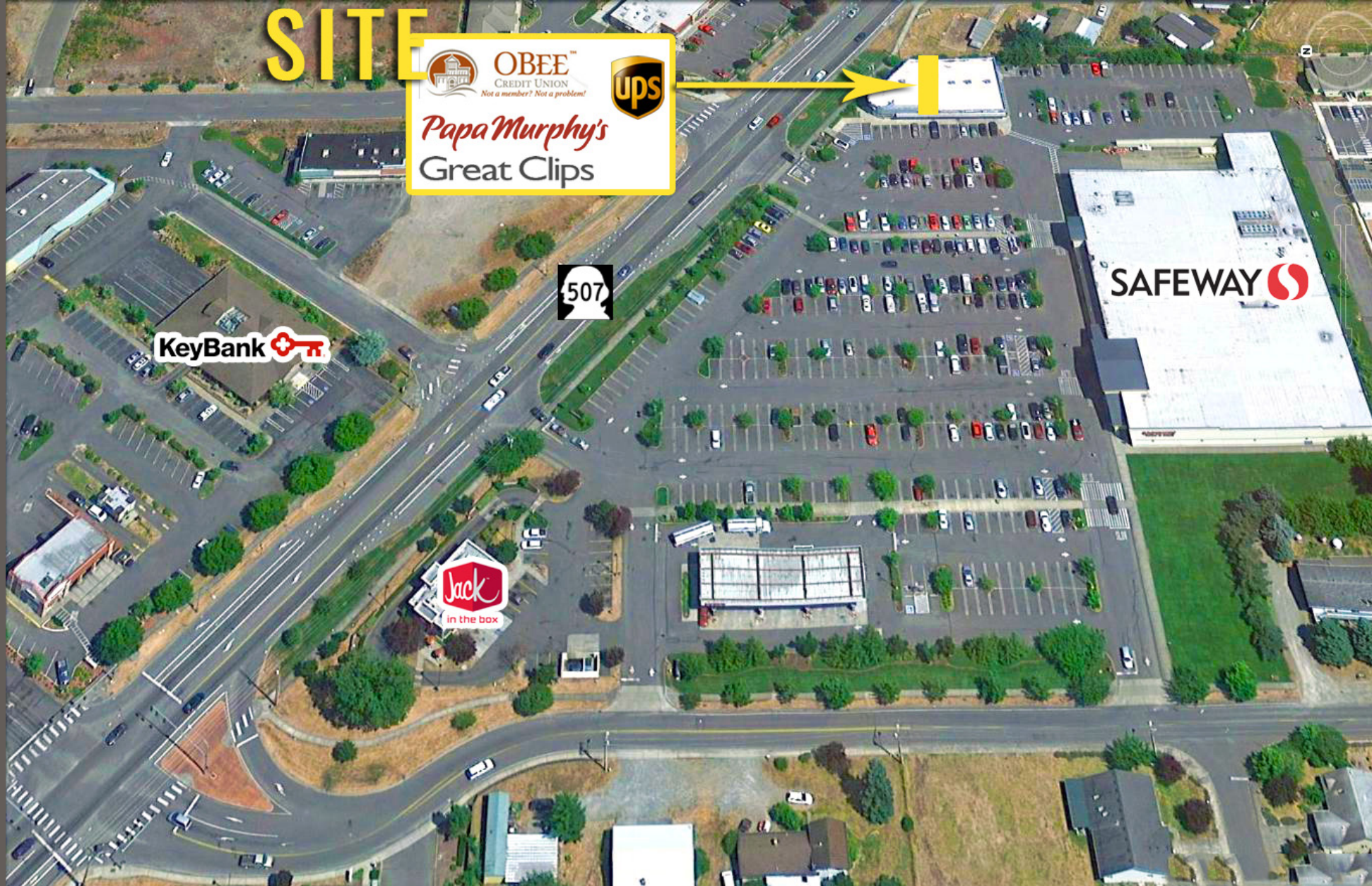

KeyBank

507

Jack
in the box

SAFeway



Located in the Heart of
Yelm Retail Core



Located on SR 507
Excellent Visibility!



19,000 ADT
E Yelm Ave (SR 507)



Flexible Rent Rate
Call for Details!

N



510

YELM MIDDLE



Goodwill KeyBank

SUBWAY

507

FORT STEVENS ELEMENTARY

True Value

MCKENNA ELEMENTARY

NAPA

Tires LES SCHWAB

SUBWAY

Walmart

RITE AID

UNITED STATES POSTAL SERVICE

Quiznos

507

MILL POND ELEMENTARY

SITE

RIDGELINE MIDDLE

AutoZone

PRAIRIE ELEMENTARY

KIRKLAND | TACOMA | PORTLAND



RETAIL FOCUSED. RESULTS DRIVEN.

NICK BARBER

425.250.3271
nbarber@fwp-inc.com

RALPH BARBER

425.822.5522
ralph@fwp-inc.com



First Western Properties, Inc. | 425.822.5522
11621 97th Lane NE Kirkland, WA 98034 | fwp-inc.com

© First Western Properties, Inc. DISCLAIMER: The above information has been secured from sources believed to be reliable, however, no representations are made to its accuracy. Prospective tenants or buyers should consult their professional advisors and conduct their own independent investigation. Properties are subject to change in price and/or availability without notice.