

MACARTHUR COMMONS



MACARTHUR BART, 40TH & TELEGRAPH, OAKLAND, CA 94609



LOCKEHOUSE

MACARTHUR COMMONS

A trio of distinctive new apartment buildings across from Oakland's MacArthur BART station. Sleek and modern with a retro vibe, MacArthur Commons provides the only significant retail offering with new Class A retail space in one of the Bay Area's most connected locations.



VIBRANT TEMESCAL

Known for its eclectic vibe, craft stores and great food, Temescal serves up a new surprise on every block. Join the community of retailers creating a unique sense of place in this historic neighborhood



A NEW MEETING PLACE

Urban Density: ±800 apartments under construction on this block
Outdoor plaza, called "The Mews" carefully designed to connect buildings and create community
28,000 SF of Retail space with up to 28 commercial parking stalls



CONNECTED TO IT ALL

Convenient to multiple Bay Area work centers including San Francisco, Emeryville, Downtown Oakland, Uptown, and UC Berkeley
Adjacent to one of the busiest BART stations in Oakland with over 18,000 riders daily



LOCKEHOUSE

LEASEABLE SPACES

Spaces A, B, C can be combined for a total of 10,806 SF

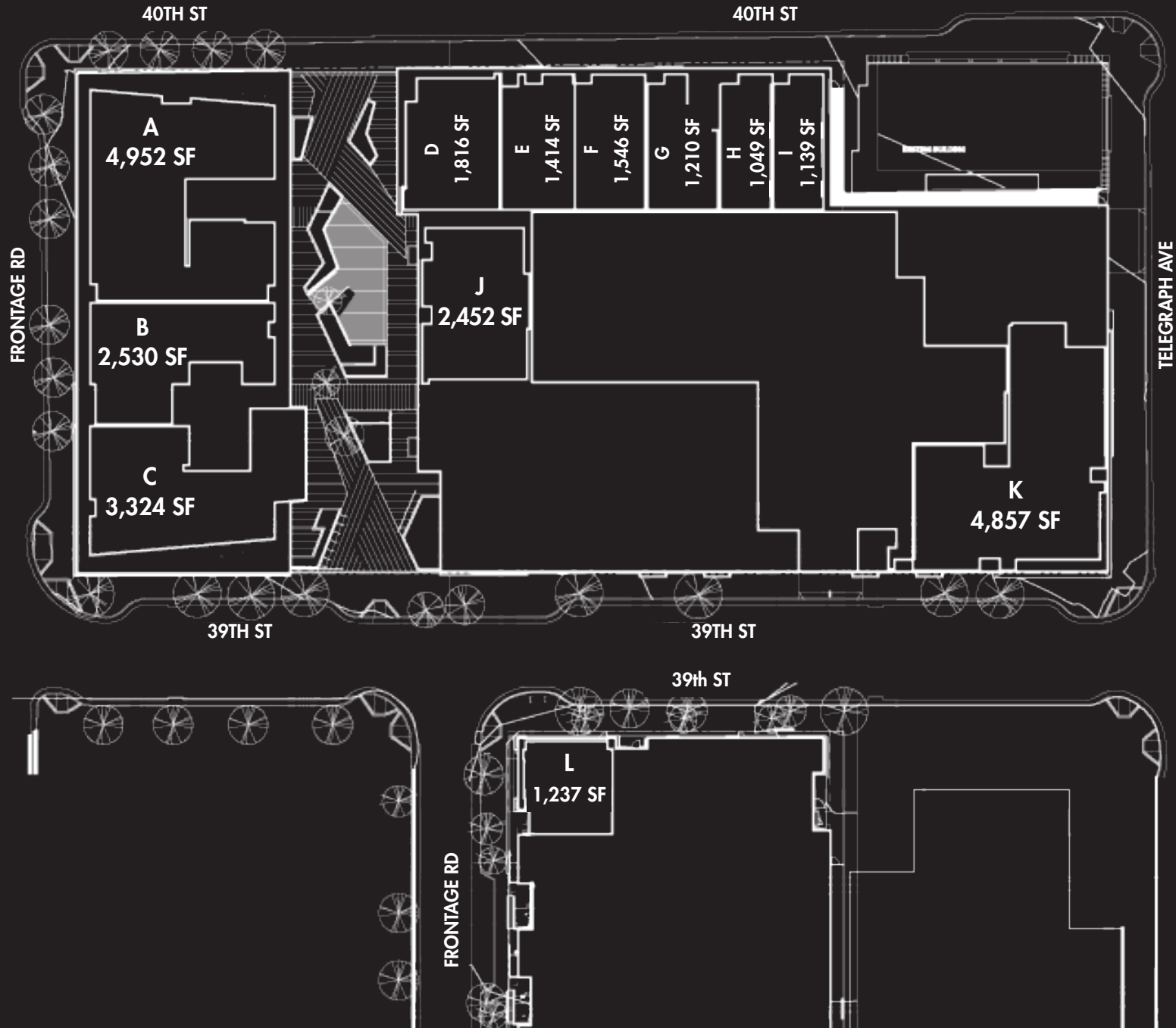

MARKET AERIAL



May 2019 Ridership
 Entries: 8,886
 Exits: 8,823



MACARTHUR COMMONS



INTERSTATE 580 - 236,000 ADT



Sutter Health
 Alta Bates Summit Medical Center

NEW DEVELOPMENTS

<p>1 51st Telegraph (Under Construction) ±200 residential units ±25,000 SF commercial</p>	<p>3 Temescal Apartments ±130 residential units ±8,700 commercial</p>	<p>5 MacArthur Station (Boston Properties) ±402 apartment units (including 45 affordable units) ±13,000 SF retail space 24 stories tall Delivery 2020</p>
<p>2 Merrill Gardens ±127 assisted living units ±7,800 SF commercial</p>	<p>4 The Ridge ±320,000 SF commercial</p>	

TEMESCAL

Telegraph Ave is the vibrant heart of Oakland's historic Temescal neighborhood. Known for its eclectic vibe, craft stores and great food, Temescal serves up a new surprise on every block—places to eat, shop, grab a coffee or raise a glass. You'll find craft breweries, handmade jewelry, art classes, and galleries, along these walkable, tree-lined streets. There's an unmistakable energy here, an entrepreneurial spirit that's both engaging and inspiring.

“

Like downtown Oakland, the Temescal District, on Telegraph Avenue, came alive because of its eclectic restaurant scene, such as the immensely popular Bakesale Betty's and a collection of diverse eateries such as Asmara Restaurant, Burma East, Cafe Eritrea D'Afrique and Homeroom Mac & Cheese. With that came businesses that reflect Oakland's diverse and artistic culture.

”

SFGate, June 2017



LOCKEHOUSE

LOCKEHOUSE

CHRIS HOMS

(650) 548-2687

chris@lockehouse.com

License #01901922

CHRIS SILVERMAN

(510) 282-6399

silverman@lockehouse.com

License #02055822

