

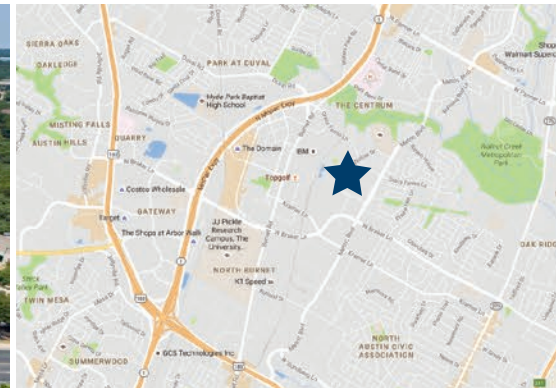

# STONEHOLLOW A

11700 Stonehollow Drive - Austin, TX 78758



## Available Space

Suite	RSF
125	18,385

## Building Features



10% Office



90% Office



24' Clear Height



Front Loading,  
1 Dock High Door



1 Oversized Dock Door



1 Double Wide  
Drive-In Ramp

**DAVIS BASS**

(512) 538-1040

bass@hpitx.com

**MORRIS GREEN**

(512) 538-0081

mgreen@hpitx.com

No warranty or representation, expressed or implied, is made as to the accuracy of the information contained herein, and same is submitted subject to errors, omissions, change of price, rental or other conditions, withdrawal without notice, and to any special listing conditions imposed by the principals.



# STONEHOLLOW A

11700 Stonehollow Drive - Austin, TX 78758

**SUITE 125**

AVAILABLE NOW

**18,385 SF**

AVAILABLE SF

**OFFICE/WAREHOUSE**

SPACE TYPE

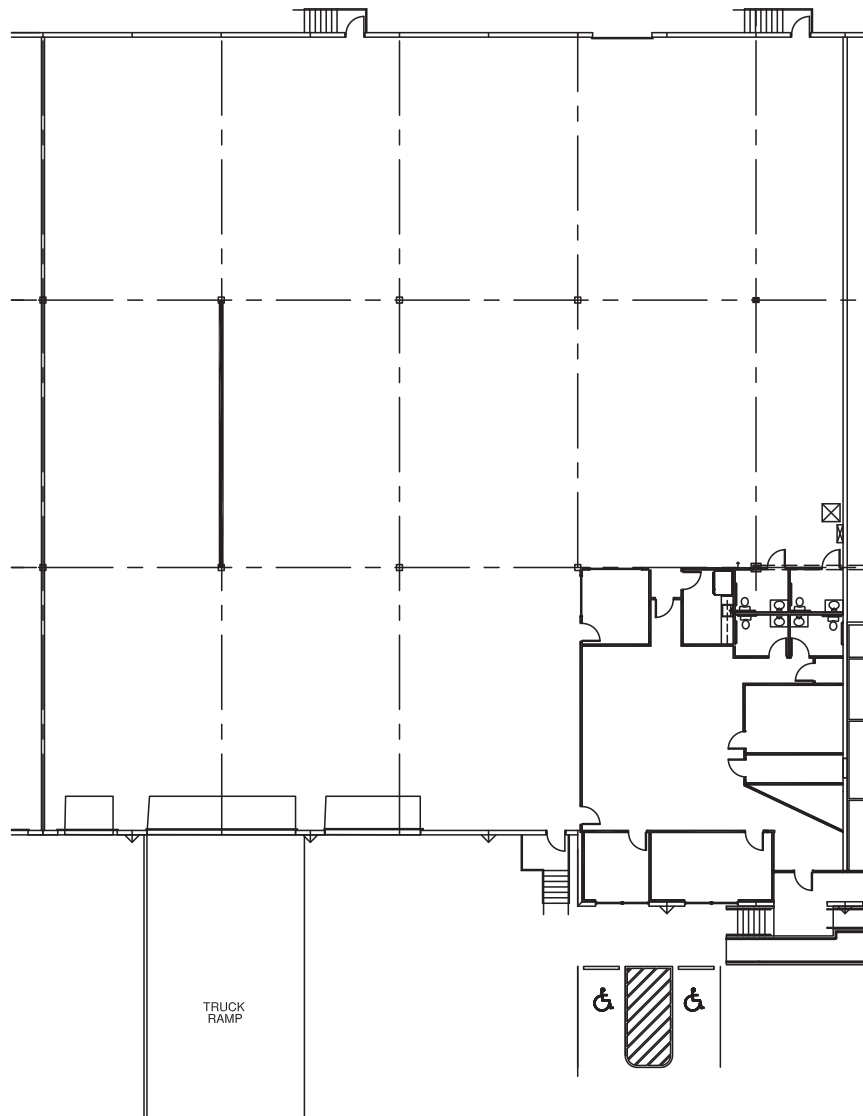

**DAVIS BASS**  
(512) 538-1040  
bass@hpitx.com

**MORRIS GREEN**  
(512) 538-0081  
mgreen@hpitx.com

No warranty or representation, expressed or implied, is made as to the accuracy of the information contained herein, and same is submitted subject to errors, omissions, change of price, rental or other conditions, withdrawal without notice, and to any special listing conditions imposed by the principals.