

FOR SALE

SPRING MILL VALLEY SUBDIVISION PHASE II & III

House Springs, MO 63051

REDUCED SALE PRICE



PROPERTY INFO

- + Excellent opportunity to finish building homes in the attractive Spring Mill Valley Subdivision
- + Lots have spectacular wooded views and allow for walkout basements
- + Located on Gravois Rd. across from Northwest Valley Middle School and House Springs Elementary School
- + Convenient access to Hwy. 30
- + Available Geotechnical Reports, Site Improvement Plans, etc.
- + Existing homes in subdivision valued at \$175,000 to \$250,000



| Acres | Sale Price |
|------------------------------|------------|
| Phase II (9.34 acres) | \$595,000 |
| Phase III (7.88 acres) | \$195,000 |
| Phase II & III (17.22 acres) | \$790,000 |



CONTACT INFO

MARK MCNULTY

Vice President
314 655 6022
mark.mcnulty@cbre.com

CBRE, INC.

190 Carondelet Plaza
Suite 1400
St. Louis, MO 63105

www.cbre.us/stlouis

CBRE

FOR SALE PHASE II & III

SPRING MILL VALLEY
HOUSE SPRINGS, MO 63051



AERIAL MAP



- 7.88 ACRES
- WATER, SEWER, ELECTRIC AT ENTRANCE
- SALE PRICE: \$195,000

- 26 LOTS ON 9.34 ACRES
- WATER, SEWER, AND ELECTRIC AT ENTRANCE
- CLEARED AND ROUGH GRADED
- UTILITY TRENCHES PRE-BLASTED
- PRELIMINARY PLAT APPROVED
- SALE PRICE: \$595,000



PROPERTY DEMOGRAPHICS

| Demographics | 1 MILE | 3 MILES | 5 MILES |
|-------------------------------|-----------|-----------|-----------|
| 2017 POPULATION | 2,867 | 13,322 | 30,860 |
| 2017 AVERAGE HOUSEHOLD INCOME | \$69,787 | \$72,068 | \$72,772 |
| 2017 AVERAGE HOME VALUE | \$220,803 | \$199,037 | \$195,613 |

FOR SALE PHASE II & III

SPRING MILL VALLEY
HOUSE SPRINGS, MO
63051



SITE PLAN

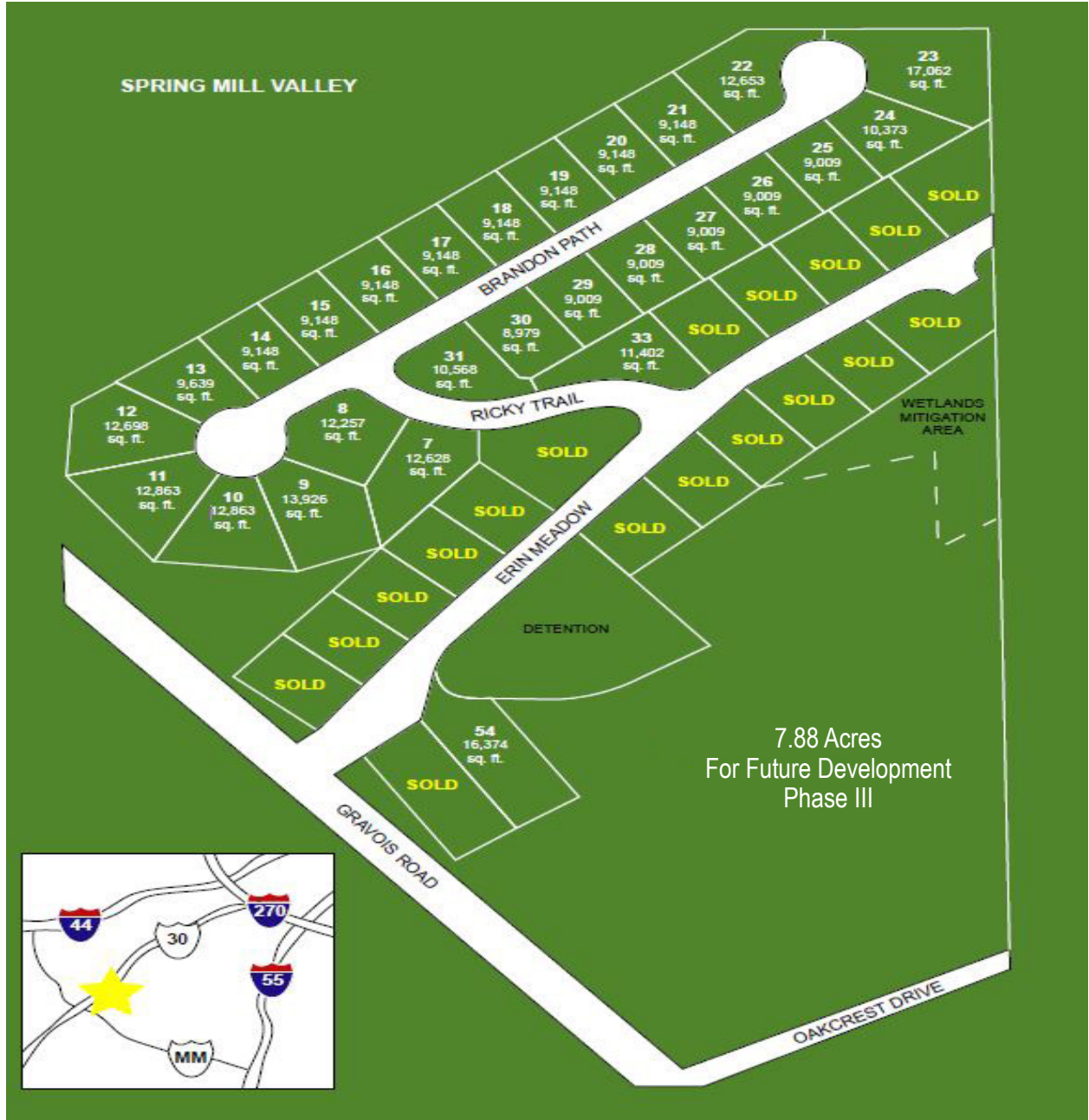

© 2019 CBRE, Inc. This information has been obtained from sources believed reliable. We have not verified it and make no guarantee, warranty or representation about it. Any projections, opinions, assumptions or estimates used are for example only and do not represent the current or future performance of the property. You and your advisors should conduct a careful, independent investigation of the property to determine to your satisfaction the suitability of the property for your needs. Photos herein are the property of their respective owners and use of these images without the express written consent of the owner is prohibited. CBRE and the CBRE logo are service marks of CBRE, Inc. and/or its affiliated or related companies in the United States and other countries. All other marks displayed on this document are the property of their respective owners.

