

INDUSTRIAL
FOR SALE

621 SOUTH JASON STREET

:: DENVER, COLORADO 80223

DOCK AND DRIVE-IN
LOADING

DIVISIBLE TO 3
SEPARATE UNITS

LARGE SHOWROOM



LOCATION MAP

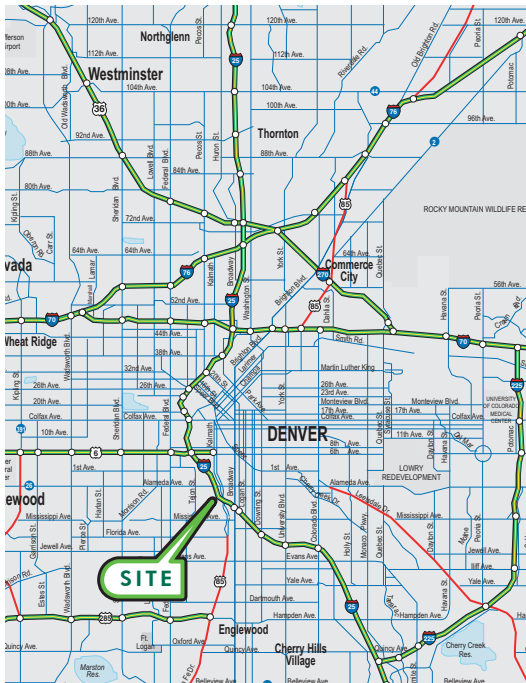

AVAILABLE:	±18,695 SF
LOT SIZE:	.88 Acres (38,333 SF)
OFFICE AREA:	±2,500 SF
SHOWROOM:	±2,100 SF
LOADING:	3 Drive-in doors 3 Docks
ELECTRICAL:	2 North Units - 125A, 110/208V, single-phase South Unit - 200A, 110/208V, single-phase
CLEARANCE:	12'
YEAR BUILT:	1959
ZONING:	I-A (Denver County)
CITY/COUNTY:	Denver
RE TAXES:	\$25,750.95 (2012)
REDUCED PRICE:	\$1,250,000 (\$66.86/SF) \$1,150,000 (\$61.51/SF)

FOR MORE
INFORMATION
PLEASE
CONTACT

Daniel Close
Associate
720.528.6342
daniel.close@cbre.com

Paul Kluck, SIOR
First Vice President
720.528.6405
paul.kluck@cbre.com

CBRE

INDUSTRIAL
FOR
SALE



621
SOUTH JASON STREET
:: DENVER, COLORADO 80223

**BUILDING
FEATURES**

- :: Close proximity to new Alameda interchange
- :: Jason Street visibility
- :: Swamp coolers
- :: Fenced truck court

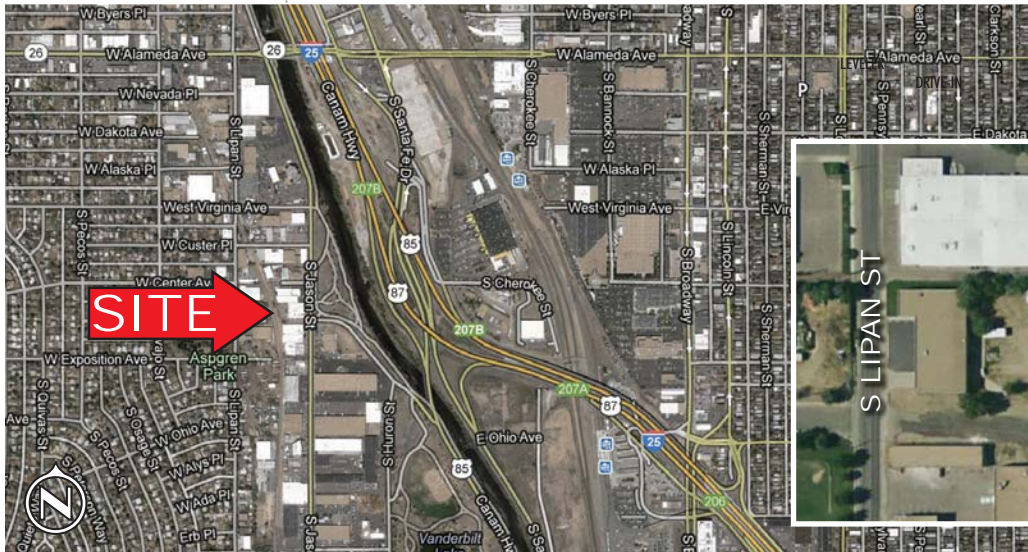
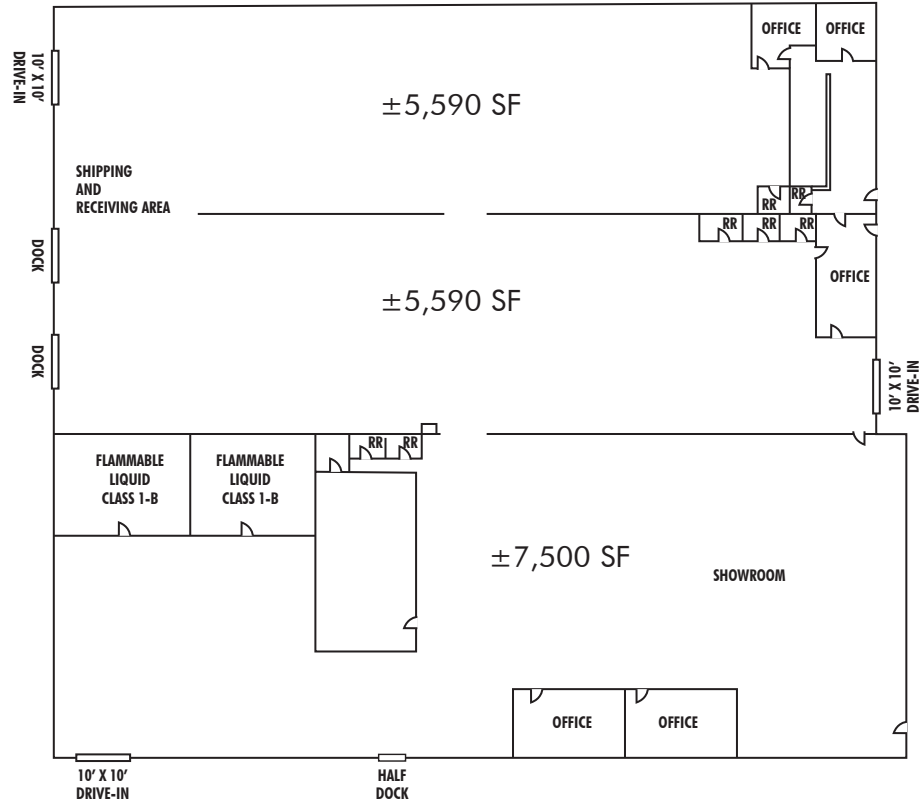

**FOR MORE
INFORMATION
PLEASE
CONTACT**

Daniel Close

Associate

720.528.6342

daniel.close@cbre.com

Paul Kluck, SIOR

First Vice President

720.528.6405

paul.kluck@cbre.com

CBRE, Inc. | 8390 E. Crescent Parkway | Suite 300 | Greenwood Village, CO 80111 | www.cbre.com/denver

© 2013 CBRE, Inc. This information has been obtained from sources believed reliable. We have not verified it and make no guarantee, warranty or representation about it. Any projections, opinions, assumptions or estimates used are for example only and do not represent the current or future performance of the property. You and your advisors should conduct a careful, independent investigation of the property to determine to your satisfaction the suitability of the property for your needs. February 19, 2013 11:05 AM

CBRE