

15450 S. KEELER STREET
OLATHE, KS 66062

NEW INDUSTRIAL BUILDING FOR LEASE | 7,500± SF

PROPERTY FEATURES

- 1 Dock-high door (10' x 10')
- 2 Drive-in doors (10' x 14')
- 400 amp | 120/208v | 3-phase electrical service
- Clear span warehouse
- Excellent highway access to I-35
- Landlord willing to provide standard office finish for term tenant

ADDITIONAL INFO

PREMISES	7,500± SF
LEASE RATE	\$8.50-\$10.50 PSF Gross Industrial
OFFICE	Build-to-Suit



For more information, please contact:

KURT JENSEN
Industrial Brokerage
816.936.8508 direct
kjensen@kessingerhunter.com

KESSINGER/HUNTER & COMPANY, LC
2600 Grand Boulevard, Suite 700
Kansas City, MO 64108
816.842.2690
www.kessingerhunter.com

15450 S. KEELER STREET | OLATHE, KS 66062

Industrial for Lease

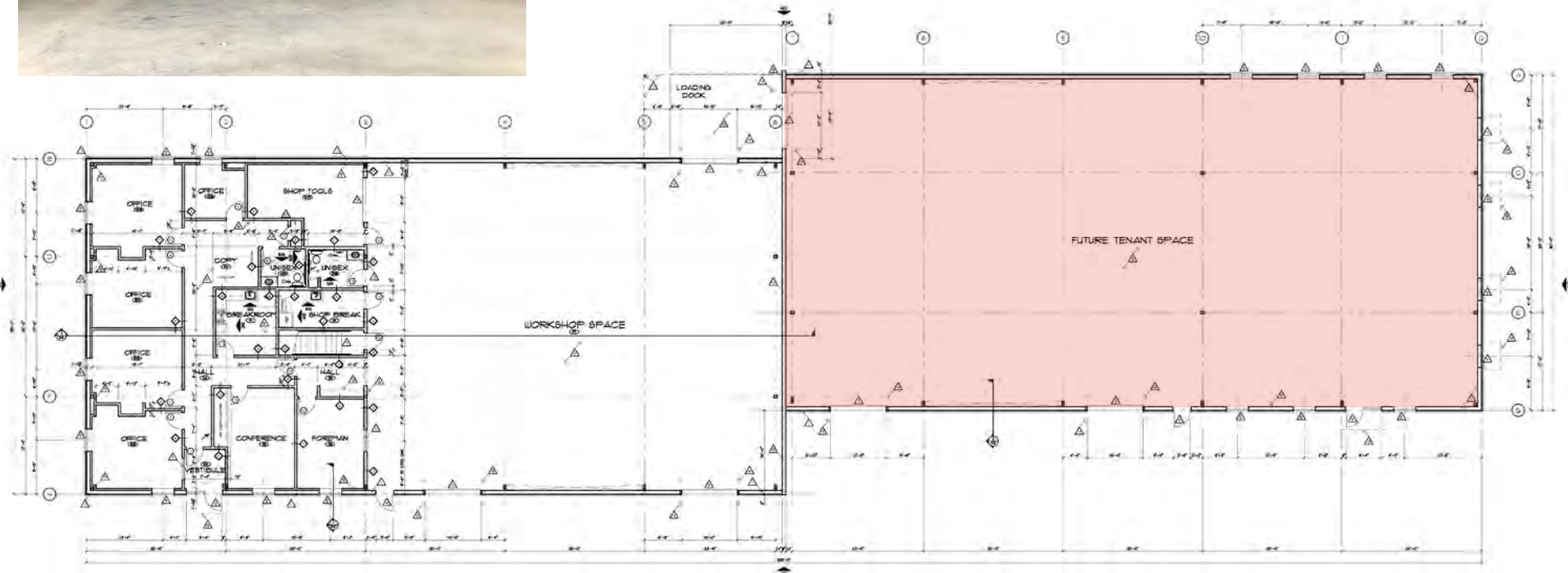

For more information, please contact:

KURT JENSEN
Industrial Brokerage
816.936.8508 direct
kjensen@kessingerhunter.com

KESSINGER/HUNTER & COMPANY, LC
2600 Grand Boulevard, Suite 700
Kansas City, MO 64108
816.842.2690
www.kessingerhunter.com