

# High Traffic Chelsea Corner Across From Whole Foods Market

245 SEVENTH AVENUE  
NEW YORK, NY



**CHELSEA  
NEW YORK, NY**

## Ground Floor | Proposed Divisions

# 245 Seventh Avenue

### Location

Northeast corner of West 24th Street

### Approximate Size

Ground Floor 5,713 SF\*

\*Flexible divisions

Cellar 3,773 SF\*

\*Can be leased separately with private entry

### Term

Long term

### Possession

Immediate

### Neighbors

buybuy BABY, Bank of America, FedEx, TD Bank, Starbucks, Beach Bum Tanning, Westside Market, Cohens Optical, Chipotle Mexican Grill, Bare Burger, Just Salad, Taco Bell, Fashion Institute of Technology and the School of Visual Arts

### Comments

Across from Whole Foods Market earning \$1 million weekly

Close proximity to the **1** subway train at 23rd Street, the **PATH**, **F** and **M** subway trains at 23rd Street/Sixth Avenue and the **C** and **E** subway trains at 23rd Street/Eighth Avenue

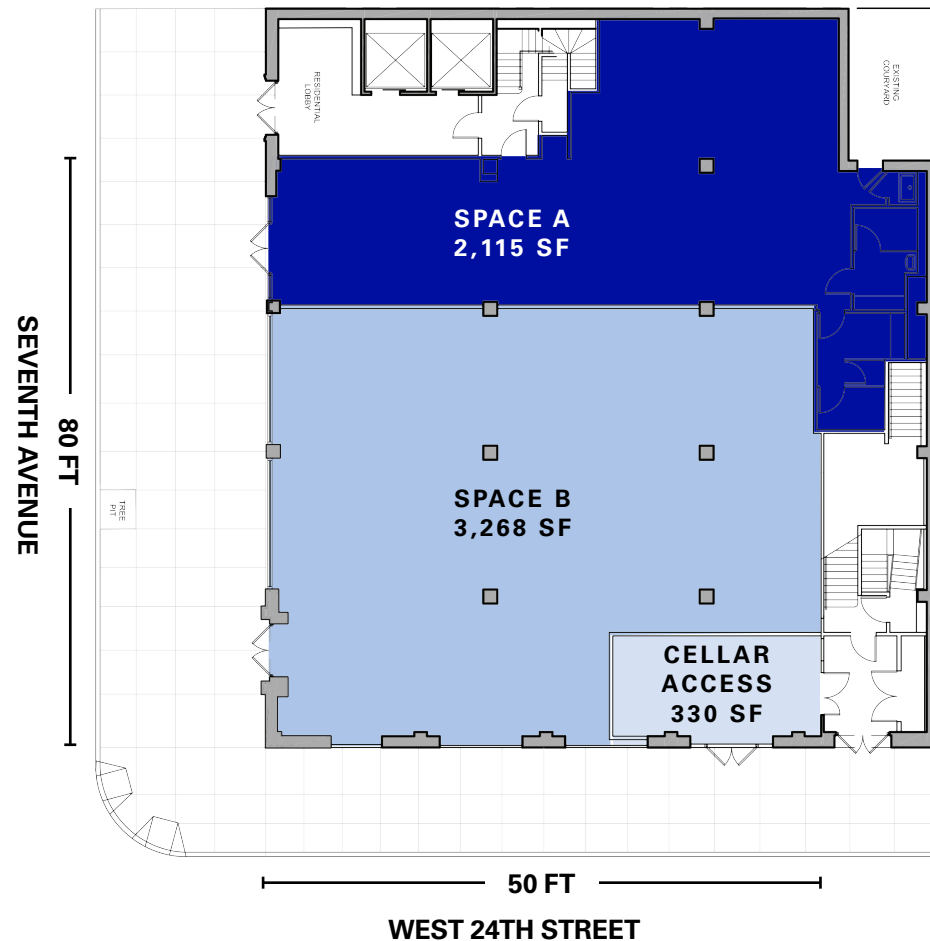



AREA NEIGHBORS



## AREA MAP

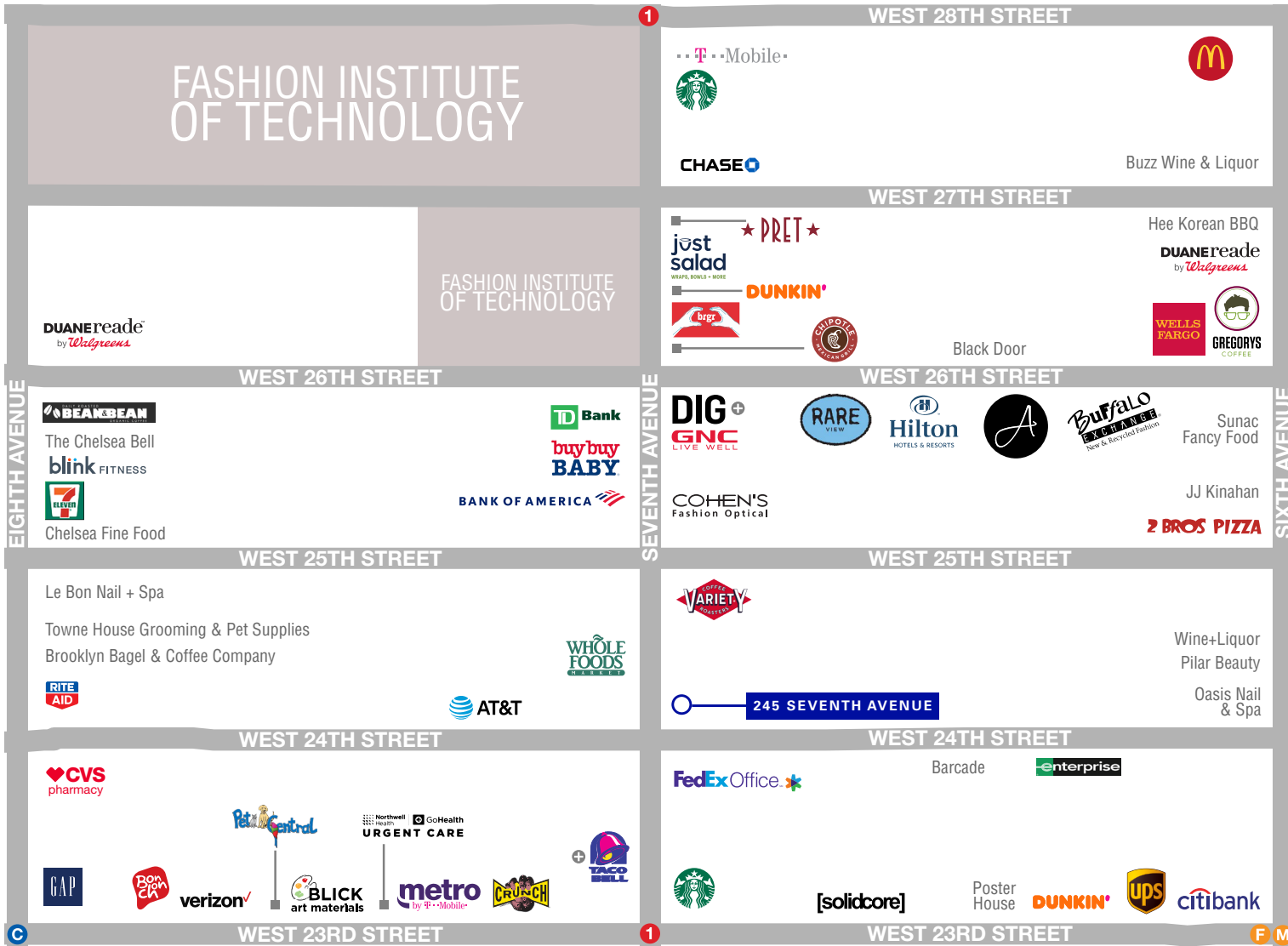

## CONTACT

**Jeffrey D Roseman**  
t 212-372-2430  
jroseman@ngkf.com

**Craig Slosberg**  
t 212-372-2398  
craig.slosberg@ngkf.com

**Jeremy Tucker**  
t 516-712-5383  
jeremy.tucker@ngkf.com

[nmrk.com](http://nmrk.com)

+ COMING SOON