



BUILDING AVAILABLE FOR LEASE

12500 LOMBARD LANE, ALSIP, IL



BUILDING SPECIFICATIONS

AVAILABLE SIZE:	± 45,333 SF
TOTAL BUILDING SIZE:	± 86,200 SF
OFFICE:	± 5,500
LAND:	5.12 Acres
CEILING HEIGHT:	20' Clear
LOADING:	5 interior docks 4 drive-in doors
PARKING:	77 car parking spaces
COLUMN SPACING:	37' X 32'
ZONING:	Industrial- I
CONSTRUCTION:	Masonry
SPRINKLER:	Yes
YEAR BUILT:	1979
LEASE RATE:	\$8.10 psf gross



FEATURES

- **Available September 2019**
- 3 full size grade-level drive-in doors
- Floor drains
- Heavy parking

**FOR ADDITIONAL
INFORMATION,
PLEASE CONTACT:**

GEORGE J. CIBULA, SIOR

Managing Broker

gcibula@darwinrealty.com

TODD HENDRICKS

Associate

thendricks@darwinrealty.com

970 N. Oaklawn Avenue, Suite 100 | Elmhurst, IL 60126 | Tel: 630-782-9520 | Fax: 630-782-9531 | www.darwinrealty.com

Submitted subject to error, change in status, or withdrawal without notice. Officers of this firm have an ownership interest in this property.



BUILDING AVAILABLE FOR LEASE

12500 LOMBARD LANE, ALSIP, IL

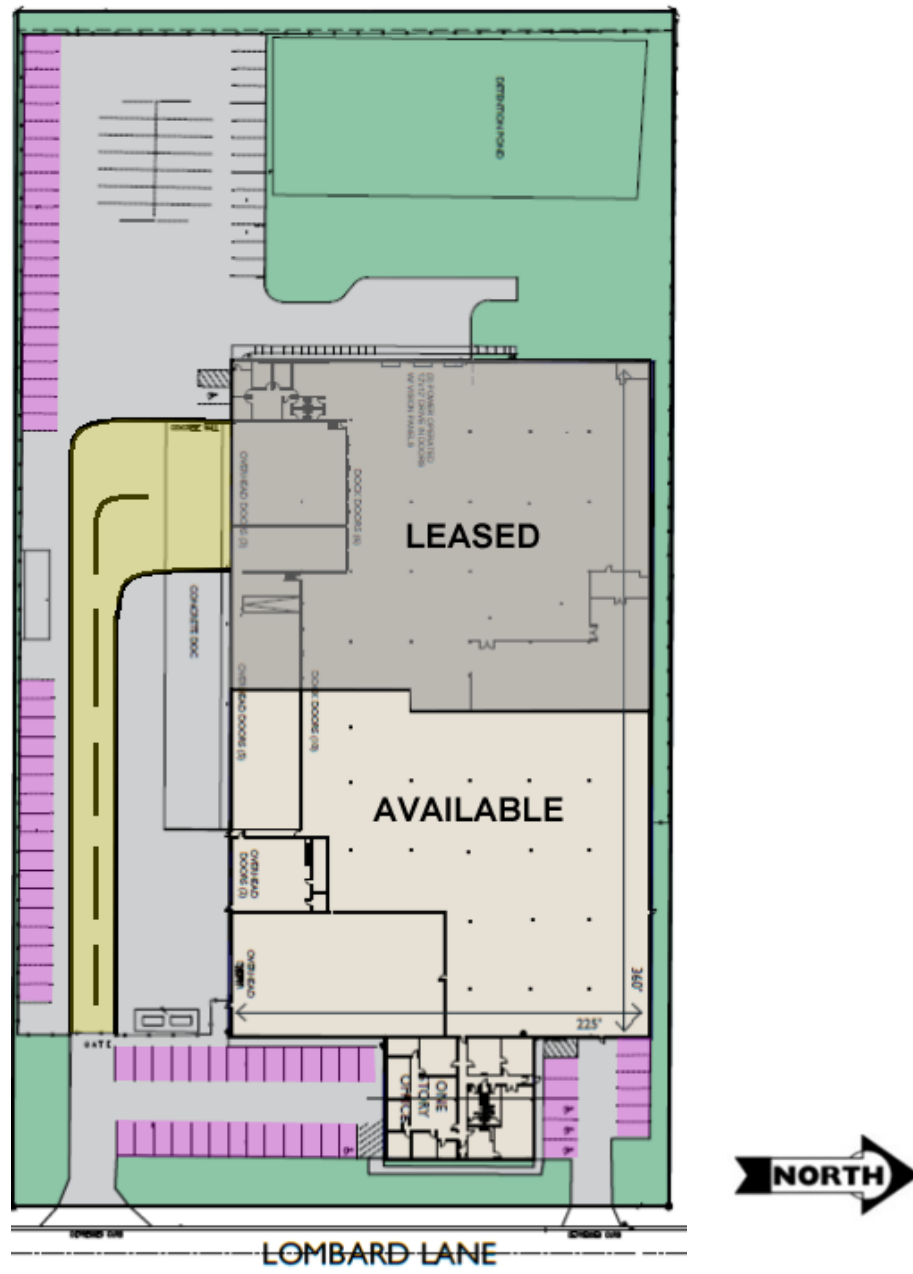

**FOR ADDITIONAL
INFORMATION,
PLEASE CONTACT:**

GEORGE J. CIBULA, SIOR

Managing Broker

gcibula@darwinrealty.com

TODD HENDRICKS

Associate

thendricks@darwinrealty.com

970 N. Oaklawn Avenue, Suite 100 | Elmhurst, IL 60126 | Tel: 630-782-9520 | Fax: 630-782-9531 | www.darwinrealty.com

Submitted subject to error, change in status, or withdrawal without notice. Officers of this firm have an ownership interest in this property.