

80 John Street

FINANCIAL DISTRICT
NEW YORK, NY



80 JOHN STREET

Property Details

Location

Corner of John, Platt and Gold Streets

Approximate Size

Ground Floor

Space A 2,500 SF

Space B 1,650 SF

Ceiling Height

Ground Floor 15 FT

Frontage

Space A 94 FT on Gold Street

Space B 40 FT on Gold Street

Term

10-20 years

Possession

Immediate

Site Status

Space A currently vacant

Space B currently Dunkin'

Neighbors

Jubilee Market, Stout NYC, Voyager Espresso, Starbucks, Blue Spoon Coffee and HSBC Bank

Comments

Sunlit ADA compliant multi-use space featuring 25 floor-to-ceiling windows, three means of egress, awning and blade signage

Space is divisible into a contiguous Space A and Space B which may be either leased together or separate

At the base of 192,512-SF luxury residential condo building, The South Star

Ground Floor

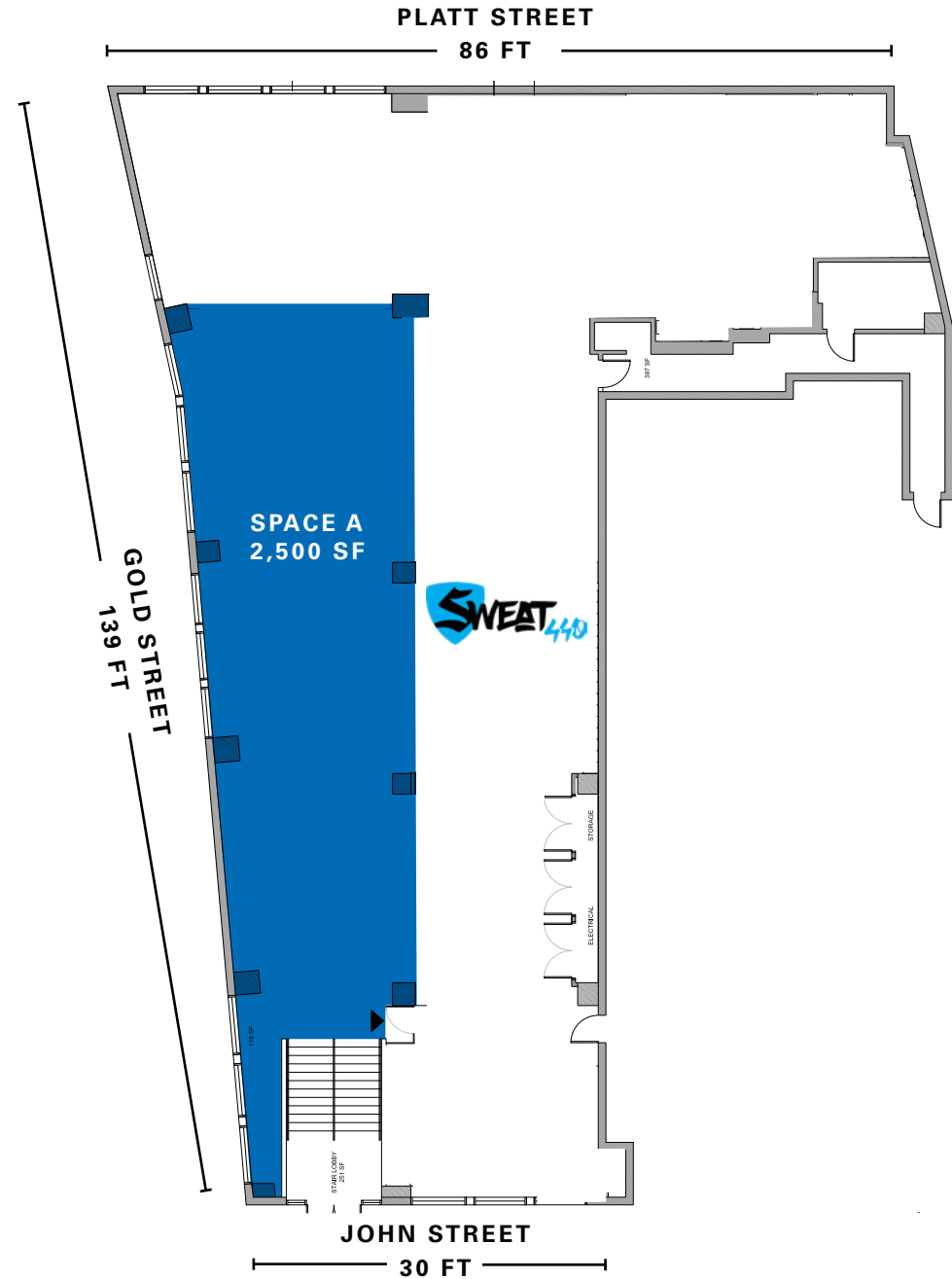

Retail Map



CONTACT

Aric Trakhtenberg
 t 212-916-3386
 aric.trakhtenberg@nmrk.com

Ravi Idnani
 t 212-916-2938
 ravi.idnani@nmrk.com
nmrk.com

©2022 NEWMARK The information contained herein has been obtained from sources deemed reliable but has not been verified and no guarantee, warranty or representation, either express or implied, is made with respect to such information. Terms of sale or lease and availability are subject to change or withdrawal without notice.