

For Lease

2,859-5,905 SF
Office Space



The Legends, Building 4 2320 Dean Way Southlake, Texas 76092

Property Features

- One-Story Office/Flex Space
- Brand New Construction in Shell Condition
- 5:1000 Parking
- Adjacent to Dragon Stadium
- Located Within 1 Mile of Southlake Town Square & 4 Miles From DFW Int'l Airport
- Shell Complete

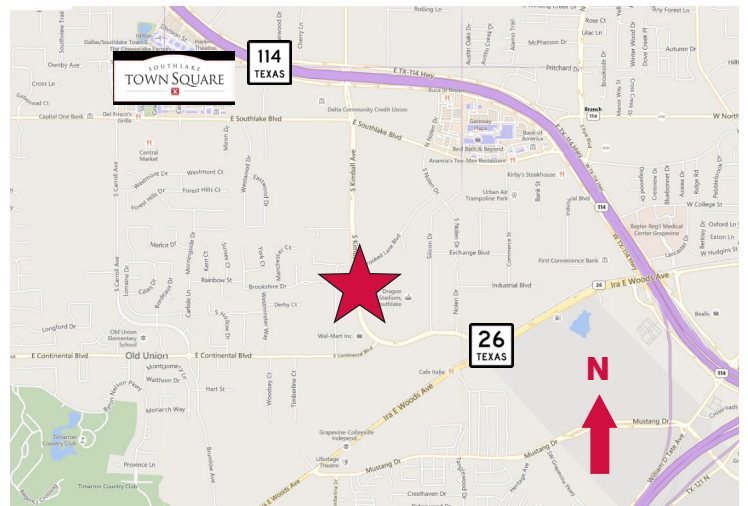

Tyson Erwin, SIOR

214 256 7127

terwin@robertlynn.com

Rick Medinis, SIOR

214 256 7116

rmedinis@robertlynn.com



THE INFORMATION CONTAINED HEREIN HAS BEEN GIVEN TO US BY THE OWNER OF THE PROPERTY OR OTHER SOURCES WE DEEM RELIABLE. WE HAVE NO REASON TO DOUBT ITS ACCURACY, BUT WE DO NOT GUARANTEE IT. ALL INFORMATION SHOULD BE VERIFIED PRIOR TO PURCHASE OR LEASE.

4851 LBJ Freeway 10th Floor

Dallas TX 75244

214 256 7100

nairl.com

For Lease
2,859-5,905 SF
Office Space

The Legends, Building 4
2320 Dean Way
Southlake, Texas 76092

