

A decorative border made of gold-colored geometric lines, consisting of overlapping squares and rectangles, frames the entire page. The lines are thick and have a slightly textured, metallic appearance.

# 875

NORTH RUSH

GOLD COAST | CHICAGO, IL

DYNAMIC, HIGHLY VISIBLE  
CORNER OPPORTUNITY

**CBRE**

Newcastle  
LIMITED

# 875

NORTH RUSH

JOIN OUR NEW TENANTS  
**BELLA BIANCA**

*Bridal Couture*

AND



**PETER  
MILLAR**

**NEWLY RENOVATED SECOND  
FLOOR LOBBY**

**HIGH VOLUME, 7 DAY PER-WEEK  
TRAFFIC**

**AFFLUENT, SOPHISTICATED  
CUSTOMERS SEEKING  
HOSPITALITY, LUXURY,  
EXCLUSIVITY, AND  
CONVENIENCE**

**20 HOTELS, 6,338 HOTEL  
ROOMS WITHIN .25 MILES**

**NEIGHBORS INCLUDE TESLA,  
INTERMIX, SAINT LAURENT,  
TRULUCKS, AND RAG & BONE**



# 875

NORTH RUSH

**Newly renovated  
second floor lobby**

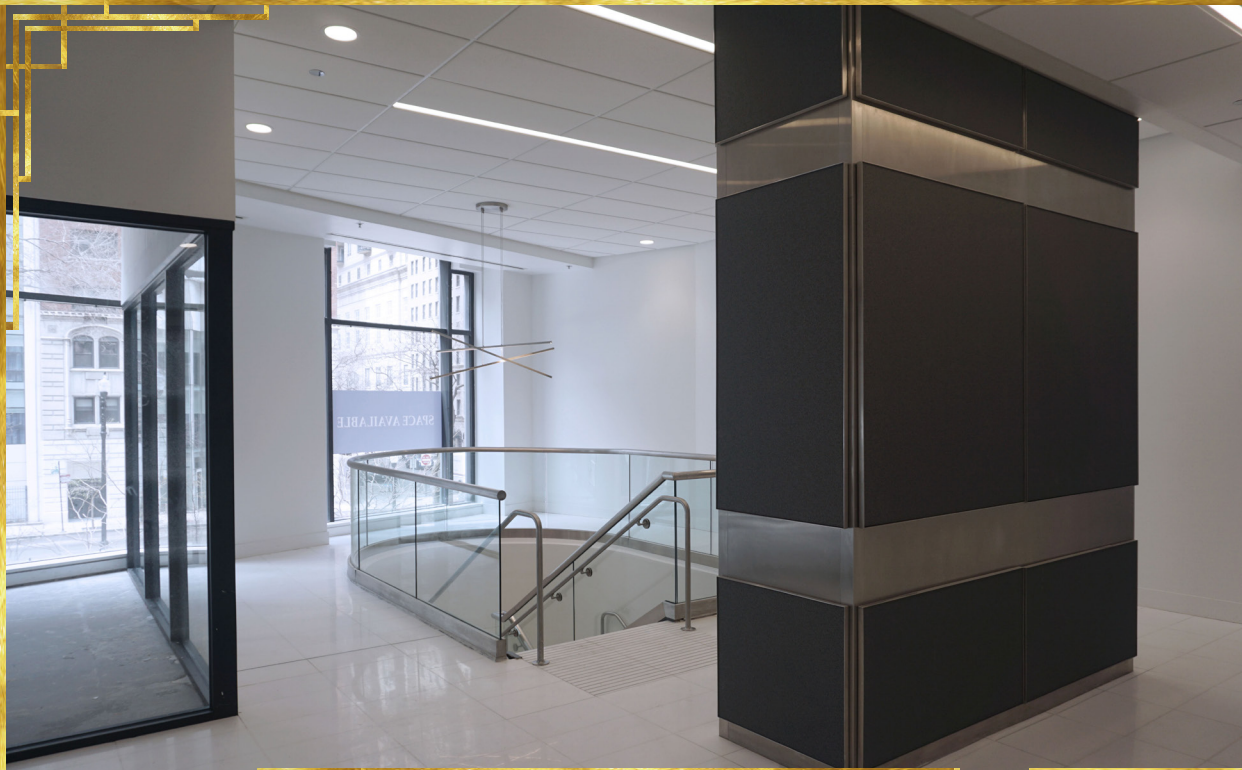

# Floor Plan 1 (One Tenant)

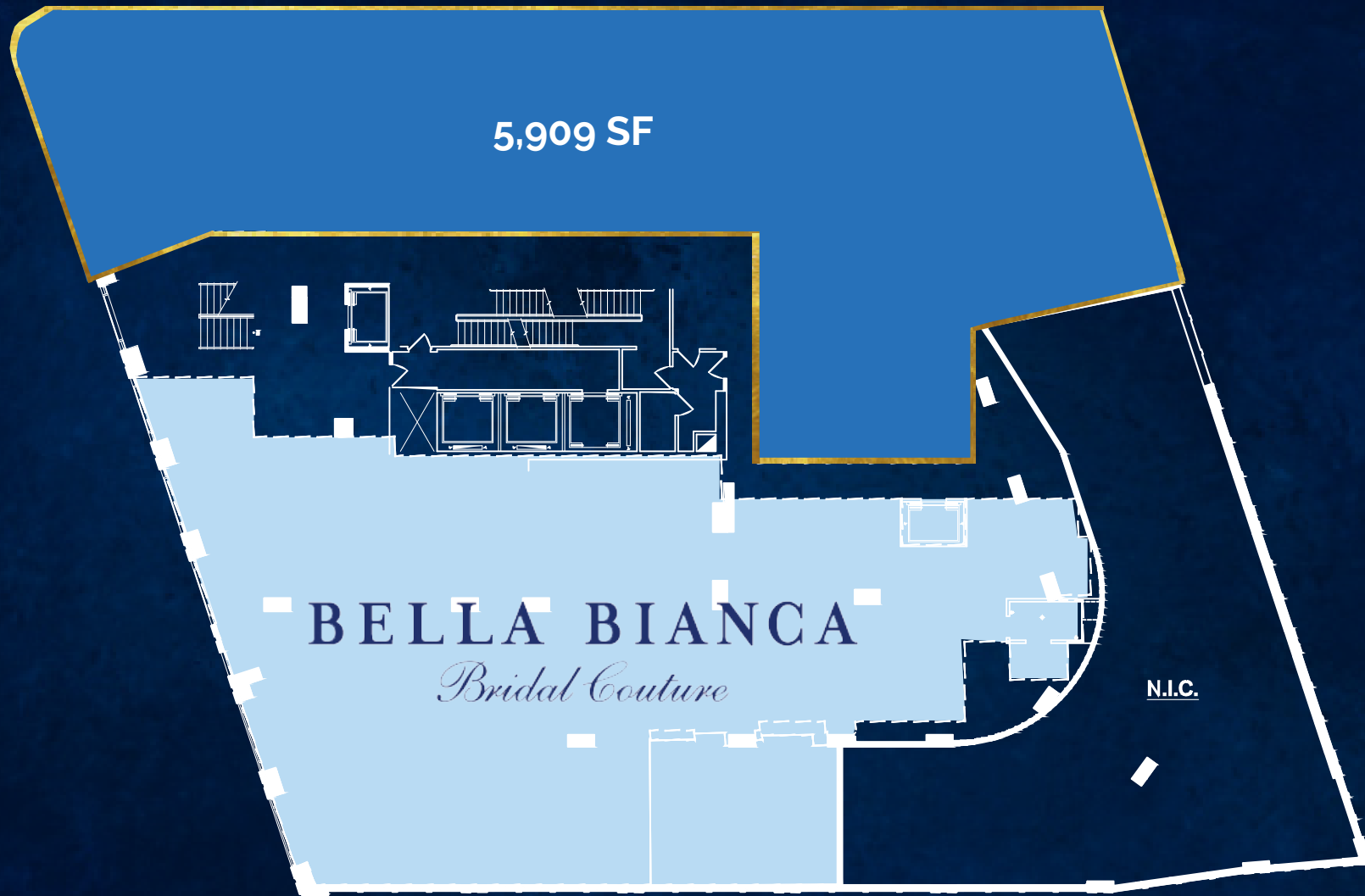

875  
NORTH RUSH

# Floor Plan 2 (Two Tenants)

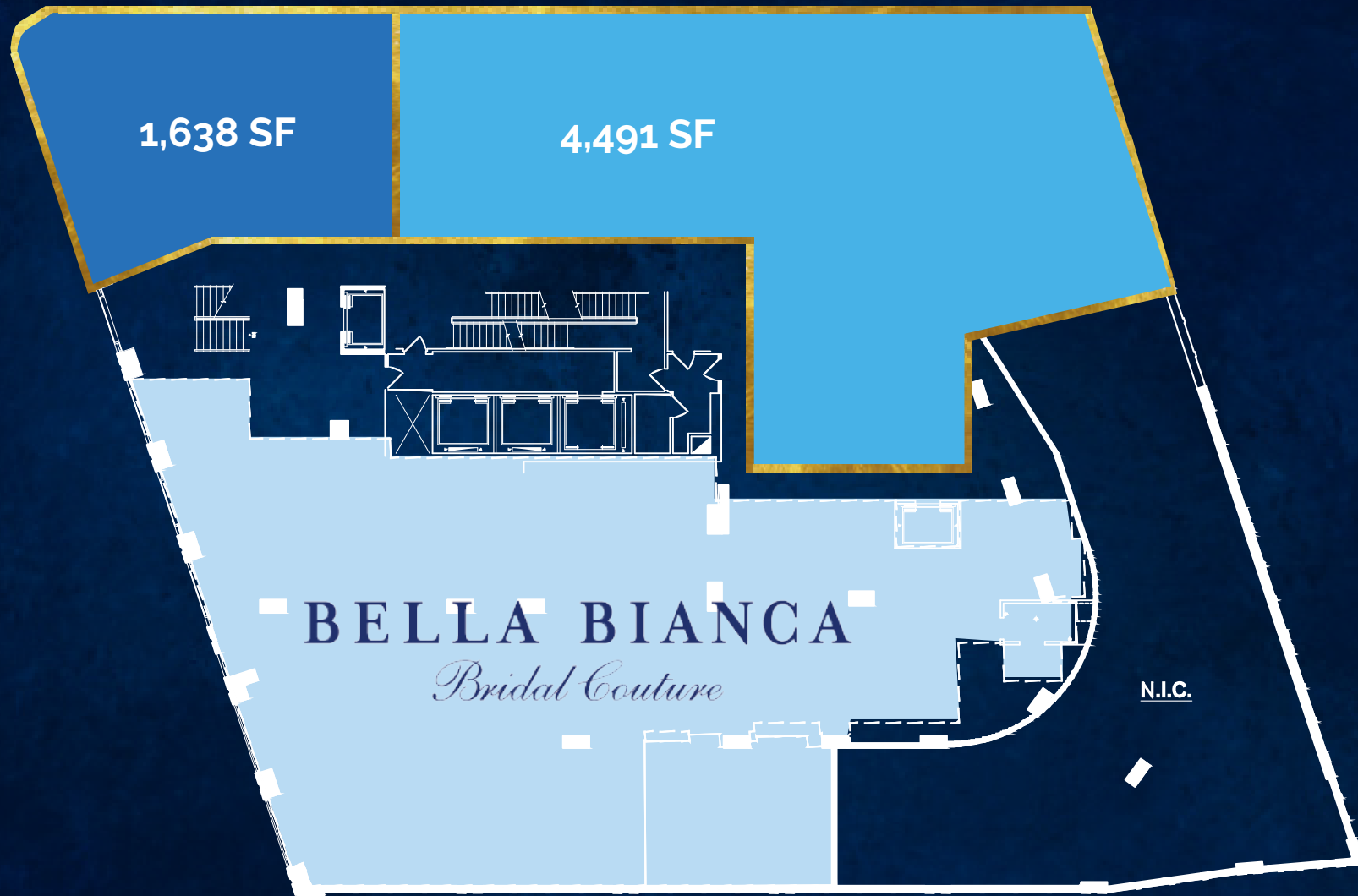

**875**  
NORTH RUSH

# Floor Plan 3 (Two Tenants)

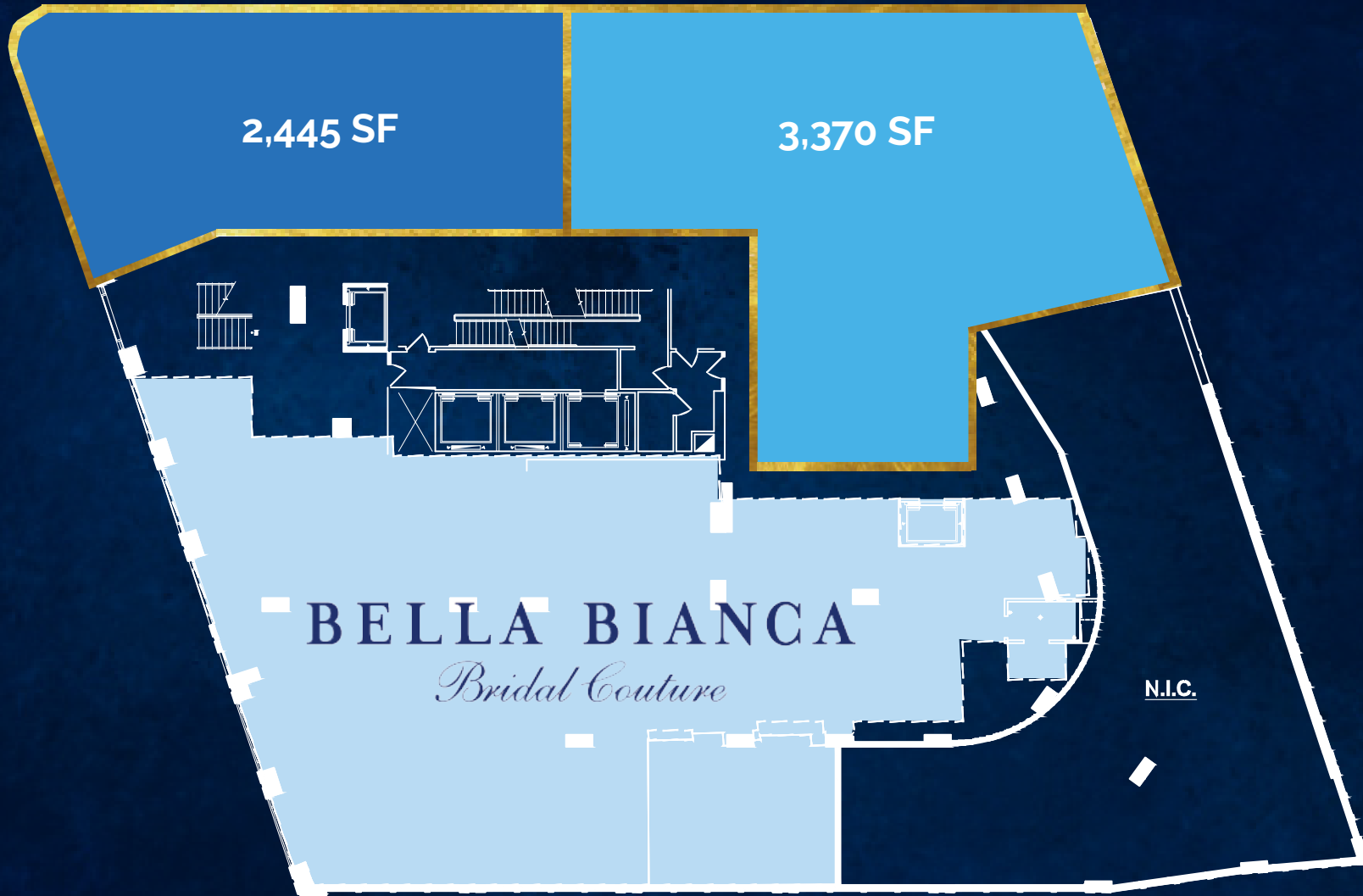

875  
NORTH RUSH

# Floor Plan 4 (Three Tenants)

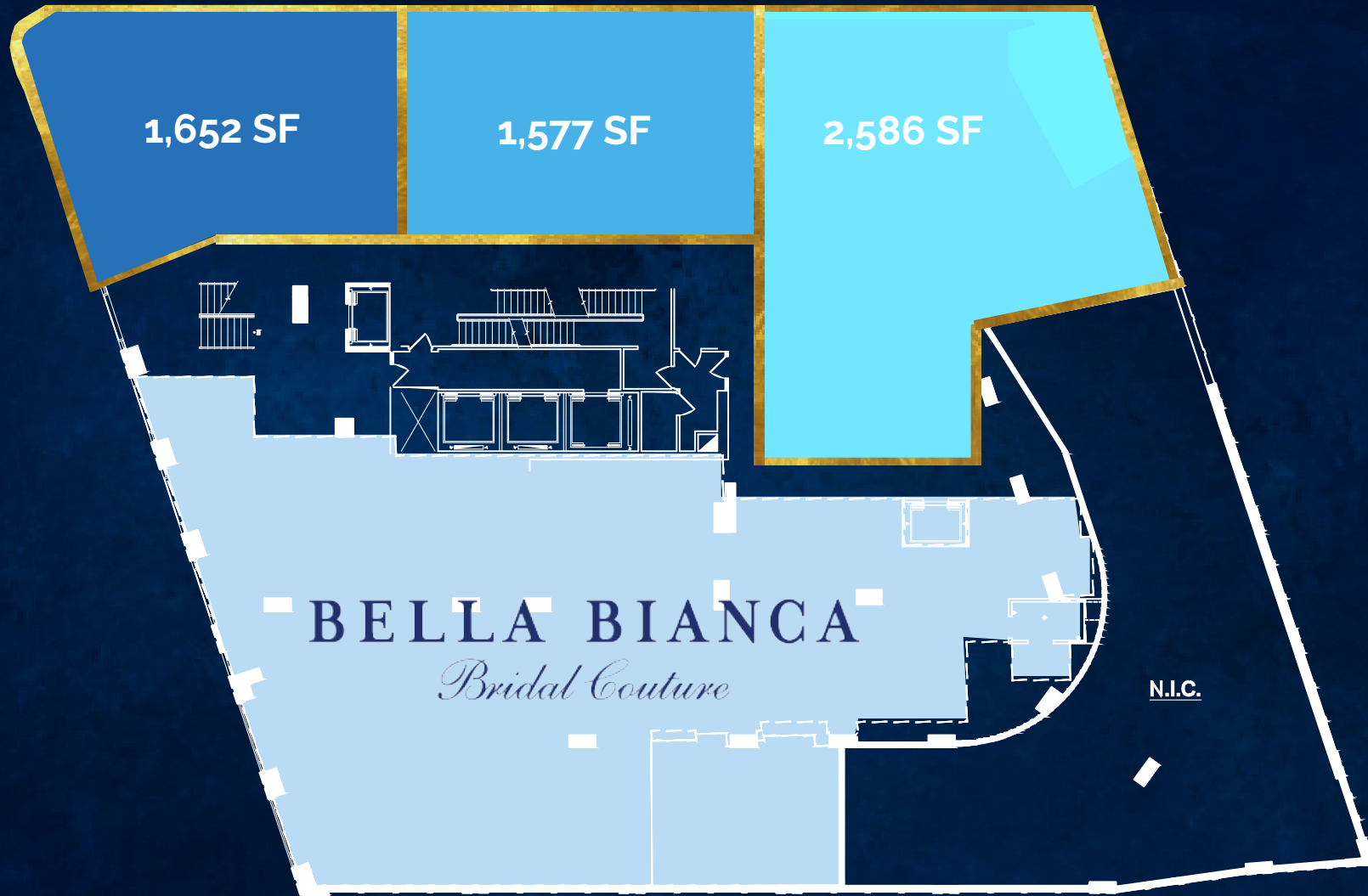

875  
NORTH RUSH

# Retail Landscape

within 0.5 miles



AREA  
POPULATION

38,549



AVG. HOUSING  
VALUE

\$833,957



AVG. HH  
INCOME

\$138,858



DAYTIME  
POPULATION

83,587

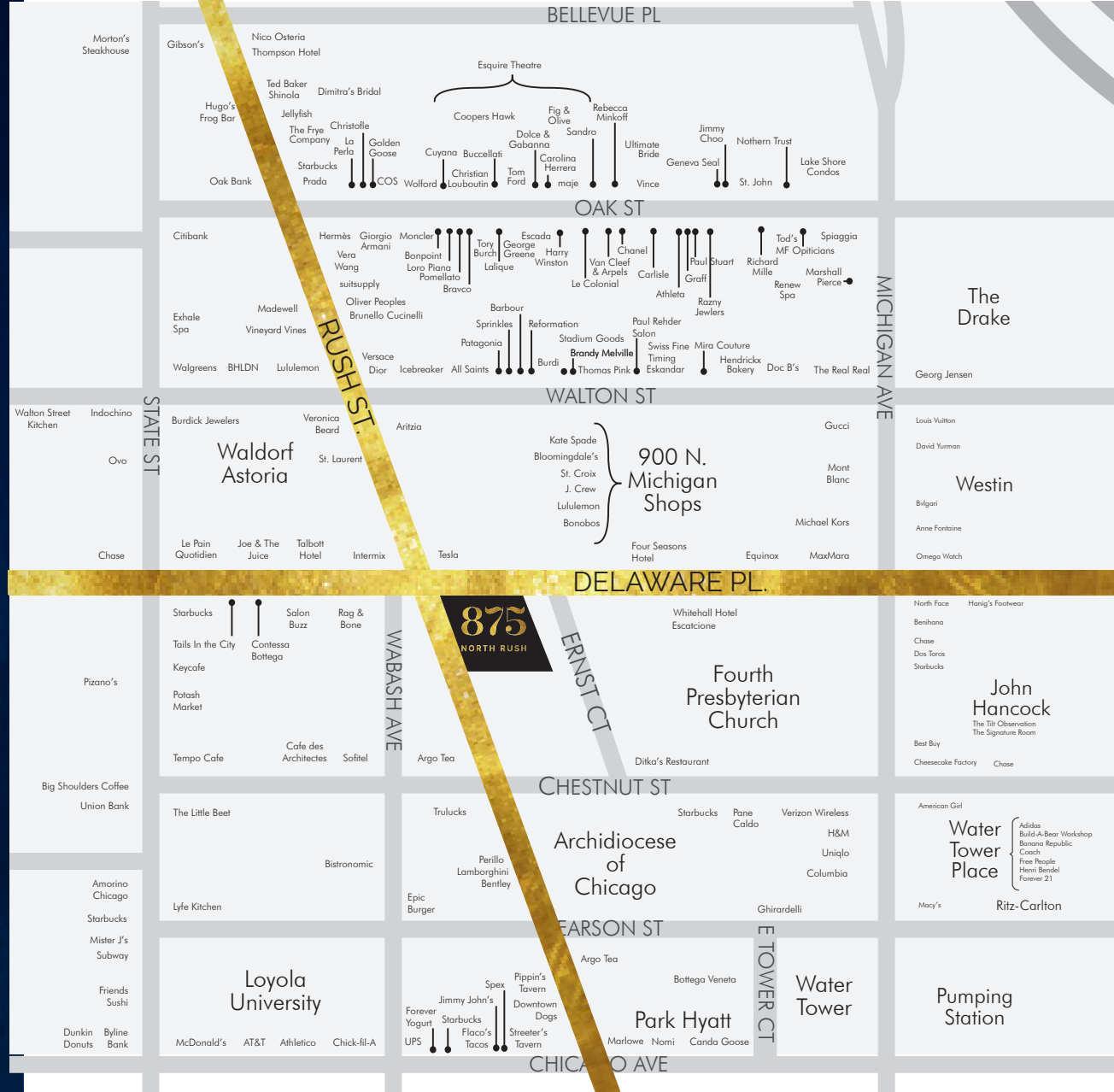

PETER MILLAR

ALLSAINTS

*Arizia*

BARNEYS  
NEW YORK

BELLA BIANCA

*Bridal Couture*

bloomingdale's

Dior

MaxMara

PRADA

rag & bone

TESLA

VERSACE



# 875

## NORTH RUSH

**CBRE** + Newcastle  
LIMITED

**FOR MORE INFORMATION, PLEASE CONTACT:**

**Sharon Kahan**

**+1 312 297 7679**

**sharon.kahan@cbre.com**

**Amy Sider**

**+1 312 935 1909**

**amy.sider@cbre.com**

© 2019 CBRE, Inc. This information has been obtained from sources believed reliable. We have not verified it and make no guarantee, warranty or representation about it. Any projections, opinions, assumptions or estimates used are for example only and do not represent the current or future performance of the property. You and your advisors should conduct a careful, independent investigation of the property to determine to your satisfaction the suitability of the property for your needs. Photos herein are the property of their respective owners and use of these images without the express written consent of the owner is prohibited. CBRE and the CBRE logo are service marks of CBRE, Inc. and/or its affiliated or related companies in the United States and other countries. All other marks displayed on this document are the property of their respective owners.