

Independence Commercial Portfolio For Sale



Excellent Location

- Easy access to US 40 Hwy, I-70, & I-435
- Residential structure used as office space with separate apartment/guest house
- Separate building leased as event space (for income)
- 4 acres of Land

For more information:

Michael R. Block, CPM
816.932.5549
mblock@blockllc.com

Keiten J. Nuspl
816.932.5531
knuspl@blockllc.com

Andrew Fain
816.412.8449
afain@blockllc.com

The information contained in this marketing flyer is presented as general information only. Block Real Estate Services, LLC makes no representation as to its accuracy. This information is not intended as legal, financial or real estate advice and must not be relied upon as such. You should make your own inquiries, obtain independent inspections, and seek professional advice tailored to your specific circumstances before making any legal, financial or real estate decisions.

9516 E US 40 Hwy & 9403 E 35th St. S

Parcel ID:	32-210-01-19-00-0-00-000 and 32-210-01-16-00-0-00-000
Building Size:	2,054 SF
Land:	95,518 SF
Parking:	2 car garage and parking in driveway
Year Built:	1940 with 2015 remodeled/addition and new guest house/apartment
Zoning:	Commercial
Real Estate Taxes:	\$2,394 (2018)
Photos Link:	https://photos.app.goo.gl/EyKqbxN9ihbhoBzVA

For more information:

Michael R. Block, CPM
816.932.5549
mblock@blockllc.com

Keiten J. Nuspl
816.932.5531
knuspl@blockllc.com

Andrew Fain
816.412.8449
afain@blockllc.com

9604 E US 40 Hwy

Parcel ID:	32-210-01-20-00-0-00-000
Office Size:	1,200 SF
Land:	76,824 ± SF; 1.76 acres
Parking:	10
Year Built:	2015
Zoning:	Commercial
Real Estate Taxes:	\$8,365 (2018)
Lease Rate:	\$2,250 monthly

For more information:

Michael R. Block, CPM
816.932.5549
mblock@blockllc.com

Keiten J. Nuspl
816.932.5531
knuspl@blockllc.com

Andrew Fain
816.412.8449
afain@blockllc.com



9604 E US 40 Hwy

Property Report for 32-210-01-20-00-0-00-000

PROPERTY PHOTO



STREET MAP



AERIAL PHOTO



Parcel ID: 32-210-01-20-00-0-00-000
Parcel Address: 9604 E US 40 HWY
 INDEPENDENCE
 MO 64052

Complex Name: N/A

Mortgage Holder Information: N/A

Property Characteristics:
 Year Built: N/A
 Approx. Bldg. Area: N/A sq. ft.
 Neighborhood Tax Code: 9801
 Approx. Area (Sq Ft): 76,824.54 sq. ft.
 Approx. Area (Acres): 1.76 acres

Property Class (PCA Code): N/A

Land Use Type: 2235 - Miscellaneous Service

Tax Code Area:
 Code: N/A
 City: N/A
 Fire: N/A
 Library: N/A
 School: N/A
 Water: N/A

Assessment Information:
 Tax Year: 2018
 Land Value:
 Agricultural: N/A
 Residential: N/A
 Commercial: \$60,840
 Improvements Value:
 Agricultural: N/A
 Residential: N/A
 Commercial: \$211,300
 Total Market Value: \$272,140
 Total Assessed Value: \$87,085
 Total Taxable Value: \$87,085

Exemptions and Abatements: No exemptions or abatements.

Community Improvement Dist: Property is not in a CID for which Jackson County collects a tax or assessment.

TIF Information: Property is not in a TIF Plan area or TIF Project area known to Jackson County.

ELECTED OFFICIALS

Jackson County

County Executive:

Frank White Jr. (D)

Individual Legislator:

Charlie Franklin (D) - District 3

At-Large Legislator:

Jalen Anderson (D) - District 1

State of Missouri

Representative:

Brandon Ellington (D) - District 22

Senator:

John Rizzo (D) - District 11

Governor:

Michael L Parson (R)

United States

Representative:

Emanuel Cleaver II (D) - District 5

Senator:

Roy Blunt (R)

Senator:

Claire McCaskill (D)



PROPERTY PHOTO



32-210-01-19-00-0-00-000 06/23/2005

STREET MAP



AERIAL PHOTO



9516 East US 40 Hwy

Property Report for 32-210-01-19-00-0-00-000

Parcel ID:	32-210-01-19-00-0-00-000
Parcel Address:	9516 E US 40 HWY INDEPENDENCE MO 64052
Complex Name:	N/A
Mortgage Holder Information:	N/A
Property Characteristics:	Year Built: 1945 Approx. Bldg. Area: 2054 sq. ft. Neighborhood Tax Code: 6380 Approx. Area (Sq Ft): 58,429.48 sq. ft. Approx. Area (Acres): 1.34 acres
Property Class (PCA Code):	N/A
Land Use Type:	1110 - Single Family Residence
Tax Code Area:	Code: City: N/A Fire: N/A Library: N/A School: N/A Water: N/A
Assessment Information:	Tax Year: 2018 Land Value: Agricultural: N/A Residential: \$19,844 Commercial: N/A Improvements Value: Agricultural: N/A Residential: \$114,396 Commercial: N/A Total Market Value: \$134,240 Total Assessed Value: \$25,505 Total Taxable Value: \$25,506
Exemptions and Abatements:	No exemptions or abatements.
Community Improvement Dist:	Property is not in a CID for which Jackson County collects a tax or assessment.
TIF Information:	Property is not in a TIF Plan area or TIF Project area known to Jackson County.



9403 E 35th Street South

Property Report for 32-210-01-16-00-0-00-000

PROPERTY PHOTO



STREET MAP

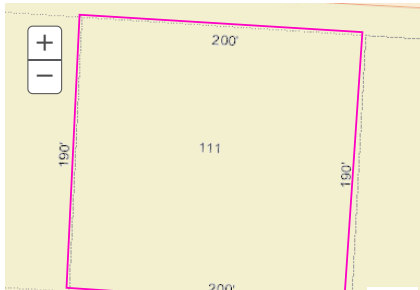

AERIAL PHOTO



Parcel ID: 32-210-01-16-00-0-00-000
Parcel Address: 9403 E 35TH ST S
 INDEPENDENCE
 MO 64052

Complex Name: N/A

Mortgage Holder Information: N/A

Property Characteristics:
 Year Built: N/A
 Approx. Bldg. Area: N/A sq. ft.
 Neighborhood Tax Code: 6380
 Approx. Area (Sq Ft): 37,510.53 sq. ft.
 Approx. Area (Acres): 0.86 acres

Property Class (PCA Code): N/A

Land Use Type: 1101 - Vacant Residential Land

Tax Code Area:
 Code:
 City: N/A
 Fire: N/A
 Library: N/A
 School: N/A
 Water: N/A

Assessment Information:
 Tax Year: 2018
 Land Value:
 Agricultural: N/A
 Residential: \$20,073
 Commercial: N/A
 Improvements Value:
 Agricultural: N/A
 Residential: N/A
 Commercial: N/A
 Total Market Value: \$20,073
 Total Assessed Value: \$3,814
 Total Taxable Value: \$3,814

Exemptions and Abatements: No exemptions or abatements.

Community Improvement Dist: Property is not in a CID for which Jackson County collects a tax or assessment.

TIF Information: Property is not in a TIF Plan area or TIF Project area known to Jackson County.

ELECTED OFFICIALS

Jackson County

County Executive:

Frank White Jr. (D)

Individual Legislator:

Charlie Franklin (D) - District 3

At-Large Legislator:

Jalen Anderson (D) - District 1

State of Missouri

Representative:

Brandon Ellington (D) - District 22

Senator:

John Rizzo (D) - District 11

Governor:

Michael L Parson (R)

United States

Representative:

Emanuel Cleaver II (D) - District 5

Senator:

Roy Blunt (R)

Senator:

Claire McCaskill (D)

9604 & 9516 E US 40 Hwy/9403 E 35th St.

Independence, Missouri 64052

For Sale

Parcel Map



700 W. 47th Street, Suite 200
Kansas City, MO 64112
816.756.1400 | www.BLOCKLLC.com



9604 & 9516 E US 40 Hwy/9403 E 35th St.

Independence, Missouri 64052

For Sale

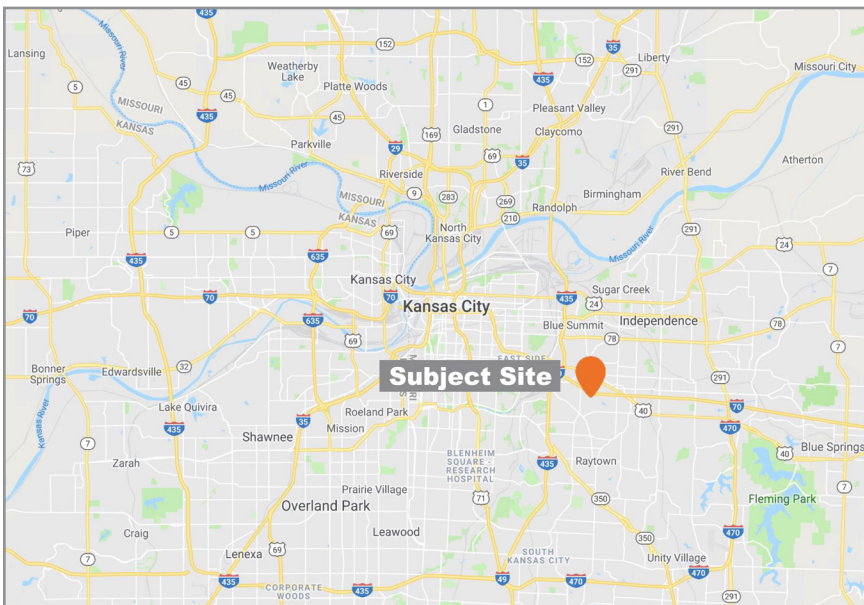

For more information:

Michael R. Block, CPM
816.932.5549
mblock@blockllc.com

Keiten J. Nuspl
816.932.5531
knuspl@blockllc.com

Andrew Fain
816.412.8449
afain@blockllc.com

700 W. 47th Street, Suite 200
Kansas City, MO 64112
816.756.1400 | www.BLOCKLLC.com

BLOCK
REAL ESTATE SERVICES, LLC