

ON THE DOORSTEP TO SANTANA ROW

- ▶ **CREATE YOUR OWN OFFICE!**
±11,571 SF @ 100 Plaza East Building!
First Floor - Separate Plaza Entrance
- ▶ **TENANT INCENTIVE!**
1 YEAR OF FREE FIBER 100 MBPS
GUARANTEED INTERNET SERVICE
- ▶ **Divisible Suites**
3,000 - 6,000 rsf
- ▶ **Monument Signage Available**



3031 Tisch Way, San Jose, CA





FEATURES

- **Premier West Valley office building** adjacent to Santana Row
- **Separate annex building with its own entrance off Plaza**
- **Amenity-rich environment** with newly upgraded out door seating areas for lunches or meetings
- **Easy access** to Interstate 280 & Highway 17
- **Covered and surface parking** – 3.6/1000
- **Monument/Building signage** available
- **Responsive on-site management** with common conference room free of charge
- **Within 5 minutes** of the San Jose International Airport
- **Energy Star Rating** score 98%



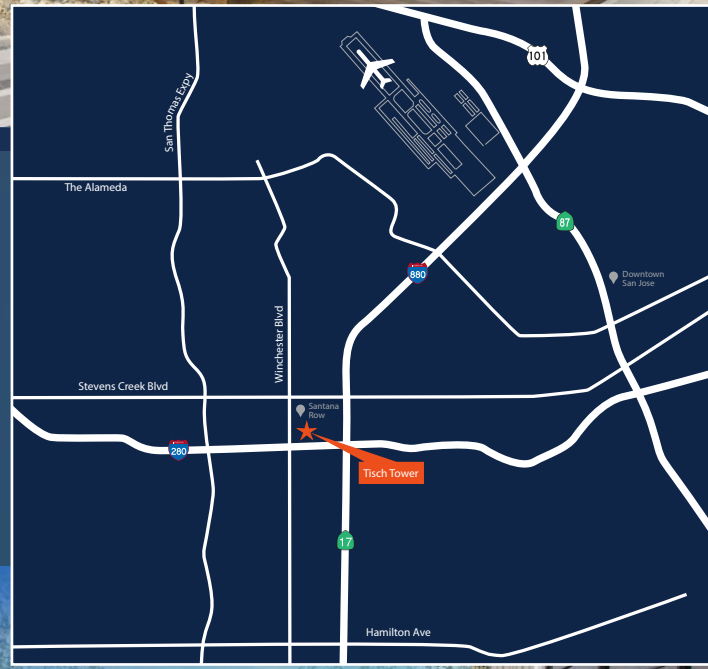

AVAILABLE

FIRST FLOOR | ±11,571 SF

▶ PLAZA EAST SPACE
3031 Tisch Way, 100 PE



PLAZA EAST FLOORPLAN

▶ FIRST FLOOR - ±11,571 SF (divisible to ±3,000 - 6,000 RSF suites)

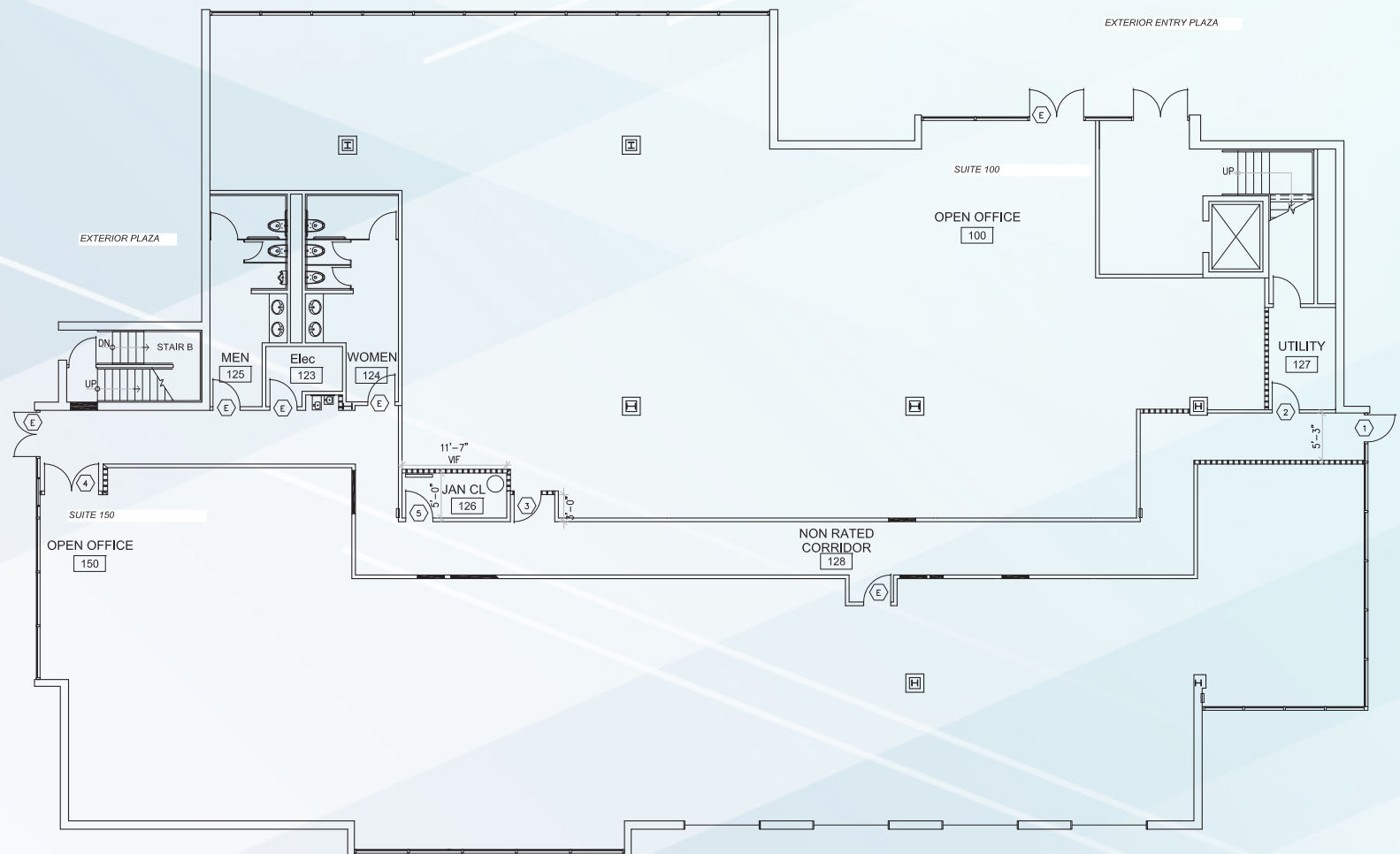



TISCH TOWER

3031 Tisch Way, San Jose, CA



Patty
STEELE

Senior Managing Director • 408.982.8463
psteale@ngkf.com • CA RE License #00839635

Anne
RALSTON

Senior Managing Director • 408.982.8466
aralston@ngkf.com • CA RE License #00957374

the **Muller**
company

The distributor of this communication is performing acts for which a real estate license is required. The information contained herein has been obtained from sources deemed reliable but has not been verified and no guarantee, warranty or representation, either express or implied, is made with respect to such information. Terms of sale or lease and availability are subject to change or withdrawal without notice. 14-0917.08/19