

HARRISBURG MALL

3501 PAXTON STREET, HARRISBURG, PA

±640-188,244 SF AVAILABLE FOR LEASE

JOIN



property highlights.

- Former Boscov's and Toys R Us available for lease immediately.
- Located on the eastern shore of the Pennsylvania Capitol (Harrisburg) along the main commercial corridor.
- Redevelopment opportunity available
- Restaurant space w/ outside seating and liquor license
- Nearby retailers include Walmart, Sam's Club, Target, PetSmart, Giant, Lowe's and more.
- 2 level building with multiple access points



stats.

2017 DEMOGRAPHICS*	3 MILES	5 MILES	10 MILES
EST. POPULATION	85,223	177,037	382,931
EST. HOUSEHOLDS	34,939	75,346	158,928
EST. AVG. HH INCOME	\$58,715	\$68,566	\$83,403

PAXTON STREET TRAFFIC COUNT: 16,543 VPD *ESRI 2017



METRO
COMMERCIAL
REAL ESTATE, INC.

MetroCommercial.com | PHILADELPHIA, PA | PLYMOUTH MEETING, PA | MOUNT LAUREL, NJ | NAPLES, FL | MIAMI, FL

get in touch.

PAT GALLAGHER

office 610.825.5222
direct 610.260.2676
pgallagher@metrocommercial.com

MAX SILVER

office 610.825.5222
direct 610.260.2672
msilver@metrocommercial.com

JOSEPH DOUGHERTY

office 610.825.5222
direct 610.260.2670
jdougherty@metrocommercial.com

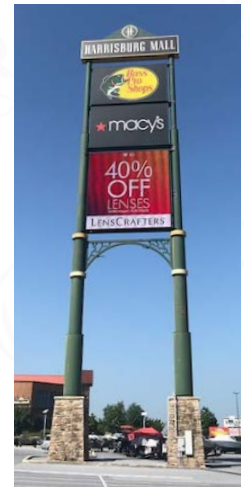

The information and images contained herein are from sources deemed reliable. However, Metro Commercial Real Estate, Inc. makes no representation whatsoever as to their accuracy or authenticity. Images shown may be modified for illustrative purposes. Images may be out-of-date and not current. 11.08.18

HARRISBURG MALL HARRISBURG, PA



FORMER TOYS R US SPACE



The information and images contained herein are from sources deemed reliable. However, Metro Commercial Real Estate, Inc. makes no representation whatsoever as to their accuracy or authenticity. Images shown may be modified for illustrative purposes. Images may be out-of-date and not current. 11.08.18

HARRISBURG MALL
HARRISBURG, PA



FIRST FLOOR

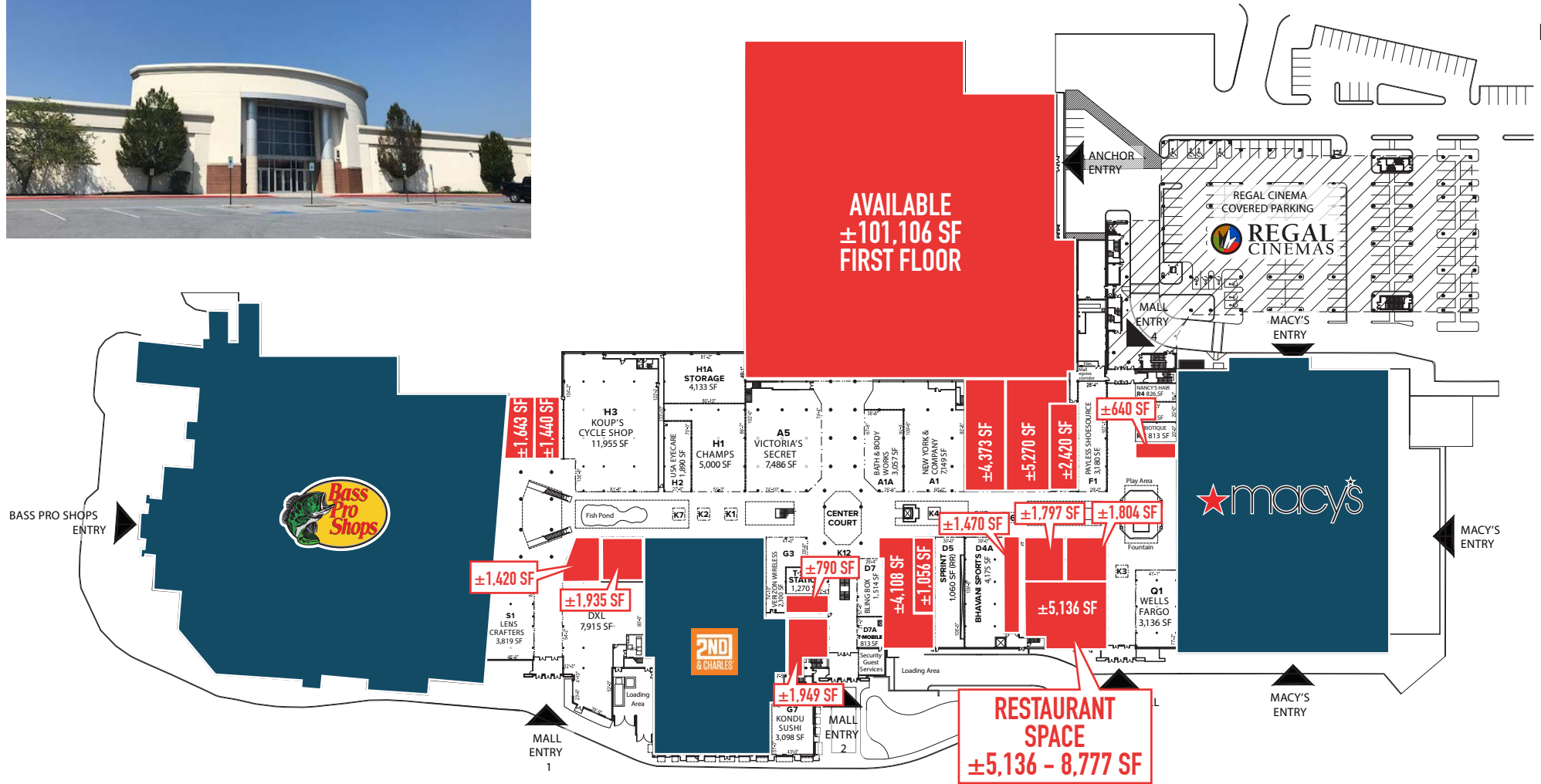

The information and images contained herein are from sources deemed reliable. However, Metro Commercial Real Estate, Inc. makes no representation whatsoever as to their accuracy or authenticity. Images shown may be modified for illustrative purposes. Images may be out-of-date and not current. 11.08.18

HARRISBURG MALL
HARRISBURG, PA



SECOND FLOOR

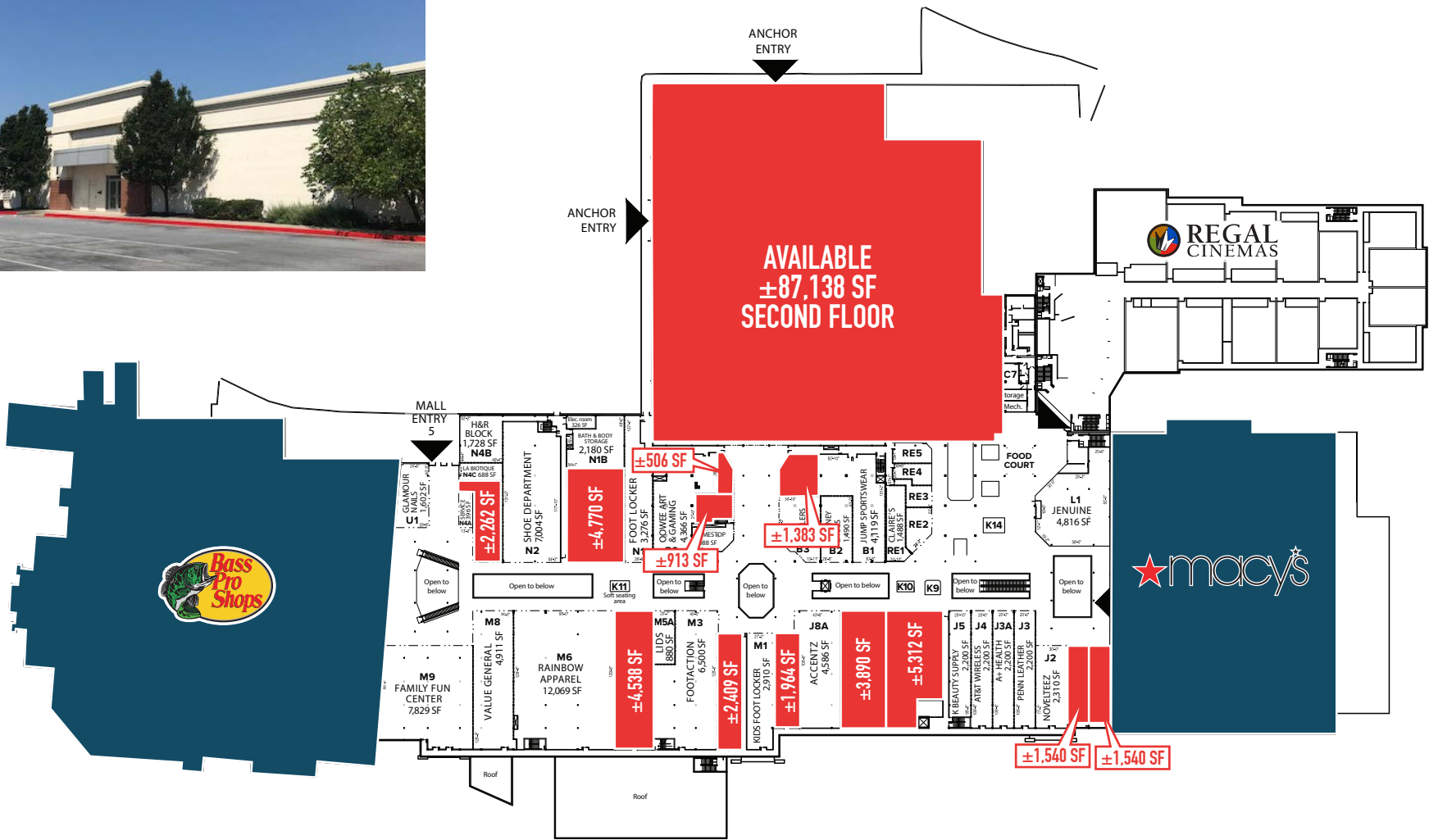

The information and images contained herein are from sources deemed reliable. However, Metro Commercial Real Estate, Inc. makes no representation whatsoever as to their accuracy or authenticity. Images shown may be modified for illustrative purposes. Images may be out-of-date and not current. 11.08.18

HARRISBURG MALL
HARRISBURG, PA





ANCHOR SPACE
±188,244 SF
ON 2 LEVELS

±46,704 SF
AVAILABLE

RESTAURANT
SPACE
±5,136 - 8,777 SF

±3,400 SF
AVAILABLE

±5,000 SF
AVAILABLE

±2,141 SF
AVAILABLE

FRIENDSHIP ROAD

NORTH HARRISBURG STREET

PAXTON STREET 16,543 VPD

83
100,000 VPD



HARRISBURG MALL
HARRISBURG, PA



The information and images contained herein are from sources deemed reliable. However, Metro Commercial Real Estate, Inc. makes no representation whatsoever as to their accuracy or authenticity. Images shown may be modified for illustrative purposes. Images may be out-of-date and not current. 11.08.18



The information and images contained herein are from sources deemed reliable. However, Metro Commercial Real Estate, Inc. makes no representation whatsoever as to their accuracy or authenticity. Images shown may be modified for illustrative purposes. Images may be out-of-date and not current. 11.08.18

HARRISBURG MALL HARRISBURG, PA



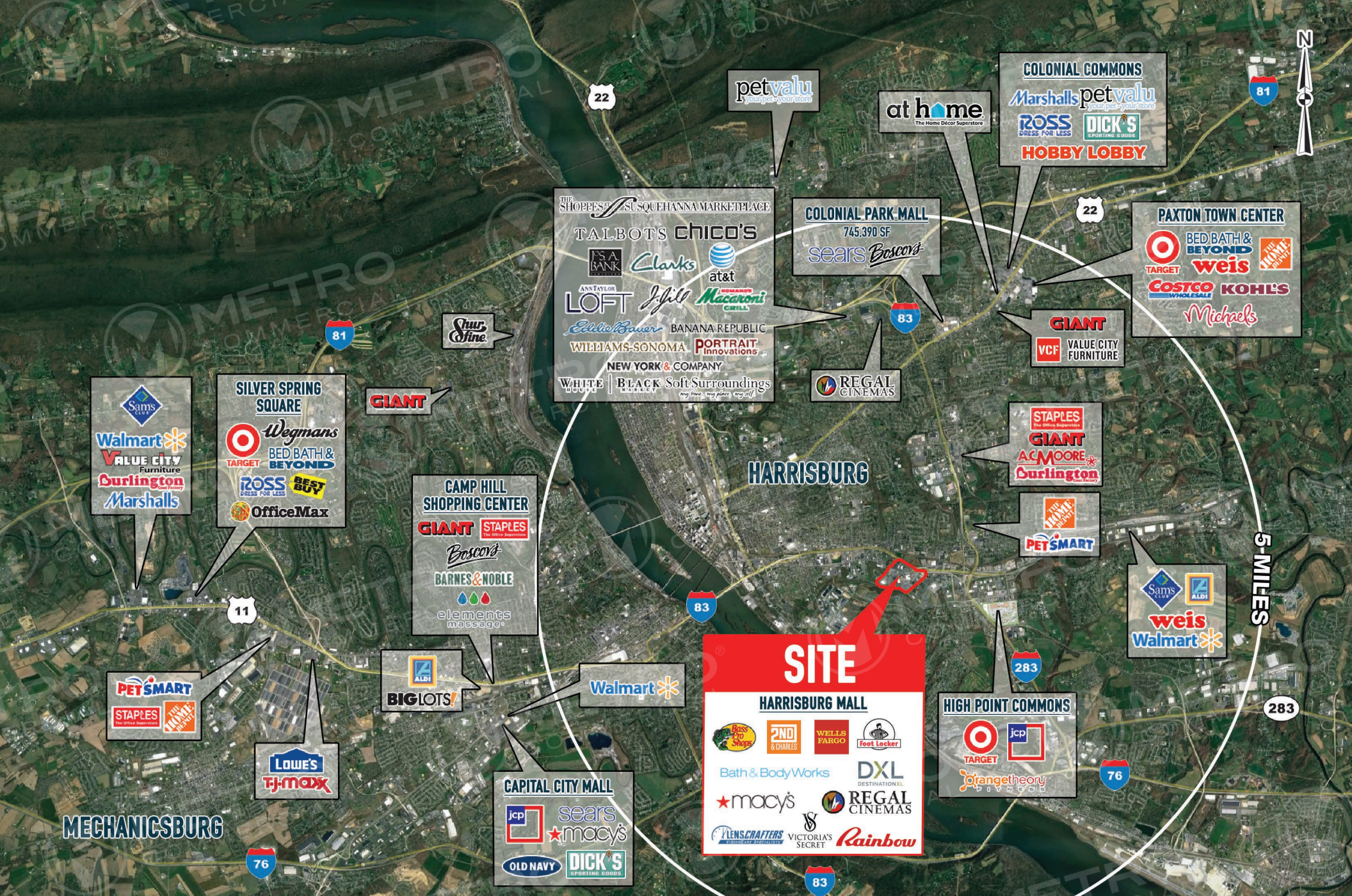

The information and images contained herein are from sources deemed reliable. However, Metro Commercial Real Estate, Inc. makes no representation whatsoever as to their accuracy or authenticity. Images shown may be modified for illustrative purposes. Images may be out-of-date and not current. 11.08.18

HARRISBURG MALL HARRISBURG, PA