

830

— THIRD —

BUILDING FEATURES

- New entrance & modern lobby
- New elevator cabs
- Institutional Ownership
- 24/7 Attended lobby
- Building storage
- Bike room



830 THIRD PREMIUM PACKAGE INCLUDES FURNITURE, MOVING AND CABLING

AVAILABILITIES

FLOOR	SF	CONDITION	POSSESSION
Entire 14th	8,292 SF	Built	9/1/22
Entire 12th	8,367 SF	Built	9/1/22
Entire 11th	12,332 SF	Built	9/1/22
Entire 10th	12,332 SF	Built	9/1/22
Entire 9th	12,332 SF	Demolished with new restrooms	Available now
Partial 8th	6,352 SF	Built	Available now
Partial 8th	5,980 SF	Built	Available now
Entire 7th	12,332 SF	Brand New Full Floor Pre-built	Available now
Partial 6th	5,489 SF	Built	9/1/22
Entire 5th	12,332 SF	Demolished with new restrooms	Available now
Partial 3rd	7,358 SF	Built	Available now
Partial 3rd	4,975 SF	Demolished	Available now

7TH FLOOR PRE-BUILT

EAST 51ST STREET

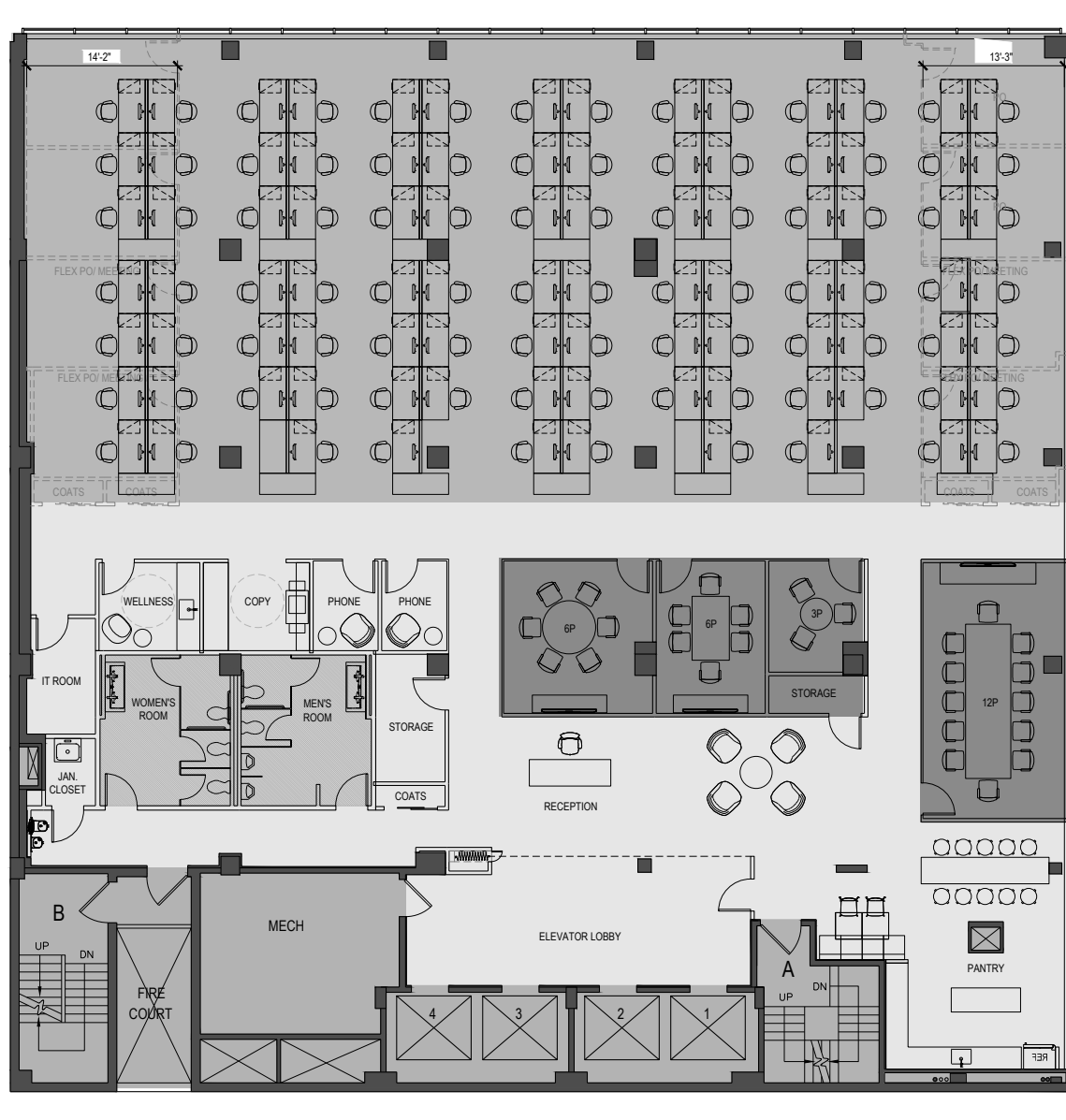

FULL FLOOR FEATURES

- Efficient side core design
- VRF Tenant controlled HVAC
- New restrooms
- Flexible layouts
- Exposed concrete columns

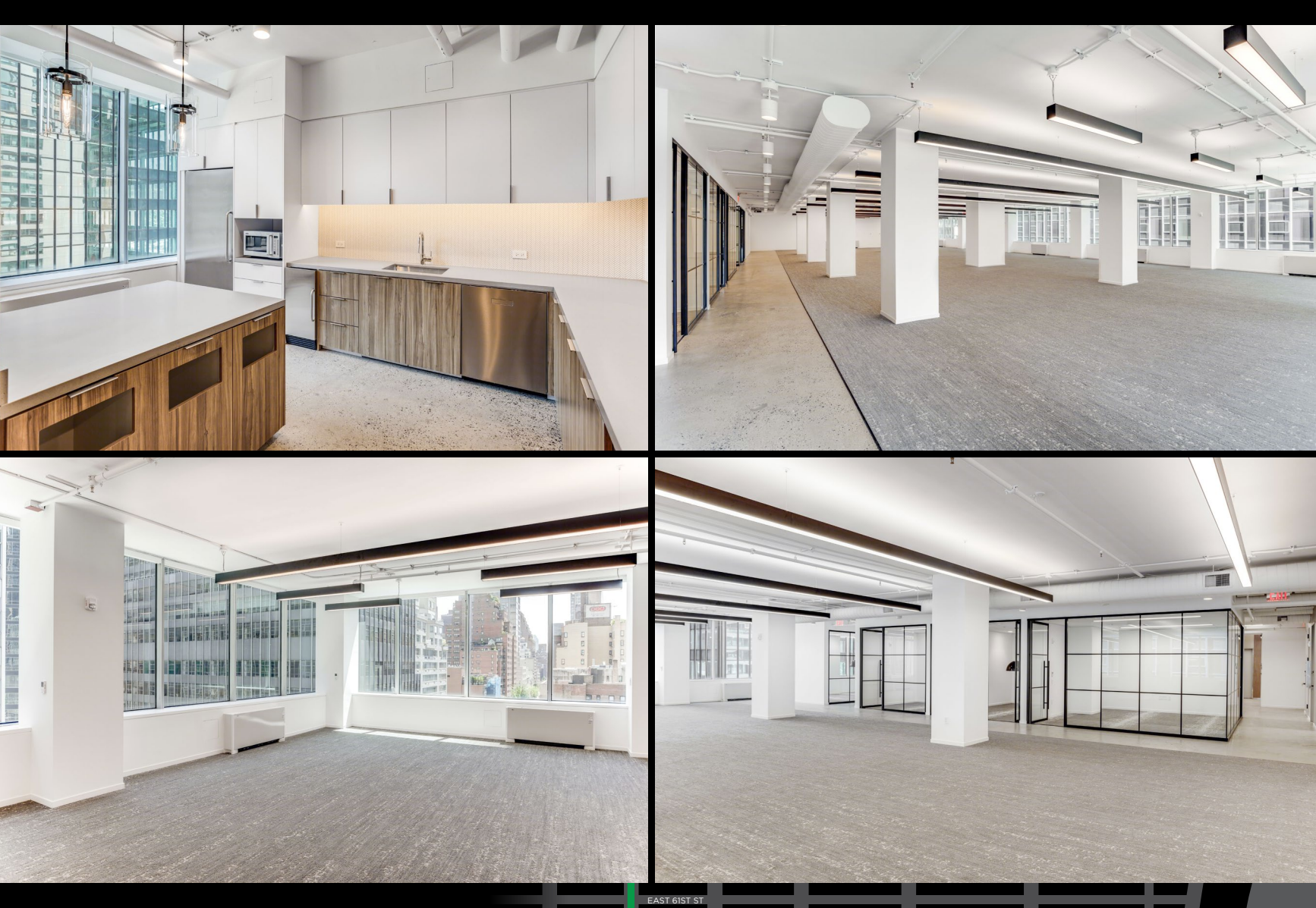

Excellent access to the 6, E & M trains
 Quick commutes to Grand Central & Penn Station

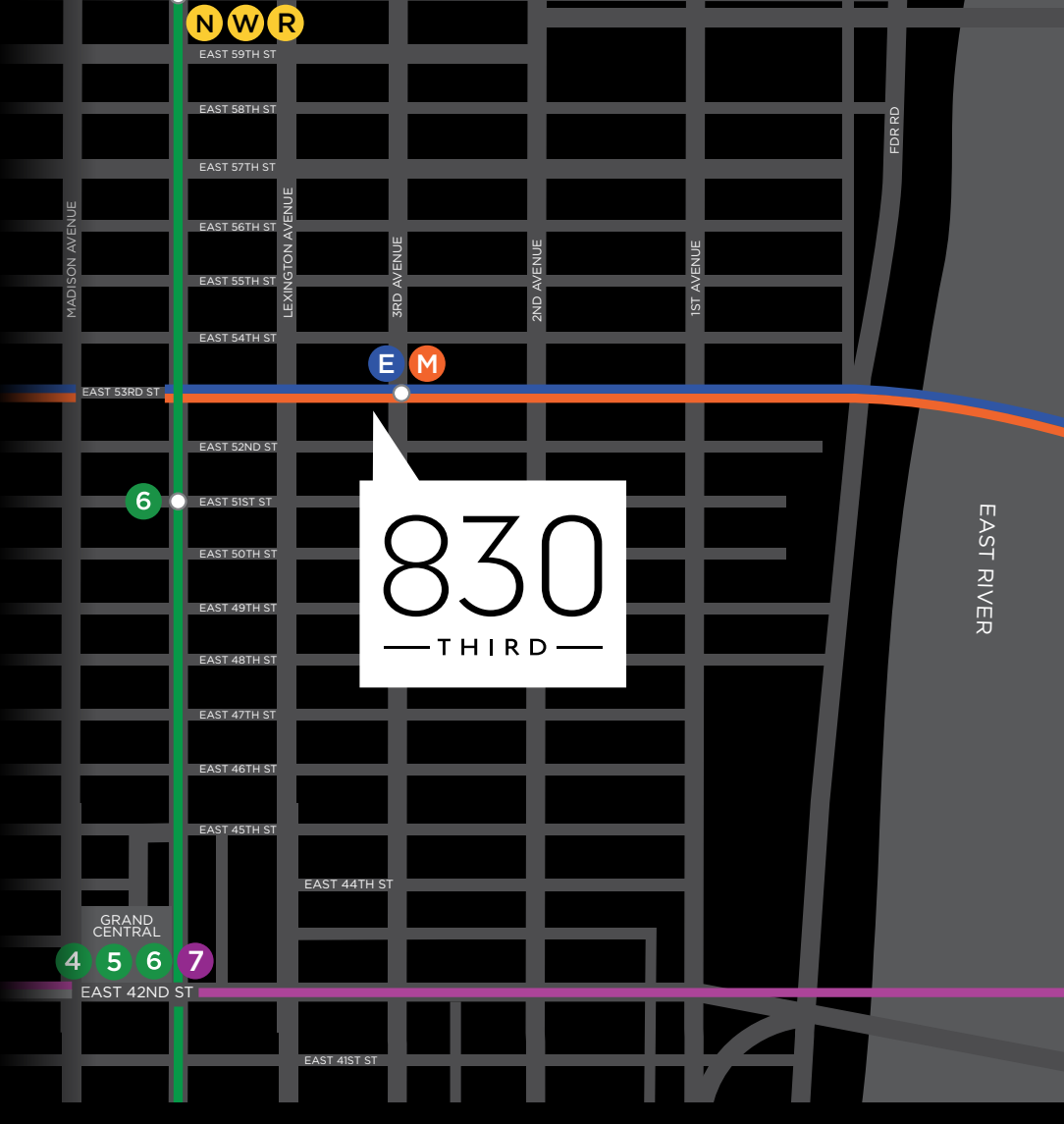

David L. Hoffman, Jr. / 212.318.9767 / david.hoffman@cushwake.com
 Robert Lowe / 212.841.5974 / robert.lowe@cushwake.com
 Whitnee Williams / 212.954.0920 / whitnee.williams@cushwake.com
 Samuel Hoffman / 203.885.3002 / sam.hoffman@cushwake.com



©2022 Cushman & Wakefield. All rights reserved. The information contained in this communication is strictly confidential. This information has been obtained from sources believed to be reliable but has not been verified. NO WARRANTY OR REPRESENTATION, EXPRESS OR IMPLIED, IS MADE AS TO THE CONDITION OF THE PROPERTY (OR PROPERTIES) REFERENCED HEREIN OR AS TO THE ACCURACY OR COMPLETENESS OF THE INFORMATION CONTAINED HEREIN, AND SAME IS SUBMITTED SUBJECT TO ERRORS, OMISSIONS, CHANGE OF PRICE, RENTAL OR OTHER CONDITIONS, WITHDRAWAL WITHOUT NOTICE, AND TO ANY SPECIAL LISTING CONDITIONS IMPOSED BY THE PROPERTY OWNER(S). ANY PROJECTIONS, OPINIONS OR ESTIMATES ARE SUBJECT TO UNCERTAINTY AND DO NOT SIGNIFY CURRENT OR FUTURE PROPERTY PERFORMANCE.