

# SUNSET PLAZA 5905-6015 PACIFIC ST ROCKLIN, CA

1,211 SF - 3,633 SF AVAILABLE

**ETHAN CONRAD**  
PROPERTIES INC.

## MAJOR REMODEL COMPLETED

FOR MORE INFORMATION CONTACT:

**Chase Burke**

DRE: #01879336

[chase@ethanconradprop.com](mailto:chase@ethanconradprop.com)

**Andy Jonsson**

DRE: #02076108

[andy@ethanconradprop.com](mailto:andy@ethanconradprop.com)

**916.779.1000**

ETHAN CONRAD PROPERTIES, INC.

1300 NATIONAL DRIVE, SUITE 100 | SACRAMENTO CA, 95834 | FAX: 916.779.1200

[www.ethanconradprop.com](http://www.ethanconradprop.com)



**FEATURES:**

- Located 1/4 of a mile from I-80 and within 2 miles of the Galleria Mall in Roseville
- Excellent visibility on the prominent corner of Pacific St and Sunset Blvd
- Strong traffic counts of 41,000 cars per day
- Surrounded by dense residential neighborhoods with outstanding demographics

**COMMENTS:**

Sunset Plaza is an established neighborhood shopping center located on a prominent corner in Rocklin, CA. This center has excellent visibility and a strong tenant mix including: Carquest, 7-Eleven, Jasmine Donuts, Sam's Barbershop, and Rocklin Dance Center.

This center is located in a retail hub with strong daily traffic and other prominent national retailers such as Walmart, Les Schwab, Sherwin Williams and Dutch Bros.

**LEASE RATES:**

\$1.19 - \$1.49 PSF, NNN

NNN costs are approximately \$0.32 PSF

**DEMOGRAPHICS**

|                      | 1 Mile                                 | 3 Mile    | 5 Mile    |
|----------------------|--|-----------|-----------|
| 2018 Est Population: | 10,922                                 | 86,097    | 202,234   |
| 2018 Avg. HH Income: | \$81,211                               | \$111,463 | \$114,816 |
| Daily Traffic Count: | Pacific St 16,614 & Sunset Blvd 25,808 |           |           |

**Chase Burke**

DRE: #01879336

chase@ethanconradprop.com

**Andy Jonsson**

DRE: #02076108

andy@ethanconradprop.com

**ETHAN CONRAD PROPERTIES, INC.**

1300 NATIONAL DRIVE, SUITE 100 | SACRAMENTO CA, 95834 | 916.779.1000

www.ethanconradprop.com

FOR LEASE

**SUNSET PLAZA**  
**5905-6015 PACIFIC ST**  
ROCKLIN, CA

**SITE PLAN**

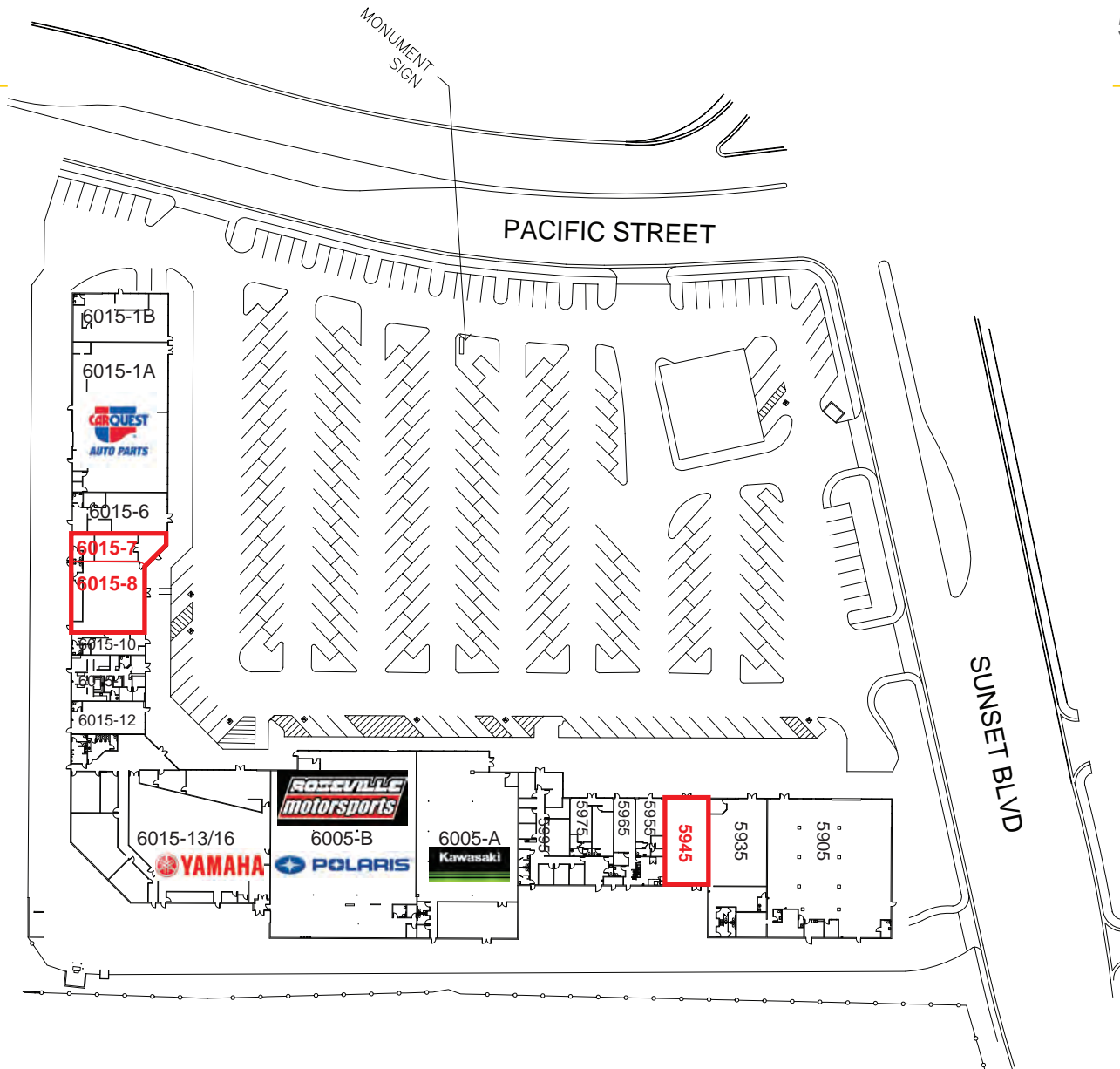

**Chase Burke**  
DRE: #01879336  
[chase@ethanconradprop.com](mailto:chase@ethanconradprop.com)

**Andy Jonsson**  
DRE: #02076108  
[andy@ethanconradprop.com](mailto:andy@ethanconradprop.com)

**ETHAN CONRAD PROPERTIES, INC.**  
1300 NATIONAL DRIVE, SUITE 100 | SACRAMENTO CA, 95834 | 916.779.1000  
[www.ethanconradprop.com](http://www.ethanconradprop.com)

The information contained herein has been obtained from sources we believe to be reliable. However, we cannot guarantee, warrant or represent its accuracy and all information is subject to error, change or withdrawal. An interested party and their advisors should conduct an independent investigation of the property to determine to your satisfaction the suitability of the property for your needs.

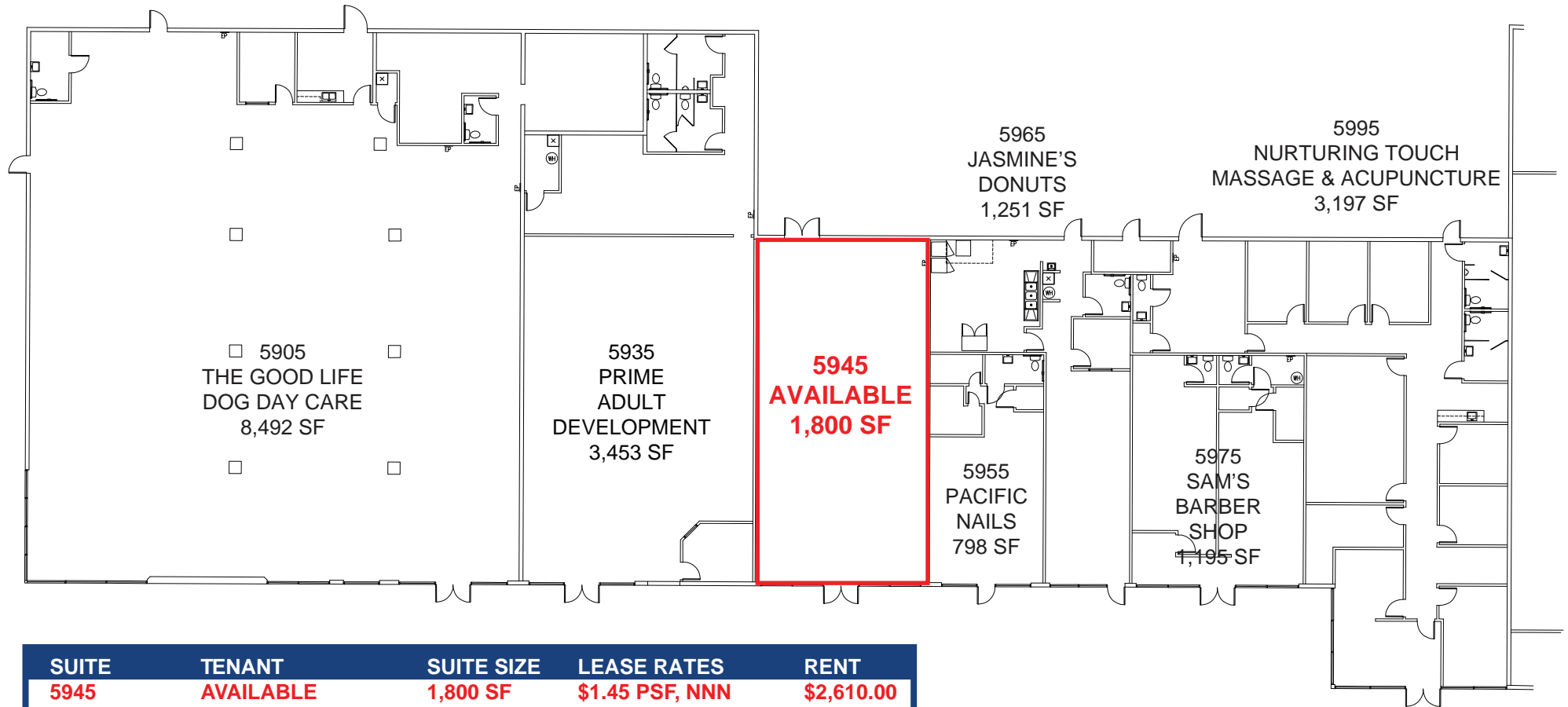

| SUITE  | TENANT           | SUITE SIZE      | LEASE RATES            | RENT              |
|--|------------------|-----------------|------------------------|-------------------|
| <b>5945</b>                                    | <b>AVAILABLE</b> | <b>1,800 SF</b> | <b>\$1.45 PSF, NNN</b> | <b>\$2,610.00</b> |
| <b>NNN costs are approximately \$0.32 PSF.</b> |                  |                 |                        |                   |

**Chase Burke**  
 DRE: #01879336  
[chase@ethanconradprop.com](mailto:chase@ethanconradprop.com)

**Andy Jonsson**  
 DRE: #02076108  
[andy@ethanconradprop.com](mailto:andy@ethanconradprop.com)

**ETHAN CONRAD PROPERTIES, INC.**  
 1300 NATIONAL DRIVE, SUITE 100 | SACRAMENTO CA, 95834 | 916.779.1000  
[www.ethanconradprop.com](http://www.ethanconradprop.com)

The information contained herein has been obtained from sources we believe to be reliable. However, we cannot guarantee, warrant or represent its accuracy and all information is subject to error, change or withdrawal. An interested party and their advisors should conduct an independent investigation of the property to determine to your satisfaction the suitability of the property for your needs.

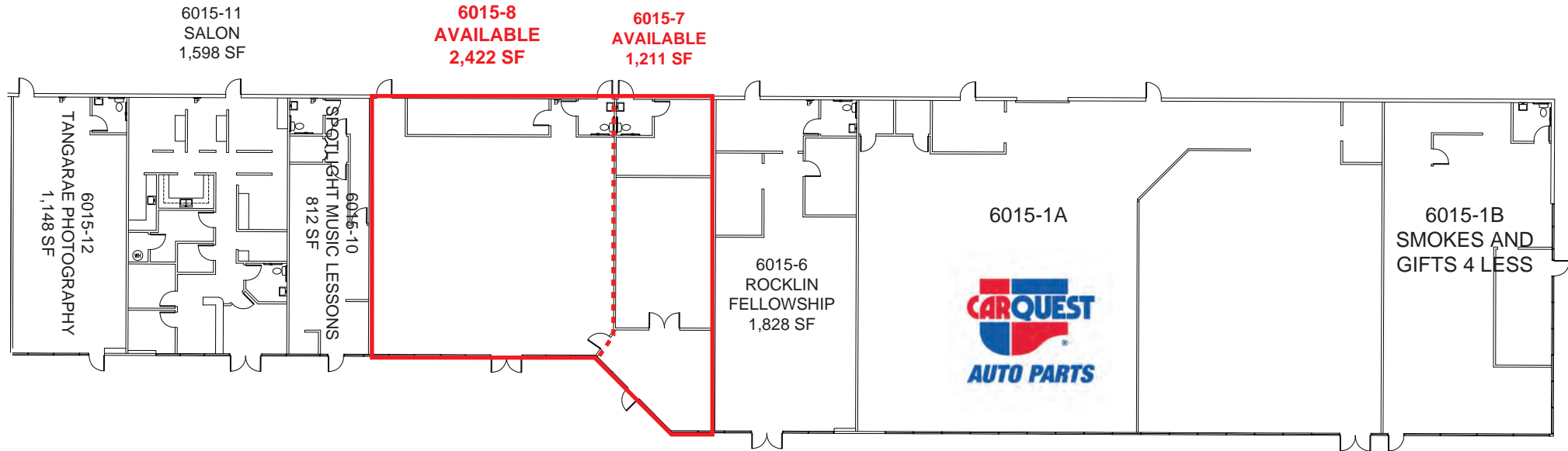

| SUITE  | TENANT           | SUITE SIZE      | LEASE RATES            | RENT              |
|--|------------------|-----------------|------------------------|-------------------|
| <b>6015-7</b>                                  | <b>AVAILABLE</b> | <b>1,211 SF</b> | <b>\$1.49 PSF, NNN</b> | <b>\$1,804.00</b> |
| <b>6015-8</b>                                  | <b>AVAILABLE</b> | <b>2,422 SF</b> | <b>\$1.35 PSF, NNN</b> | <b>\$3,270.00</b> |
| <b>6015-7/8</b>                                | <b>AVAILABLE</b> | <b>3,633 SF</b> | <b>\$1.29 PSF, NNN</b> | <b>\$4,687.00</b> |
| <b>NNN costs are approximately \$0.32 PSF.</b> |                  |                 |                        |                   |

**Chase Burke**  
 DRE: #01879336  
[chase@ethanconradprop.com](mailto:chase@ethanconradprop.com)

**Andy Jonsson**  
 DRE: #02076108  
[andy@ethanconradprop.com](mailto:andy@ethanconradprop.com)

**ETHAN CONRAD PROPERTIES, INC.**  
 1300 NATIONAL DRIVE, SUITE 100 | SACRAMENTO CA, 95834 | 916.779.1000  
[www.ethanconradprop.com](http://www.ethanconradprop.com)

The information contained herein has been obtained from sources we believe to be reliable. However, we cannot guarantee, warrant or represent its accuracy and all information is subject to error, change or withdrawal. An interested party and their advisors should conduct an independent investigation of the property to determine to your satisfaction the suitability of the property for your needs.



FOR LEASE

**SUNSET PLAZA**  
**5905-6015 PACIFIC ST**  
ROCKLIN, CA



**Chase Burke**

DRE: #01879336

chase@ethanconradprop.com

**Andy Jonsson**

DRE: #02076108

andy@ethanconradprop.com

**ETHAN CONRAD PROPERTIES, INC.**

1300 NATIONAL DRIVE, SUITE 100 | SACRAMENTO CA, 95834 | 916.779.1000

www.ethanconradprop.com

The information contained herein has been obtained from sources we believe to be reliable. However, we cannot guarantee, warrant or represent its accuracy and all information is subject to error, change or withdrawal. An interested party and their advisors should conduct an independent investigation of the property to determine to your satisfaction the suitability of the property for your needs.

PAGE

6



FOR LEASE

SUNSET PLAZA  
5905-6015 PACIFIC ST  
ROCKLIN, CA



**Chase Burke**  
DRE: #01879336  
chase@ethanconradprop.com

**Andy Jonsson**  
DRE: #02076108  
andy@ethanconradprop.com

**ETHAN CONRAD PROPERTIES, INC.**  
1300 NATIONAL DRIVE, SUITE 100 | SACRAMENTO CA, 95834 | 916.779.1000  
www.ethanconradprop.com

The information contained herein has been obtained from sources we believe to be reliable. However, we cannot guarantee, warrant or represent its accuracy and all information is subject to error, change or withdrawal. An interested party and their advisors should conduct an independent investigation of the property to determine to your satisfaction the suitability of the property for your needs.