

FOR LEASE

NORTHERN STAR PROFESSIONAL CENTER

14201 NE 20th Ave, Bldg B | Vancouver, WA 98686



900 Washington St, Suite 850, Vancouver, WA
360.750.5595 | www.fg-cre.com



PROPERTY HIGHLIGHTS

- Located in the rapidly growing Salmon Creek area, this Class A medical building features newly updated lobby, common areas and restrooms. The building is one block north of Legacy Salmon Creek hospital and one block south of Kaiser Permanente. Retail services, shopping and dining close by.
- AVAILABILITY:
 - Suite B103 – 3,349 RSF
 - Suite B104 – 2,746 RSF
- LEASE RATE: \$26.50/SF, Full Service
- ZONING: CC (Community Commercial)
- PARKING: 5:1,000 SF

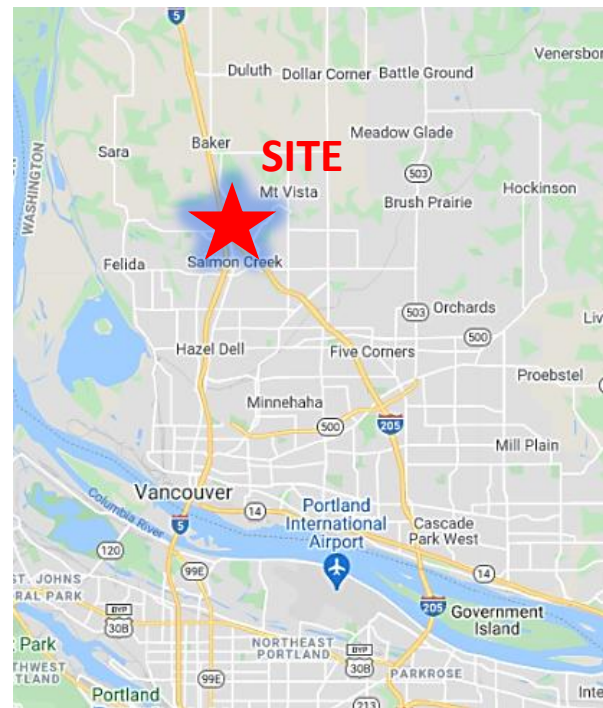

FOR MORE INFORMATION:

Adam Roselli, CCIM, SIOR
360.597.0568 | aroselli@fg-cre.com

FOR LEASE

NORTHERN STAR PROFESSIONAL CENTER

14201 NE 20th Ave, Bldg B | Vancouver, WA 98686



900 Washington St, Suite 850, Vancouver, WA
360.750.5595 | www.fg-cre.com

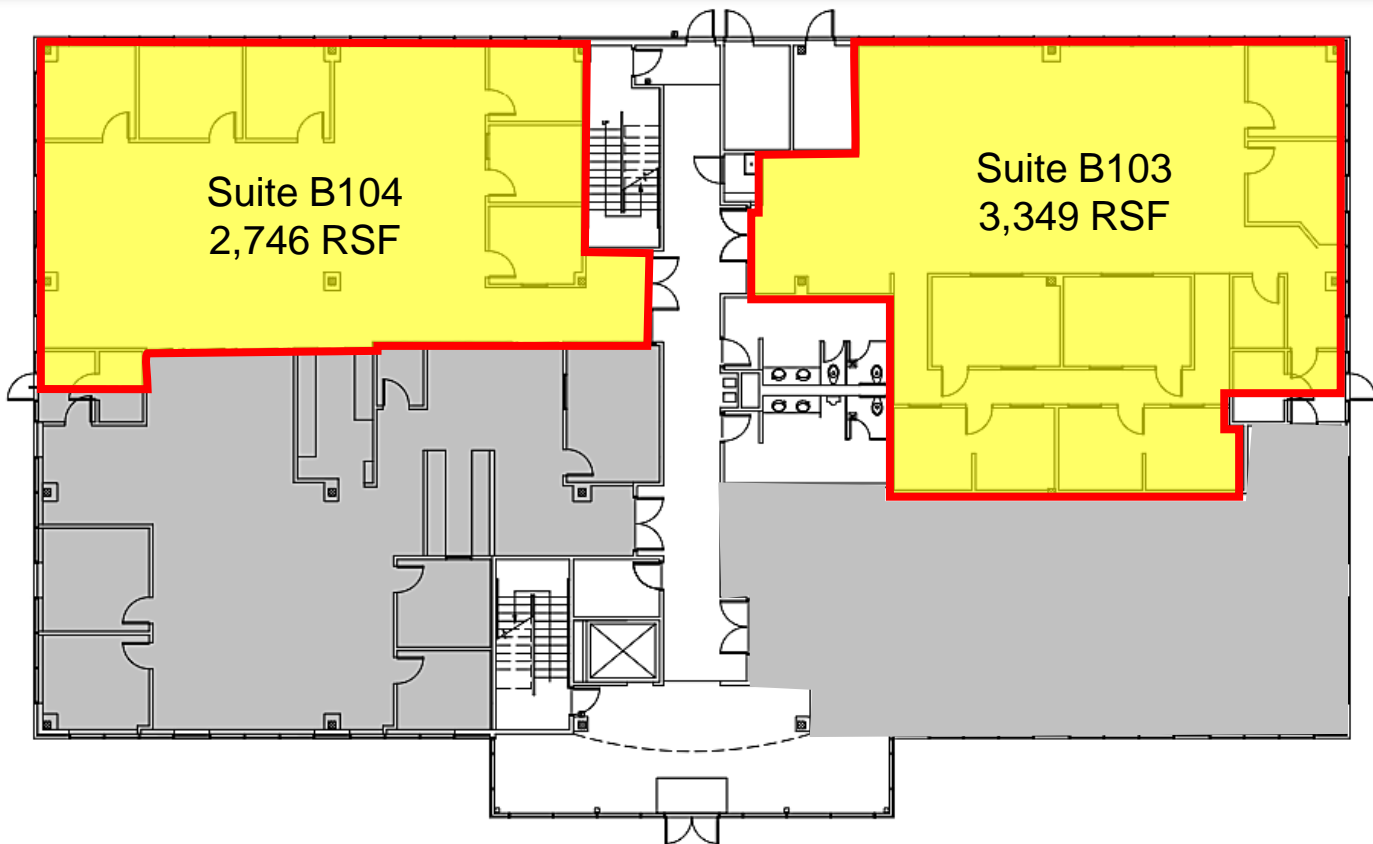

FOR LEASE

NORTHERN STAR PROFESSIONAL CENTER

14201 NE 20th Ave, Bldg B | Vancouver, WA 98686



900 Washington St, Suite 850, Vancouver, WA
360.750.5595 | www.fg-cre.com

