

# 1300 W MOCKINGBIRD LN

DALLAS TX 75247



- New & well capitalized ownership
- Plug and Play Call Center (27,530 RSF)  
253 work stations in place
- Big block of contiguous space  
55,000 SF, floors 4, & 5



## A NEW LEVEL OF CLASS IN THE STEMMONS MARKET.

Aggressive leasing and new amenities make this property an ideal choice for tenants with extra parking needs and large floor plates.

Just minutes from Dallas Love Field Airport with easy access to I-35, Mockingbird Lane and John Carpenter Freeway.

Call Kolby Dickerson 214 - 534 - 1599

[kdickerson@txreproperties.com](mailto:kdickerson@txreproperties.com)



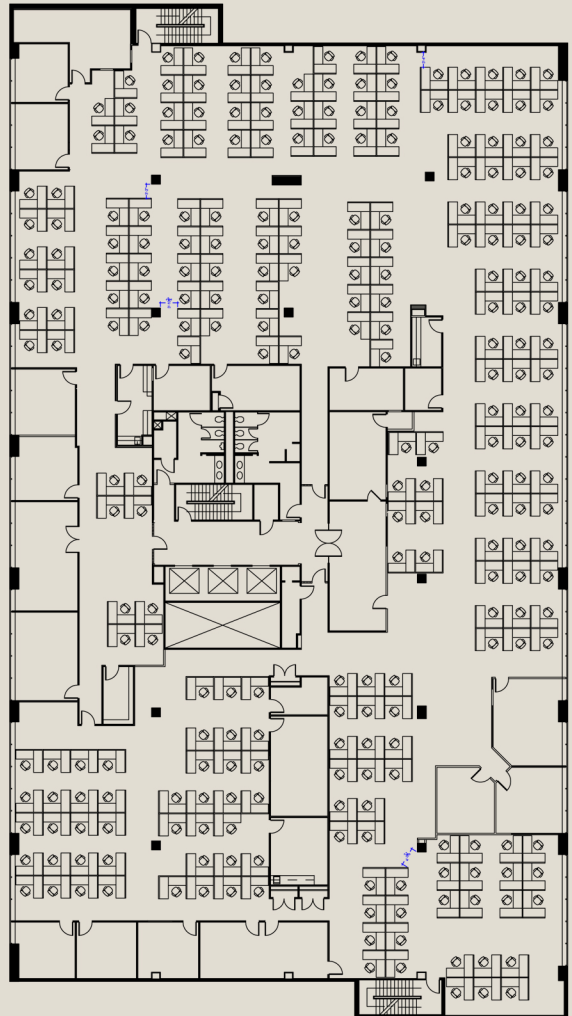

Kolby Dickerson

**Mobile: 214-534-1599**

Justin Smith

**Mobile: 214-207-7173**

**info@txreproperties.com**

[www.txreproperties.com](http://www.txreproperties.com)

Fourth floor  
253 work stations  
27,530 RSF

1300 Mockingbird Lane Dallas TX 75247