

FOR SUBLEASE

SEATAC SUBLEASE

21024

24TH AVENUE SOUTH

SeaTac, WA 98098



PROPERTY INFORMATION

- + 25,639 SF with 1,781 SF of office
- + 8 dock doors
- + 2 ramp doors
- + 30' clear height
- + ESFR Sprinklers
- + Sublease or Direct Deal possible
- + Available September 1, 2018
- + Call for rates

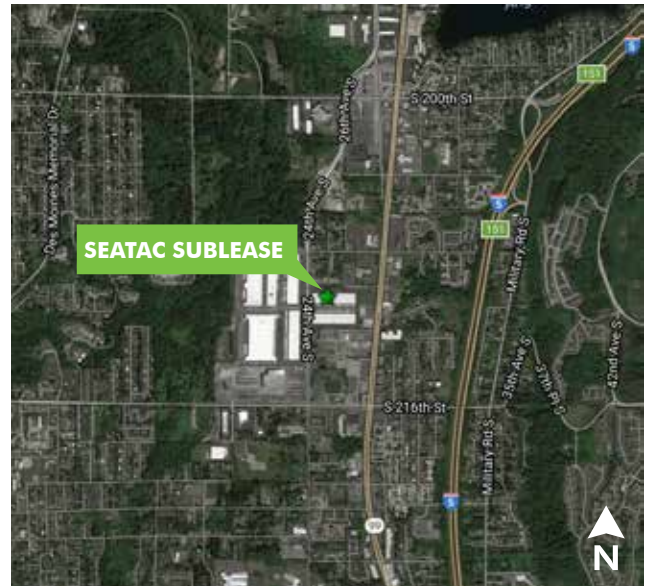

CONTACT US

ANDREW HITCHCOCK

+1 206 442 2719
andrew.hitchcock@cbre.com

ANDREW STARK

+1 206 442 2746
andrew.stark@cbre.com

ZAC SNEDEKER

+1 206 442 2709
zac.snedeker@cbre.com

CBRE, Inc.
1420 5th Ave, Ste 1700
Seattle, WA 98101

www.cbre.us/seattle

CBRE

FOR SUBLEASE SEATAC SUBLEASE

21024
24TH AVENUE SOUTH
SeaTac, WA 98198



SITE PLAN

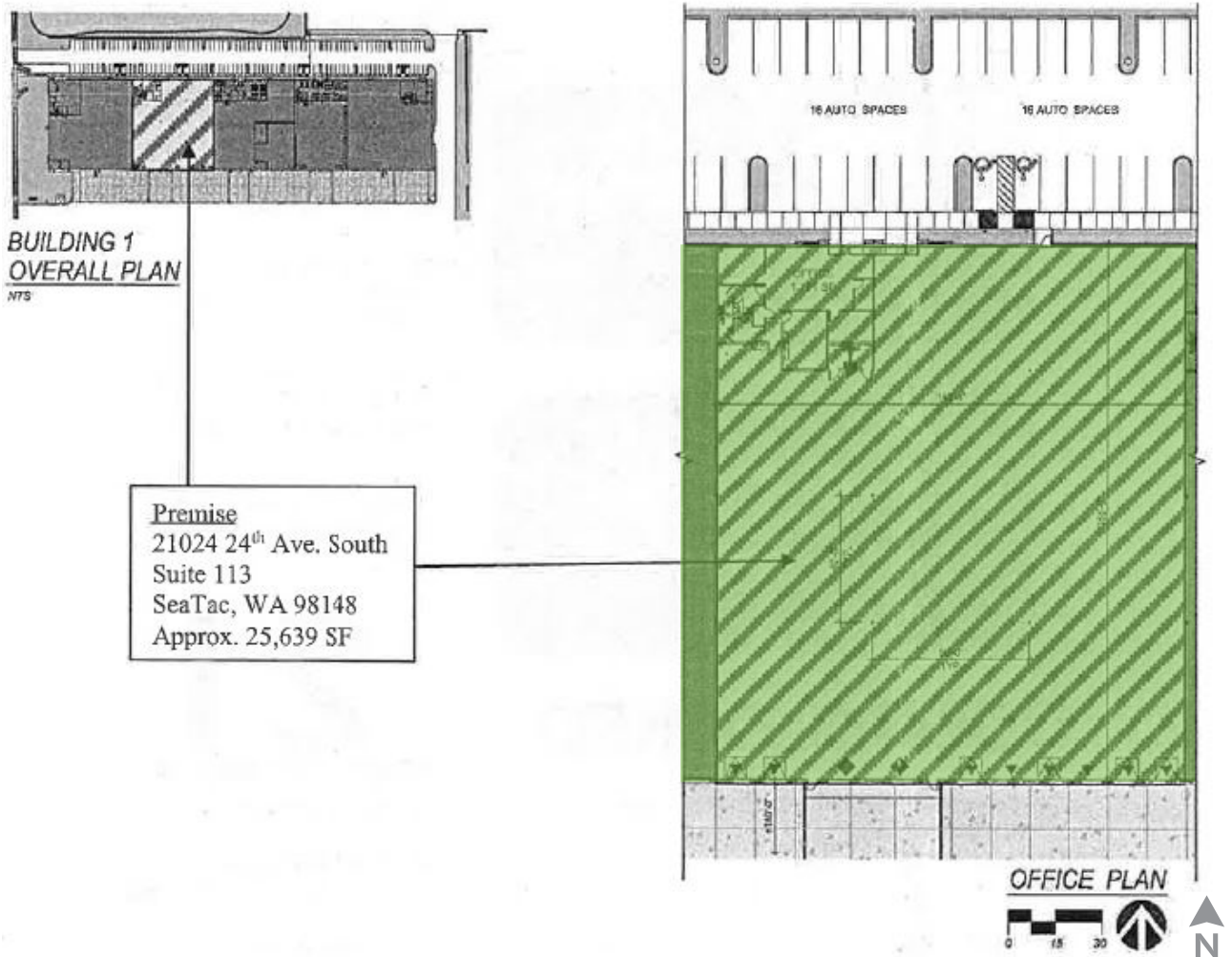

© 2018 CBRE, Inc. All rights reserved. This information has been obtained from sources believed reliable, but has not been verified for accuracy or completeness. You should conduct a careful, independent investigation of the property and verify all information. Any reliance on this information is solely at your own risk. CBRE and the CBRE logo are service marks of CBRE, Inc. All other marks displayed on this document are the property of their respective owners. Photos herein are the property of their respective owners. Use of these images without the express written consent of the owner is prohibited. KK 051718