

# 174 BROADWAY



EXISTING CONDITIONS



CONCEPTUAL RENDERING

# SPACE DETAILS

## LOCATION

Northeast corner of Maiden Lane

## APPROXIMATE SIZE

Ground Floor\* 1,100 SF

\*Basement available

## CEILING HEIGHT

Ground Floor 13 FT

## FRONTAGE

70 FT of wraparound

## TERM

Long term

## POSSESSION

Immediate

## SITE STATUS

Formerly Vitamin Shoppe

## COMMENTS

Situated one block from the Fulton Transit Center, servicing the

**2 3 4 5 A C E J Z R W** and **PATH** trains with 26.8 annual riders

## NEIGHBORS



## GROUND FLOOR

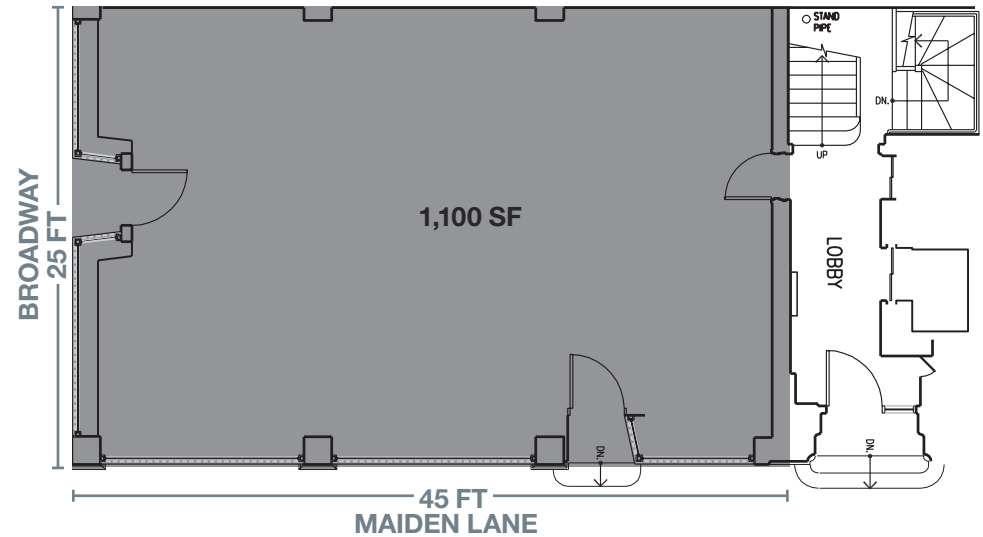

## AREA DEMOGRAPHICS



**\$214K** average household income

**31.8** residential units and over **980** units under construction in Lower Manhattan



**14.6M** visitors to Lower Manhattan in 2018



**88M SF** of total office space

**667K** total office employees in Lower Manhattan



**127M** annual transit riders

12 subway lines, 30 bus routes, 6 ferry stops, 2 Path train routes, 30 Citibike stations

# AREA RETAIL



## CONTACT EXCLUSIVE AGENTS

**BARRY FISHBACH**  
212.331.0115  
barry.fishbach@ngkf.com

**LUCAS KOOYMAN**  
212.372.2384  
lkooyman@ngkf.com

**JASON PRUGER**  
212.372.2092  
jpruger@ngkf.com



NGKF.COM

© 2020 NEWMARK KNIGHT FRANK RETAIL. The information contained herein has been obtained from sources deemed reliable but has not been verified and no guarantee, warranty or representation, either express or implied, is made with respect to such information. Terms of sale or lease and availability are subject to change or withdrawal without notice.