



DOWNTOWN BOISE OFFICES



THE EAGLES CENTER BLDG.

223 North 6th Street
Boise, Idaho 83702

228 TO 643 SF

PROPERTY HIGHLIGHTS

Suite 225	643 SF - \$1,200/Month
Suite 235	257 SF - \$400/Month
Suite 305	228 SF - \$450/Month
Suite 310	339 SF - \$475/Month
Lease Type	Full Service Including Janitorial & Utilities
Building Size	30,000 SF ±
Parking	Surrounded by Street Parking & Public Garages
LockBox	No, Spaces Shown by Appointment Only



JENNIFER MCENTEE

Director
Office/Investment Specialist
+1 208 287 9495
jennifer.mcentee@paccra.com

BREE WELLS

Senior Associate
Office Specialist
+1 208 287 9492
bree.wells@paccra.com

DJ THOMPSON

Director
Office/Investment Specialist
+1 208 287 8438
dj.thompson@paccra.com

999 West Main Street, Ste 1300

Boise, Idaho 83702
Main +1 208 287 9500
Fax +1 208 287 9501
paccra.com

THE EAGLES CENTER BLDG.

223 North 6th Street, Boise, Idaho 83702

FOR LEASE - 228 TO 643 SF



LISTING FEATURES

Second Floor - Suite 225: 643 SF - \$1,200/Month & Suite 235: 257 SF - \$400/Month

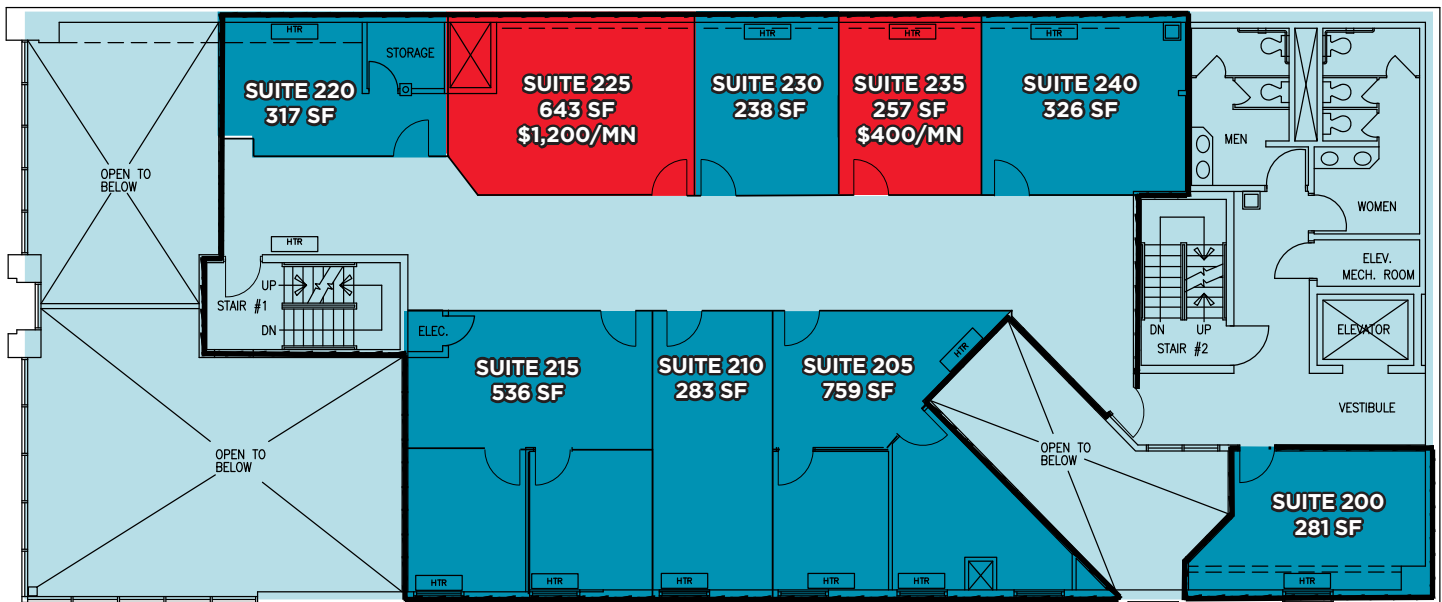

Listing Features

- Prime Downtown Boise Location at the Corner of 6th & Idaho
- Beautiful Historic Landmark Building
- Short Term Leases Available, Contact Agent for Details
- Existing Tenants Include Java Coffee & Spa Urbana
- Spaces & Lobby Area are Newly Remodeled
- Secure Building with After Hours Access
- Full Service Lease Including Janitorial & Utilities
- Tenants are Allowed Access to a Shared Conference Room
- Space Showings By Appointment Only, Contact Pacific Agent: Jennifer McEntee

JENNIFER MCENTEE
Director
Office/Investment Specialist
+1 208 287 9495
jennifer.mcentee@paccra.com

BREE WELLS
Senior Associate
Office Specialist
+1 208 287 9492
bree.wells@paccra.com

DJ THOMPSON
Director
Office/Investment Specialist
+1 208 287 8438
dj.thompson@paccra.com

999 W Main Street, Ste 1300
Boise, Idaho 83702
Main +1 208 287 9500
Fax +1 208 287 9501
paccra.com

THE EAGLES CENTER BLDG.

223 North 6th Street, Boise, Idaho 83702

FOR LEASE - 228 TO 643 SF



LISTING FEATURES

Third Floor - Suite 305: 228 SF \$450/Month & Suite 310: 339 SF \$475/Month

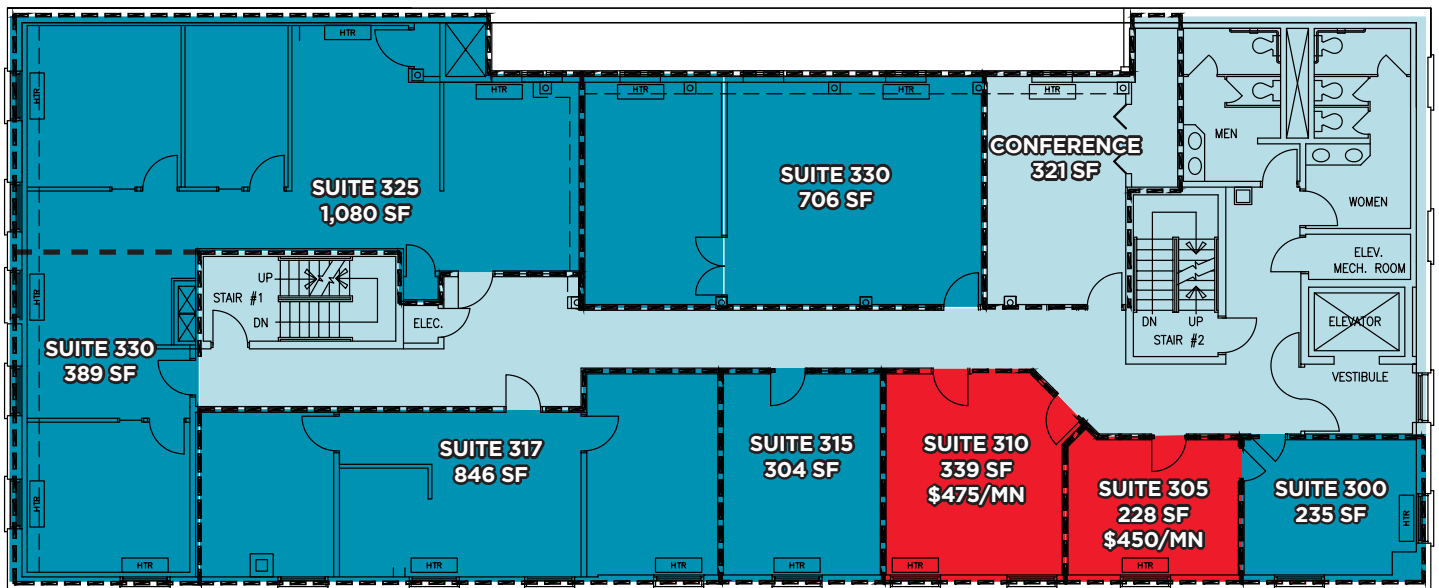

JENNIFER MCENTEE
Director
Office/Investment Specialist
+1 208 287 9495
jennifer.mcentee@paccra.com

BREE WELLS
Senior Associate
Office Specialist
+1 208 287 9492
bree.wells@paccra.com

DJ THOMPSON
Director
Office/Investment Specialist
+1 208 287 8438
dj.thompson@paccra.com

999 W Main Street, Ste 1300
Boise, Idaho 83702
Main +1 208 287 9500
Fax +1 208 287 9501
paccra.com

THE EAGLES CENTER BLDG.

223 North 6th Street, Boise, Idaho 83702

FOR LEASE - 228 TO 643 SF



LISTING PHOTOS



JENNIFER MCENTEE
Director
Office/Investment Specialist
+1 208 287 9495
jennifer.mcentee@paccra.com

BREE WELLS
Senior Associate
Office Specialist
+1 208 287 9492
bree.wells@paccra.com

DJ THOMPSON
Director
Office/Investment Specialist
+1 208 287 8438
dj.thompson@paccra.com

999 W Main Street, Ste 1300
Boise, Idaho 83702
Main +1 208 287 9500
Fax +1 208 287 9501
paccra.com

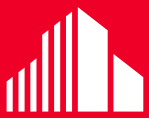

**CUSHMAN &
WAKEFIELD**

PACIFIC
COMMERCIAL REALTY ADVISORS

THE EAGLES CENTER BLDG.

223 North 6th Street, Boise, Idaho 83702

FOR LEASE - 228 TO 643 SF



SURROUNDING AMENITIES



Restaurants in Close Proximity

- The Melting Pot
- Flatbread Pizzeria
- Jimmy John's Sandwiches
- Fork
- Bardenay
- Reef

Businesses in Close Proximity

- Boise City Hall
- Idaho State Capital
- Downtown Boise Association
- St Luke's Medical Center
- Elk's Rehabilitation Hospital
- Basque Cultural Center

JENNIFER MCENTEE
Director
Office/Investment Specialist
+1 208 287 9495
jennifer.mcentee@paccra.com

BREE WELLS
Senior Associate
Office Specialist
+1 208 287 9492
bree.wells@paccra.com

DJ THOMPSON
Director
Office/Investment Specialist
+1 208 287 8438
dj.thompson@paccra.com

999 W Main Street, Ste 1300
Boise, Idaho 83702
Main +1 208 287 9500
Fax +1 208 287 9501
paccra.com

THE EAGLES CENTER BLDG.

223 North 6th Street, Boise, Idaho 83702

FOR LEASE - 228 TO 643 SF



LOCATION AERIAL

