

**AVISON
YOUNG**

FLEX/INDUSTRIAL AVAILABLE FOR LEASE

SOUTHWEST SUNSET CORPORATE CENTER

6658, 6678, 6688, 6718, 6728, 6738 West Sunset Road
Las Vegas NV 89118



Located within the rapidly-growing 215 corridor, this prime property in the Southwest submarket will have six flex/industrial buildings ranging from 19,200 sf to 28,200 sf in size. The site is situated on Sunset Road and Rainbow Blvd. offering easy access to the 215 Beltway.

- Brand new industrial/office spec suites
- From 2,400 sf to 28,200 sf available for lease
- Concrete tilt-up construction
- Aluminum storefront windows
- Grade level loading (12' x 14')
- 18' clear height
- Power: 200A, 110/208V, 3-phase
- Sprinklers
- Professionally managed and maintained
- Zoned M-D (Clark County)

Partnership. Performance.

AVISON YOUNG
10845 Griffith Peak Drive, Suite 100
Las Vegas, NV 89135
O 702.472.7979 F 702.475.7545

OWNED BY **MARK IV** CAPITAL

CHRIS LEXIS
Principal
C 702.376.8500
chris.lexis@avisonyoung.com

JOE LEAVITT
Principal
C 702.303.7893
joe.leavitt@avisonyoung.com

SOUTHWEST SUNSET CORPORATE CENTER



10845 Griffith Peak Drive, Suite 100
Las Vegas, NV 89135
www.avisonyoung.com



Platinum member

CHRIS LEXIS

C 702.376.8500

chris.lexis@avisonyoung.com

License #: S.0062998.LLC

JOE LEAVITT

C 702.303.7893

joe.leavitt@avisonyoung.com

License #: S.0062543.LLC

The information contained herein was obtained from sources deemed reliable; however, Avison Young makes no guarantees or representations as to the accuracy thereof. The presentation of this property is submitted subject to errors, changes of price or conditions prior to sale or lease, or withdrawal of notice.

SOUTHWEST SUNSET CORPORATE CENTER

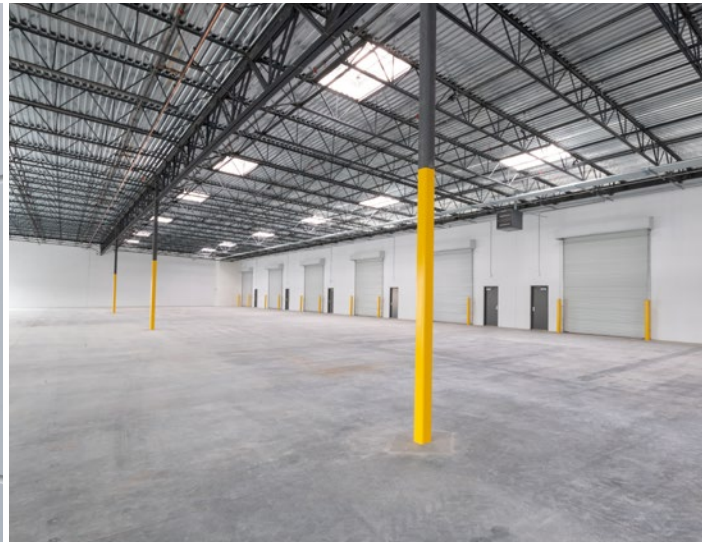

**AVISON
YOUNG**

10845 Griffith Peak Drive, Suite 100
Las Vegas, NV 89135
www.avisonyoung.com

**THE BEST
MANAGED
COMPANIES**

Platinum
member

CHRIS LEXIS

C 702.376.8500

chris.lexis@avisonyoung.com

License #: S.0062998.LLC

JOE LEAVITT

C 702.303.7893

joe.leavitt@avisonyoung.com

License #: S.0062543.LLC

The information contained herein was obtained from sources deemed reliable; however, Avison Young makes no guarantees or representations as to the accuracy thereof. The presentation of this property is submitted subject to errors, changes of price or conditions prior to sale or lease, or withdrawal of notice.

SOUTHWEST SUNSET CORPORATE CENTER

6738 W Sunset Road • Las Vegas • NV 89118

Building A	Suite	Available SF	Office SF	Warehouse SF	Grade Level Loading	Lease Rate \$/sf	NNN \$/sf
6738	150	±4,321	2,125	2,196	2 (12' x 14')	\$1.55	\$0.19*

* NNN expenses for 2020 only. Subject to change.

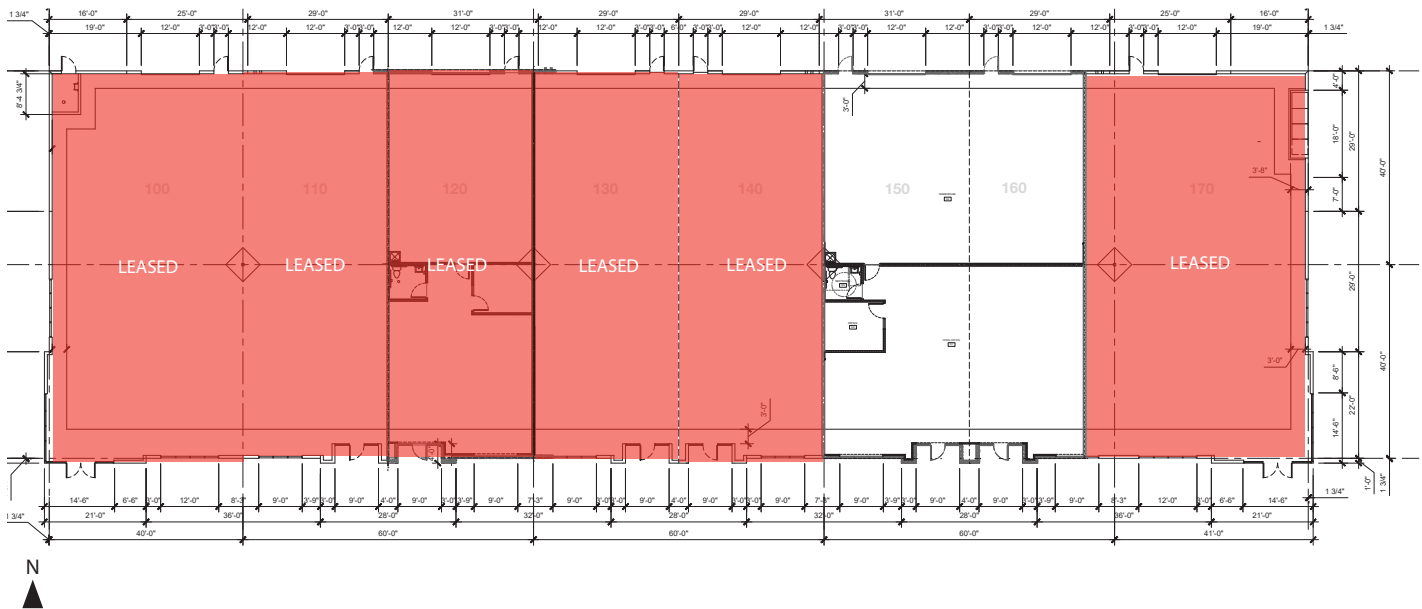

BUILDING FEATURES

- ±20,970 total sf
- Build to suit
- Concrete tilt-up construction
- Aluminum storefront windows
- Grade level loading (12' x 14')
- 18' clear height
- Power: 200A, 110/208V, 3-phase
- Sprinklers
- Parking ratio: 2.5/1,000 sf



10845 Griffith Peak Drive, Suite 100
Las Vegas, NV 89135
www.avisonyoung.com



Platinum member

CHRIS LEXIS

C 702.376.8500

chris.lexis@avisonyoung.com

License #: S.0062998.LLC

JOE LEAVITT

C 702.303.7893

joe.leavitt@avisonyoung.com

License #: S.0062543.LLC

The information contained herein was obtained from sources deemed reliable; however, Avison Young makes no guarantees or representations as to the accuracy thereof. The presentation of this property is submitted subject to errors, changes of price or conditions prior to sale or lease, or withdrawal of notice.

SOUTHWEST SUNSET CORPORATE CENTER

6728 W Sunset Road • Las Vegas • NV 89118

Building C	Suite	Available SF	Office SF	Warehouse SF	Grade Level Loading	Lease Rate \$/sf	NNN \$/sf
6728	100	±2,745	843	1,902	1 (12' x 14')	\$1.35	\$0.19*
6728	110	±2,820	927	1,893	1 (12' x 14')	\$1.30	\$0.19*
6728	120	±2,820	749	2,071	1 (12' x 14')	\$1.28	\$0.19*
6728	130	±2,820	749	2,071	1 (12' x 14')	\$1.28	\$0.19*
6728	140-150	±5,640	757	4,883	2 (12' x 14')	\$1.17	\$0.19*
6728	160	±2,800	BTS	BTS	1 (12' x 14')	Call for rate	\$0.19*
6728	170	±2,800	BTS	BTS	1 (12' x 14')	Call for rate	\$0.19*
6728	180	±2,800	BTS	BTS	1 (12' x 14')	Call for rate	\$0.19*
6728	190	±2,800	BTS	BTS	1 (12' x 14')	Call for rate	\$0.19*

* NNN expenses for 2020 only. Subject to change.

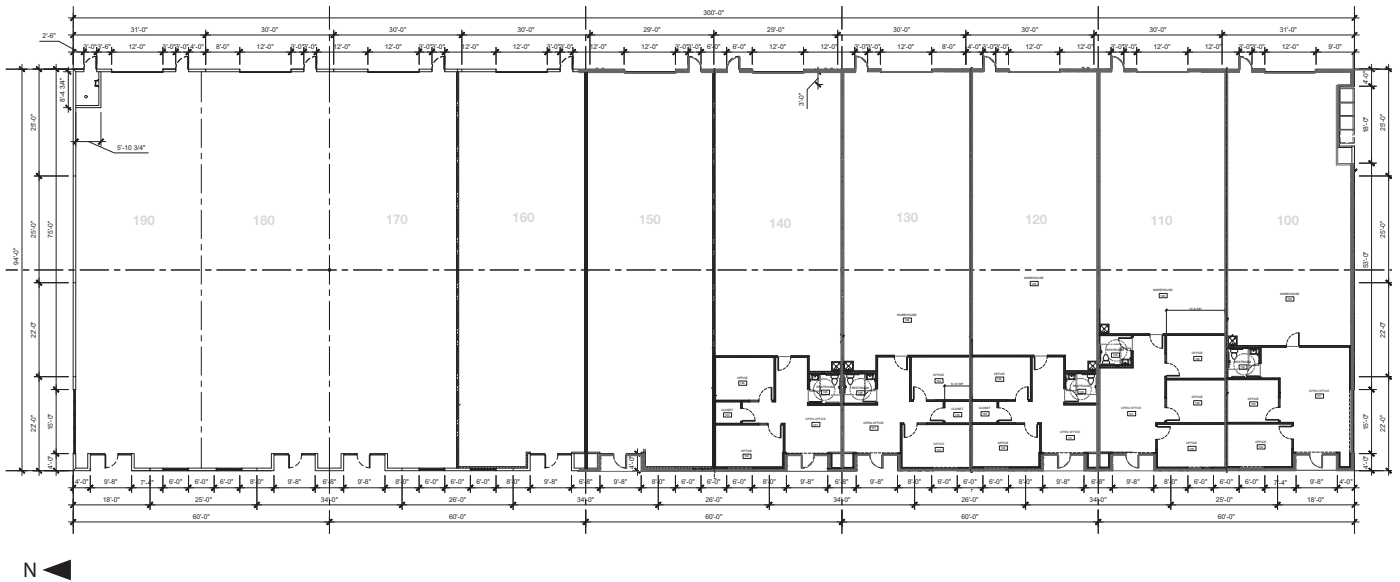

BUILDING FEATURES

- ±28,200 total sf
- Concrete tilt-up construction
- Aluminum storefront windows
- Grade level loading (12' x 14')
- 18' clear height
- Power: 200A, 110/208V, 3-phase
- Sprinklers
- Parking ratio: 2.5/1,000 sf



10845 Griffith Peak Drive, Suite 100
Las Vegas, NV 89135
www.avisonyoung.com



Platinum member

CHRIS LEXIS

C 702.376.8500

chris.lexis@avisonyoung.com

License #: S.0062998.LLC

JOE LEAVITT

C 702.303.7893

joe.leavitt@avisonyoung.com

License #: S.0062543.LLC

The information contained herein was obtained from sources deemed reliable; however, Avison Young makes no guarantees or representations as to the accuracy thereof. The presentation of this property is submitted subject to errors, changes of price or conditions prior to sale or lease, or withdrawal of notice.

SOUTHWEST SUNSET CORPORATE CENTER

6718 W Sunset Road • Las Vegas • NV 89118

Building D	Suite	Available SF	Office SF	Warehouse SF	Grade Level Loading	Lease Rate \$/sf	NNN \$/sf
6718	110	±2,700	±927	±1,773	1 (12' x 14')	\$1.31	\$0.19*
6718	120	±2,700	±749	±1,951	1 (12' x 14')	\$1.29	\$0.19*
6718	130	±2,700	±749	±1,951	1 (12' x 14')	\$1.29	\$0.19*
6718	140/150	±5,400	±749	±4,651	2 (12' x 14')	\$1.17	\$0.19*
6718	160	±2,700	±660	±2,040	2 (12' x 14')	\$1.27	\$0.19*

* NNN expenses for 2020 only. Subject to change.

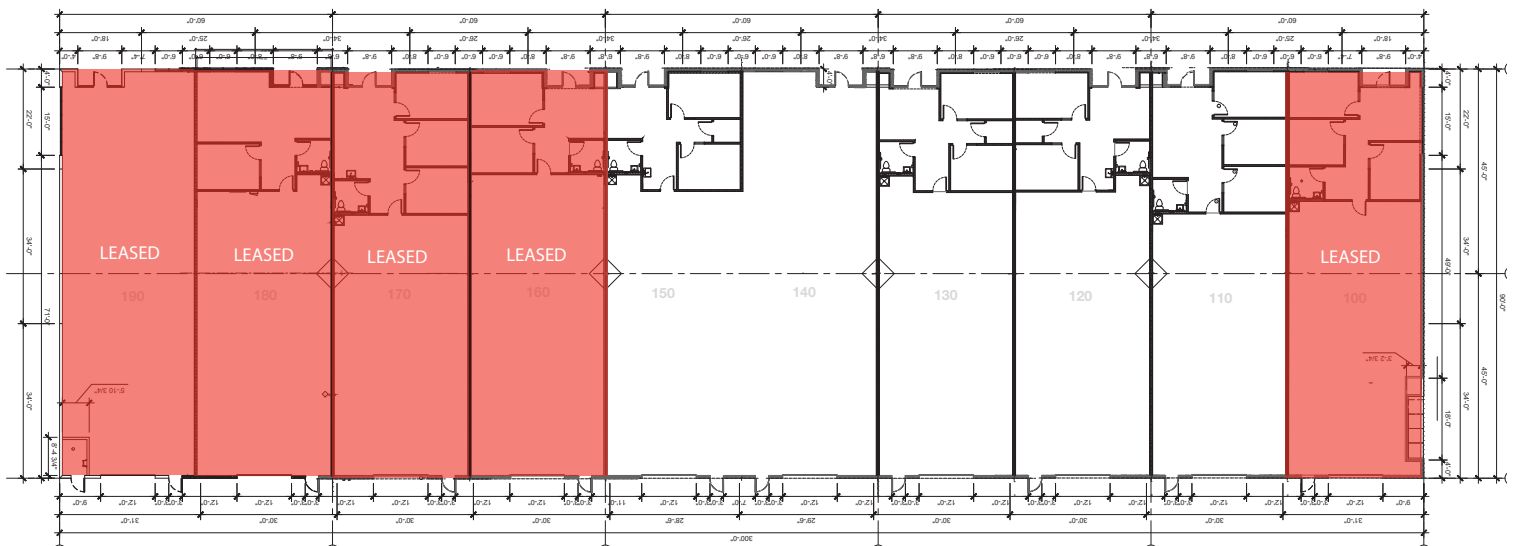

BUILDING FEATURES

- ±27,000 total sf
- Concrete tilt-up construction
- Aluminum storefront windows
- Grade level loading (12' x 14')
- 18' clear height
- Power: 200A, 110/208V, 3-phase
- Sprinklers
- Parking ratio: 2.5/1,000 sf

**AVISON
YOUNG**

10845 Griffith Peak Drive, Suite 100
Las Vegas, NV 89135
www.avisonyoung.com

**BEST
MANAGED
COMPANIES**

Platinum
member

CHRIS LEXIS

C 702.376.8500

chris.lexis@avisonyoung.com

License #: S.0062998.LLC

JOE LEAVITT

C 702.303.7893

joe.leavitt@avisonyoung.com

License #: S.0062543.LLC

The information contained herein was obtained from sources deemed reliable; however, Avison Young makes no guarantees or representations as to the accuracy thereof. The presentation of this property is submitted subject to errors, changes of price or conditions prior to sale or lease, or withdrawal of notice.

SOUTHWEST SUNSET CORPORATE CENTER

6688 W Sunset Road • Las Vegas • NV 89118

Building E	Suite	Available SF	Office SF	Warehouse SF	Grade Level Loading	Lease Rate \$/sf	NNN \$/sf
6688	110	±2,400	±660	±1,740	1 (12' x 14')	\$1.26	\$0.19*
6688	140	±4,800**	±720	±4,080	2 (12' x 14')	\$1.10	\$0.19*

* NNN expenses for 2020 only. Subject to change.

** Units may be divided into 2,400 sf single suites. Lease rate subject to change



BUILDING FEATURES

- ±24,000 total sf
- Concrete tilt-up construction
- Aluminum storefront windows
- Grade level loading (12' x 14')
- 18' clear height
- Power: 200A, 110/208V, 3-phase
- Sprinklers
- Parking ratio: 2.5/1,000 sf



10845 Griffith Peak Drive, Suite 100
Las Vegas, NV 89135
www.avisonyoung.com



Platinum member

CHRIS LEXIS

C 702.376.8500

chris.lexis@avisonyoung.com

License #: S.0062998.LLC

JOE LEAVITT

C 702.303.7893

joe.leavitt@avisonyoung.com

License #: S.0062543.LLC

The information contained herein was obtained from sources deemed reliable; however, Avison Young makes no guarantees or representations as to the accuracy thereof. The presentation of this property is submitted subject to errors, changes of price or conditions prior to sale or lease, or withdrawal of notice.

SOUTHWEST SUNSET CORPORATE CENTER

6678 W Sunset Road • Las Vegas • NV 89118

Building F	Suite	Available SF	Office SF	Warehouse SF	Grade Level Loading	Lease Rate \$/sf	NNN \$/sf
6678	100-120	±8,025	1,014	7,011	3 (12' x 14')	\$1.15	\$0.19*

* NNN expenses for 2020 only. Subject to change.

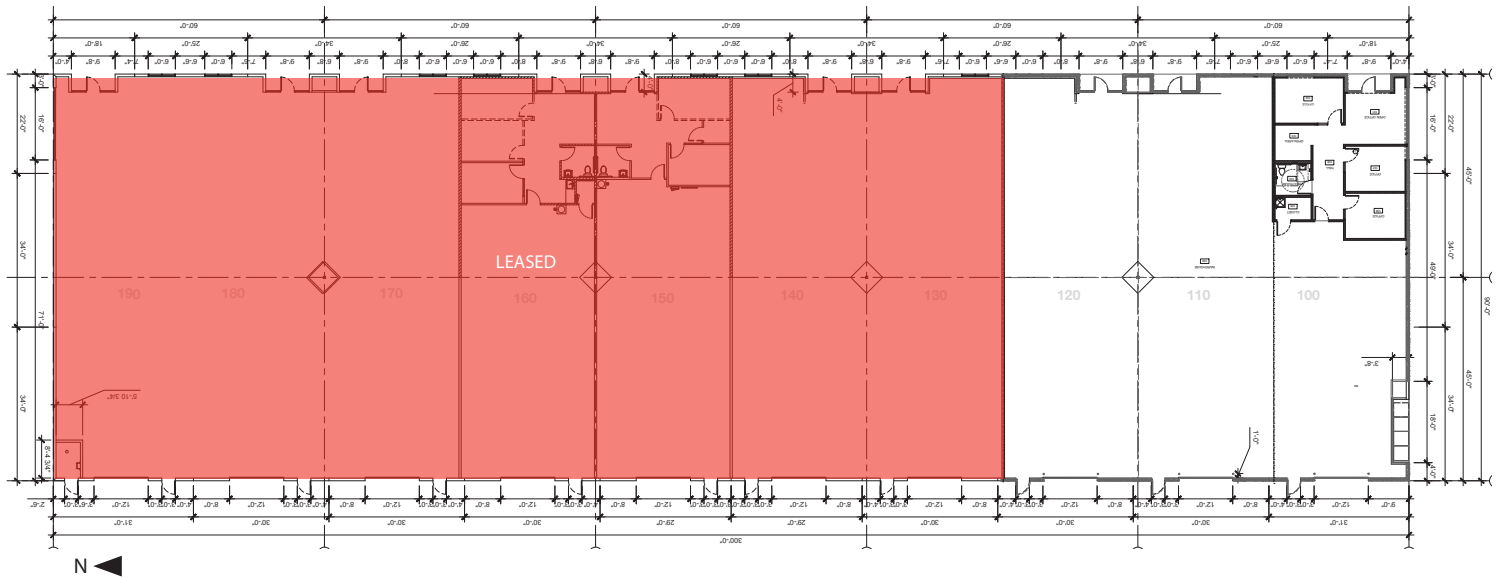

BUILDING FEATURES

- ±27,000 total sf
- Concrete tilt-up construction
- Aluminum storefront windows
- Grade level loading (12' x 14')
- 18' clear height
- Power: 200A, 110/208V, 3-phase
- Sprinklers
- Parking ratio: 2.5/1,000 sf



10845 Griffith Peak Drive, Suite 100
Las Vegas, NV 89135
www.avisonyoung.com



Platinum member

CHRIS LEXIS

C 702.376.8500

chris.lexis@avisonyoung.com

License #: S.0062998.LLC

JOE LEAVITT

C 702.303.7893

joe.leavitt@avisonyoung.com

License #: S.0062543.LLC

The information contained herein was obtained from sources deemed reliable; however, Avison Young makes no guarantees or representations as to the accuracy thereof. The presentation of this property is submitted subject to errors, changes of price or conditions prior to sale or lease, or withdrawal of notice.

SOUTHWEST SUNSET CORPORATE CENTER



10845 Griffith Peak Drive, Suite 100
Las Vegas, NV 89135
www.avisonyoung.com



Platinum member

CHRIS LEXIS

C 702.376.8500

chris.lexis@avisonyoung.com

License #: S.0062998.LLC

JOE LEAVITT

C 702.303.7893

joe.leavitt@avisonyoung.com

License #: S.0062543.LLC

The information contained herein was obtained from sources deemed reliable; however, Avison Young makes no guarantees or representations as to the accuracy thereof. The presentation of this property is submitted subject to errors, changes of price or conditions prior to sale or lease, or withdrawal of notice.