

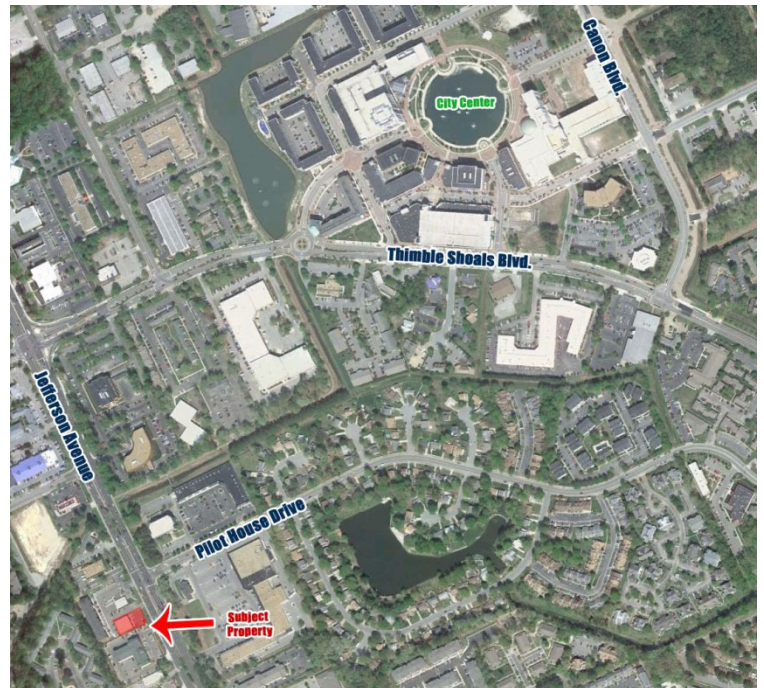

### Property Features

- 2,597 SF available
- \$15.95/SF, Net of utilities & janitorial
- Office & cubicle area layout available
- Jefferson Ave. exposure
- Great signage opportunity on building exterior
- Generous parking



For more information, contact:

**TERESA NETTLES**  
Senior Vice President  
757 873 9268  
[teresa.nettles@thalhimer.com](mailto:teresa.nettles@thalhimer.com)

One BayPort Way, Suite 100  
Newport News, VA 23606  
[www.thalhimer.com](http://www.thalhimer.com)

5,200 SF

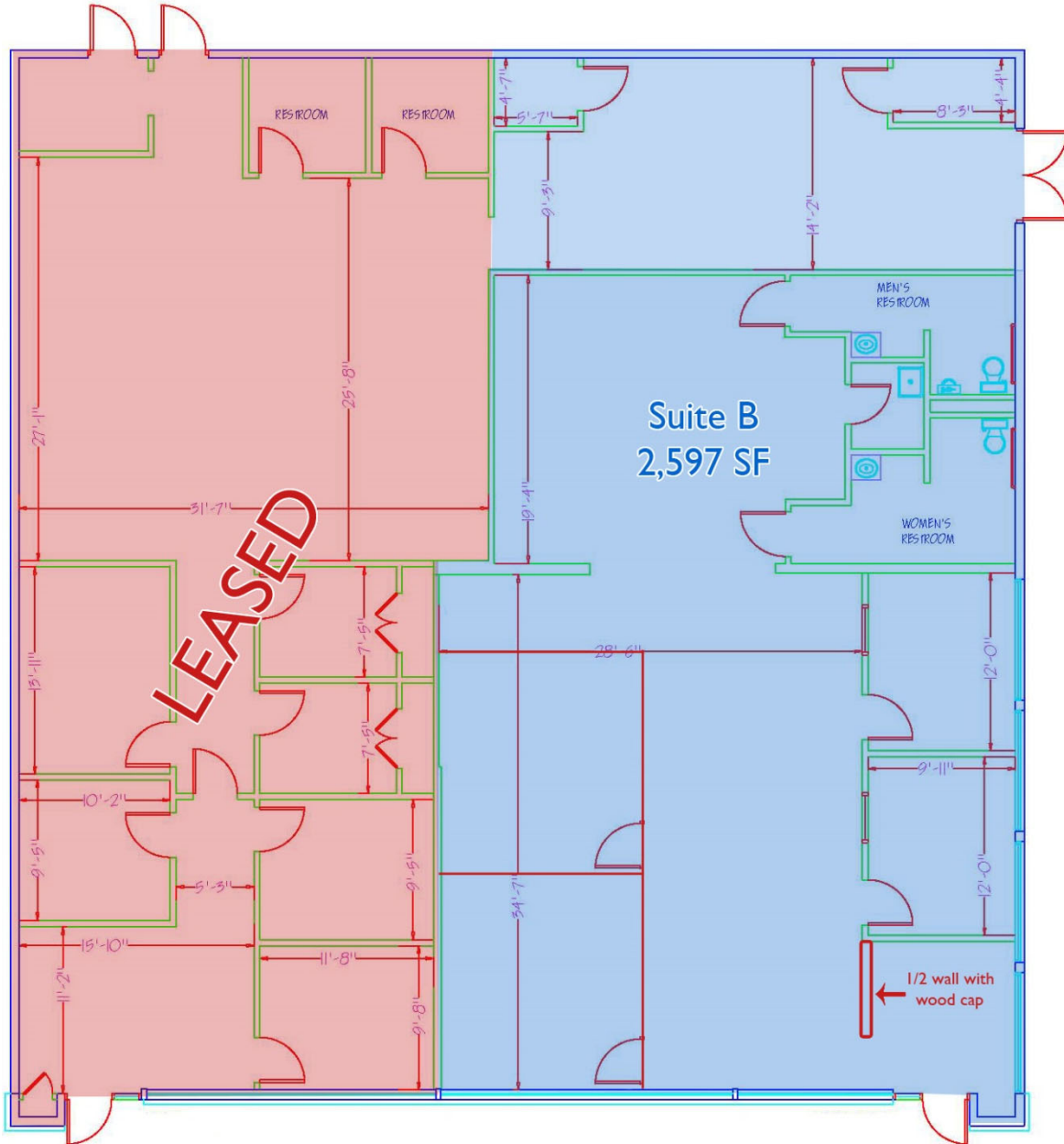

11717 JEFFERSON AVENUE  
EXISTING FLOOR PLAN  
SCALE: N.T.S. DATE: 10/31/14  
DRAWN BY: K.L. MONETTE 214.1345

For more information, contact:

**TERESA NETTLES**  
Senior Vice President  
757 873 9268  
[teresa.nettles@thalhimer.com](mailto:teresa.nettles@thalhimer.com)

One BayPort Way, Suite 100  
Newport News, VA 23606  
[www.thalhimer.com](http://www.thalhimer.com)