

# SEAWAY RIDGE BUILDING

1930 Merrill Creek Parkway, Everett, WA 98203



## PROPERTY FEATURES

- 13,900 - 23,900 SF total, including  $\pm$ 500 SF office
- Unique opportunity for Northend office space in the heart of Seaway Center
- Flexible configuration
- Dock and grade level loading
- Excellent access to Boeing, SR 526 and I-5
- Local responsive ownership
- Available immediately
- Lease Rate: Office: \$1.45/RSF/Month, Warehouse: \$0.75/RSF/Month

## SPACE PLAN

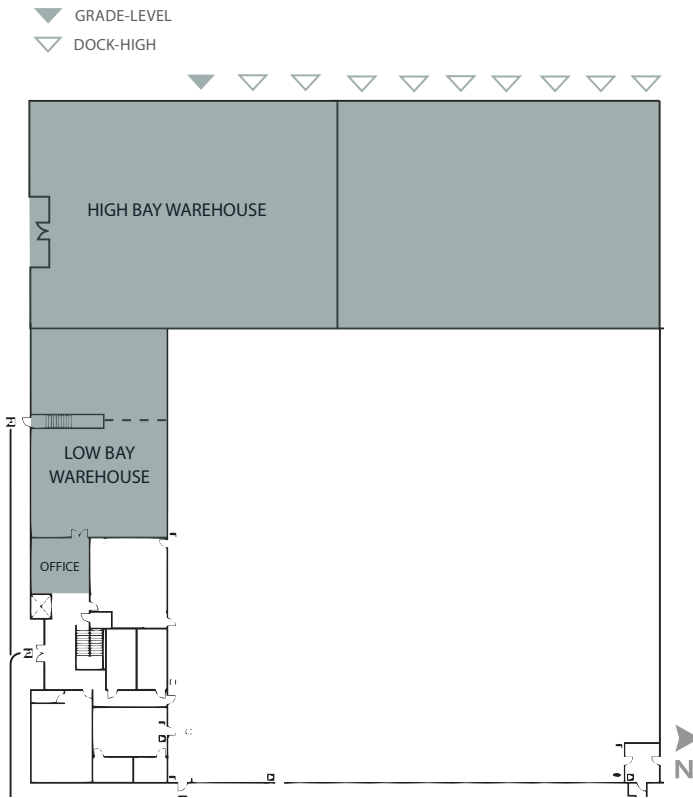

## LOCATION AERIAL

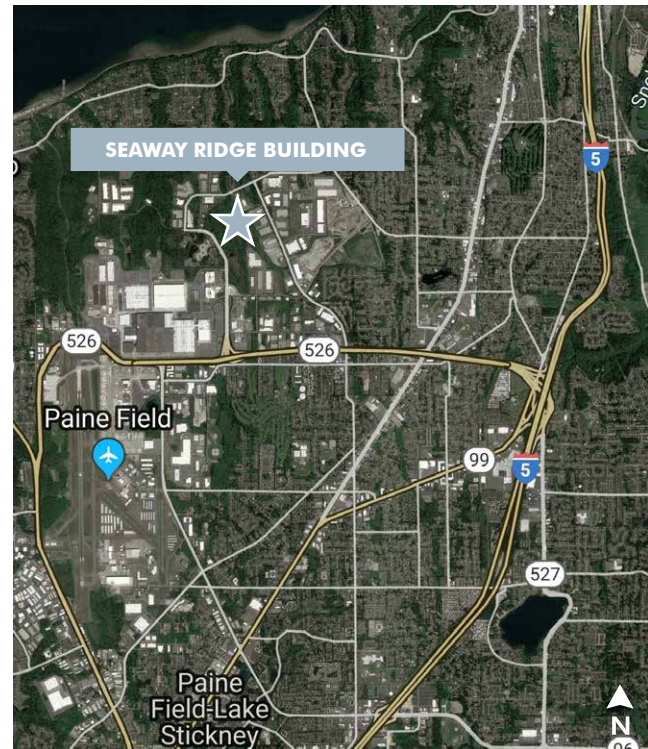

### PLEASE CONTACT:

#### Ric Brandt

Senior Vice President  
+1 425 462 6901  
ric.brandt@cbre.com

#### John Bauer

Senior Vice President  
+1 425 462 6906  
john.bauer@cbre.com

#### Erik Larson

Vice President  
+1 425 462 6954  
erik.larson@cbre.com

#### CBRE, Inc.

929 108th Avenue NE  
Suite 700  
Bellevue, WA. 98004

© 2020 CBRE, Inc. All rights reserved. This information has been obtained from sources believed reliable, but has not been verified for accuracy or completeness. You should conduct a careful, independent investigation of the property and verify all information. Any reliance on this information is solely at your own risk. CBRE and the CBRE logo are service marks of CBRE, Inc. All other marks displayed on this document are the property of their respective owners, and the use of such logos does not imply any affiliation with or endorsement of CBRE. Photos herein are the property of their respective owners. Use of these images without the express written consent of the owner is prohibited. AM 1-22-2020

1930 Merrill Creek Parkway, Everett, WA 98203