

PERRIS COMMERCE CENTER

FOR LEASE 4 BUILDINGS TOTALING ±61,720 SF

DEVELOPED BY:

BURGE
CORPORATION



Please Contact:

LEE & ASSOCIATES
COMMERCIAL REAL ESTATE SERVICES

R. MARIO CALVILLO
DRE#: 01911573 | 951.276.3657
MCALVILLO@LEERIVERSIDE.COM

GARRY JENKINS
DRE#: 02008115 | 951.276.3621
GJENKINS@LEERIVERSIDE.COM

No warranty or representation has been made to the accuracy of the foregoing information. Terms of sale or lease and availability are subject to change or withdrawal without notice. Lee & Associates Commercial Real Estate Services, Inc. - Riverside. 3240 Mission Inn Avenue, Riverside, CA 92507 | Corporate DRE#: 01048055

PERRIS COMMERCE CENTER

FOR LEASE 4 BUILDINGS TOTALING ±61,720 SF

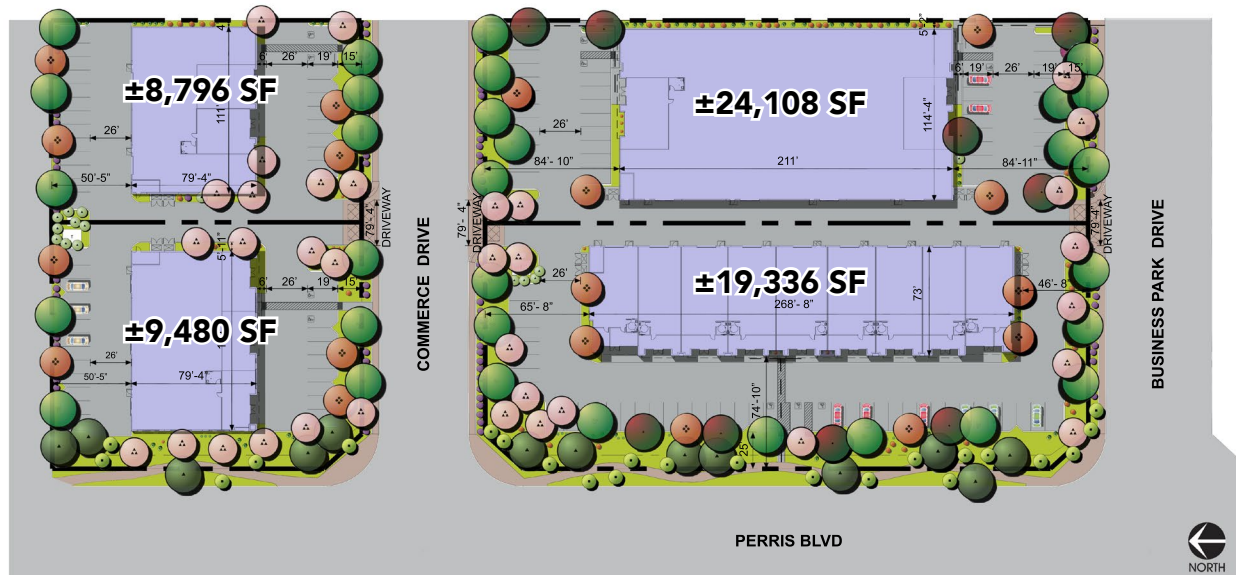

PROPERTY FEATURES

BUILDING #	1	2	3	4
BUILDING SF	±24,108	±19,336	±8,796	±9,480
UNIT SF	±12,054 to 24,108	±1,990 to 19,336	±4,398 to 8,798	±3,106 to 9,480
ACRES	1.22	1.37	0.60	0.73
OFFICE SF	TBD	TBD	TBD	TBD
CLEAR HEIGHT	24'	18'	18'	18'
ESFR SPRINKLERS	K-25	K-25	K-25	K-25
POWER	800 Amps, 3 Phase	200 Amps, 3 Phase Per Unit	200 Amps, 3 Phase Per Unit	200 Amps, 3 Phase Per Unit
ASSOCIATION	Yes	Yes	Yes	Yes

Please Contact:



R. MARIO CALVILLO
 DRE#: 01911573 | 951.276.3657
 MCALEVILLO@LEERIVERSIDE.COM

GARRY JENKINS
 DRE#: 02008115 | 951.276.3621
 GJENKINS@LEERIVERSIDE.COM

PERRIS COMMERCE CENTER

FOR LEASE 4 BUILDINGS TOTALING ±61,720 SF

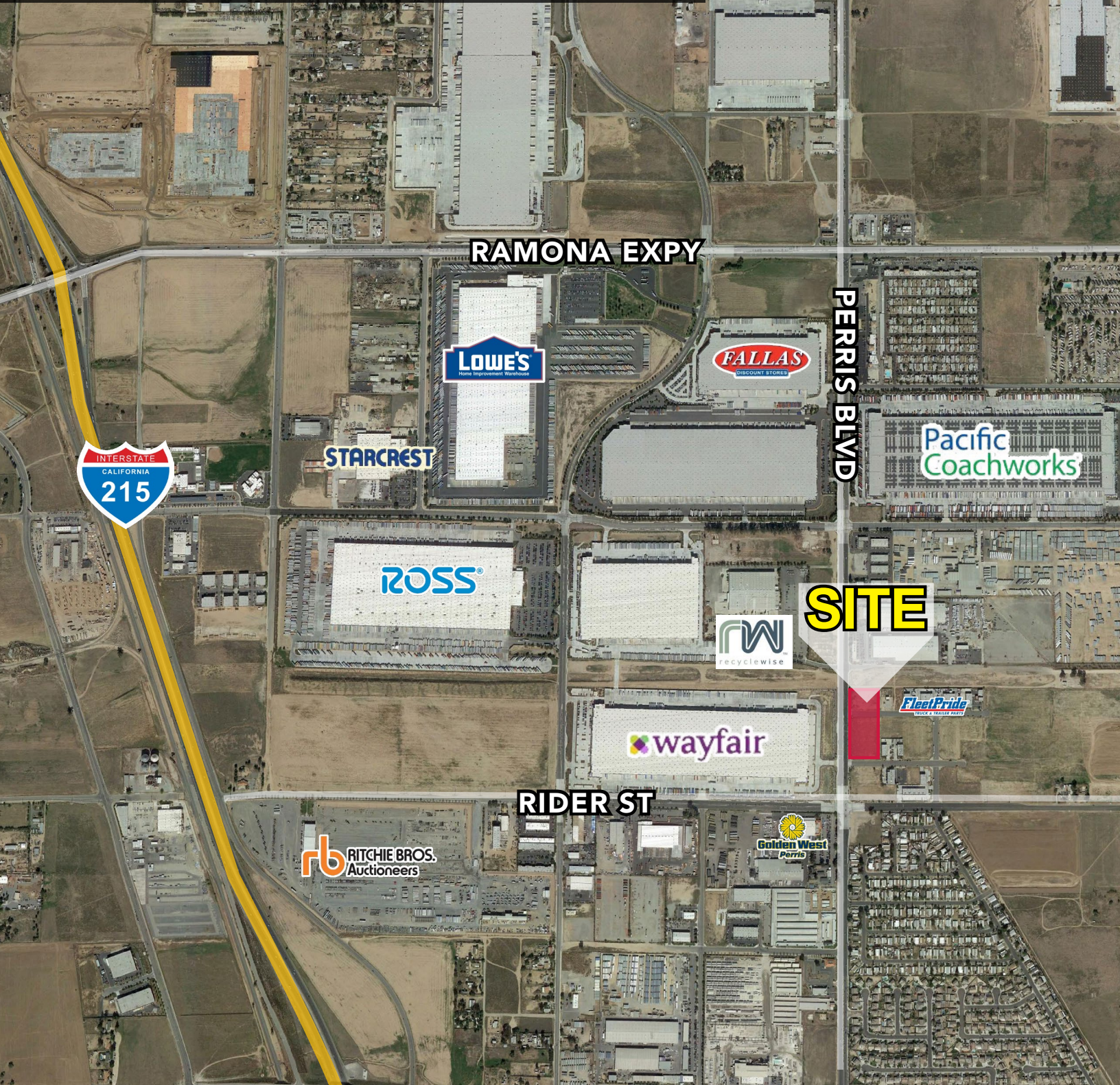

Please Contact:

LEE & ASSOCIATES
COMMERCIAL REAL ESTATE SERVICES

R. MARIO CALVILLO
DRE#: 01911573 | 951.276.3657
MCALVILLO@LEERIVERSIDE.COM

GARRY JENKINS
DRE#: 02008115 | 951.276.3621
GJENKINS@LEERIVERSIDE.COM

No warranty or representation has been made to the accuracy of the foregoing information. Terms of sale or lease and availability are subject to change or withdrawal without notice. Lee & Associates Commercial Real Estate Services, Inc. - Riverside. 3240 Mission Inn Avenue, Riverside, CA 92507 | Corporate DRE#: 01048055