

384 KNICKERBOCKER AVENUE

CORNER OF KNICKERBOCKER & STANHOPE STREET | BUSHWICK



384 KNICKERBOCKER AVENUE

CORNER OF KNICKERBOCKER & STANHOPE STREET | BUSHWICK

SIZE

Ground Floor **2,500 SF**
Lower Level **1,632 SF**

FRONTAGE

27' (Knickerbocker) & 65' (Stanhope)

CEILING HEIGHT

11' (back of the store has 20 ft ceilings)

ASKING RENT

Upon Request

POSSESSION

Immediate

TRANSPORTATION



COMMENTS

- Newly Renovated Building
- New HVAC
- High ceilings
- Tremendous foot traffic on a prominent retail corridor
- Venting and food is allowed
- Multiple new residential developments in the area

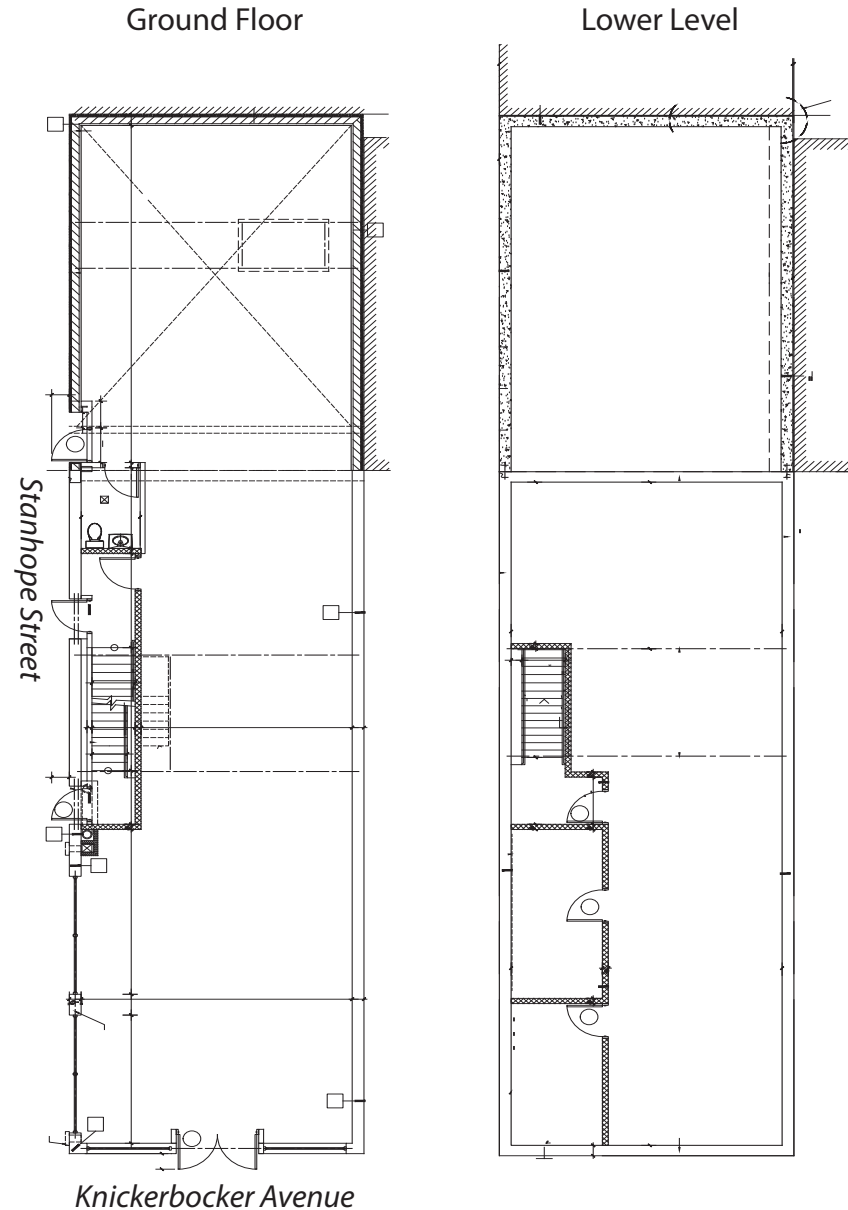

384 KNICKERBOCKER AVENUE

CORNER OF KNICKERBOCKER & STANHOPE STREET | BUSHWICK



NEIGHBORS



CONTACT OUR BROKER(S) FOR MORE INFORMATION



KASSIN SABBAGH REALTY
1385 Broadway 22nd floor
New York, NY 10018
(212) 417 - 9217
www.ksrny.com

AVI GARMA
AGarma@ksrny.com

347.935.0216

All information supplied in this marketing presentation and/or flyer is from sources deemed reliable and is furnished subject to errors, omissions, modifications, removal of listings from sale/lease and to any listing conditions. Any square footage, dimensions, floor plans and/or technical data set forth are approximations and are subject to further elaboration/confirmation.