

LAND FOR SALE - 23± ACRES
38°09'53.7"N 85°38'14.1"W

PROPERTY FEATURES

- 23± acres zoned PEC (may divide)
- Centrally located with great access to I-65
- Close proximity to GE, Ford, and UPS Worldport
- Hurstbourne Pkwy. daily traffic count of 17,300
- Fegenbush Lane daily traffic count of 12,000
- Full ingress/egress: “right in, right out” and “left in, left out” from Hurstbourne Pkwy.



For more information, please contact:

ROBERT B. WALKER, SIOR, CCIM
Senior Director
Certified Supply Chain Professional
502 589 5150 ext. 254
rwalker@commercialkentucky.com

JAKE MILLS
Associate
502 719 3252
jmills@commercialkentucky.com

333 E. Main Street, Suite 510
Louisville, KY 40202
phone: +1 502 589 5150
www.commercialkentucky.com



Aerial

For more information, please contact:

ROBERT B. WALKER, SIOR, CCIM
Senior Director
Certified Supply Chain Professional
502 589 5150 ext. 254
rwalker@commercialkentucky.com

JAKE MILLS
Associate
502 719 3252
jmills@commercialkentucky.com

333 E. Main Street, Suite 510
Louisville, KY 40202
phone: +1 502 589 5150
www.commercialkentucky.com

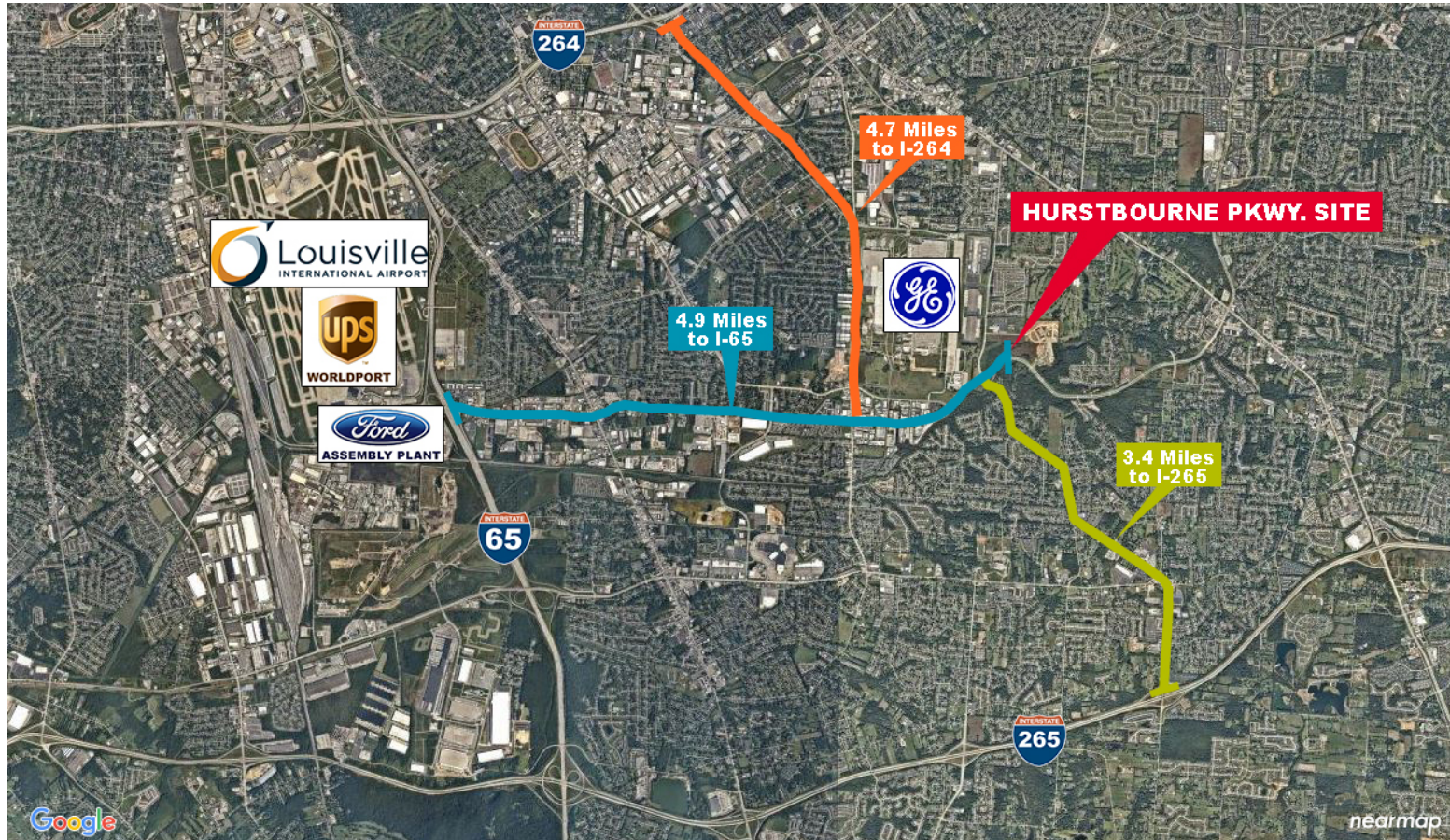

Drive Distance Map

For more information, please contact:

ROBERT B. WALKER, SIOR, CCIM
Senior Director
Certified Supply Chain Professional
502 589 5150 ext. 254
rwalker@commercialkentucky.com

JAKE MILLS
Associate
502 719 3252
jmills@commercialkentucky.com

333 E. Main Street, Suite 510
Louisville, KY 40202
phone: +1 502 589 5150
www.commercialkentucky.com



**CUSHMAN &
WAKEFIELD**

Commercial Kentucky

FOR SALE

HURSTBOURNE PKWY. & FEGENBUSH LANE

Louisville, KY 40228

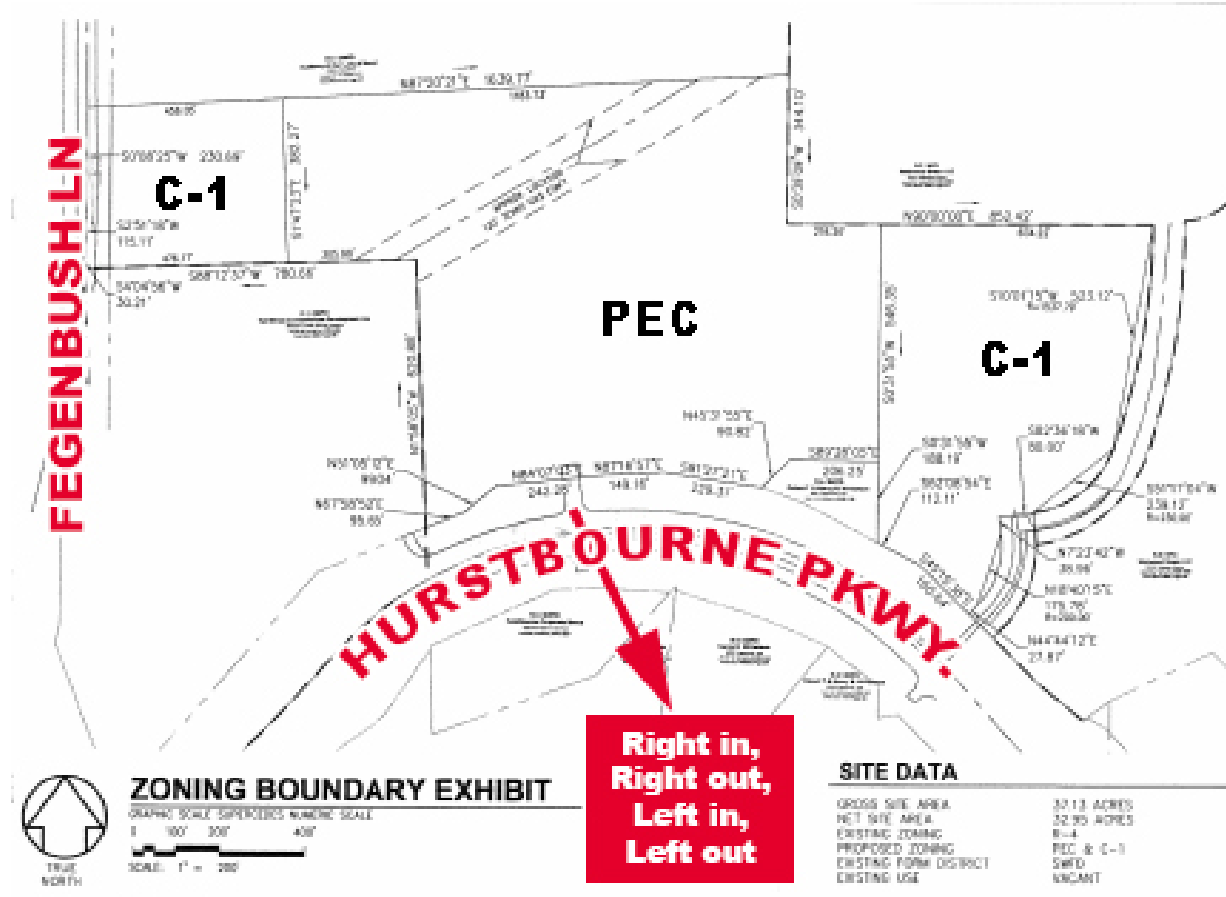

Zoning Boundary Exhibit

For more information, please contact:

ROBERT B. WALKER, SIOR, CCIM
Senior Director
Certified Supply Chain Professional
502 589 5150 ext. 254
rwalker@commercialkentucky.com

JAKE MILLS
Associate
502 719 3252
jmills@commercialkentucky.com

333 E. Main Street, Suite 510
Louisville, KY 40202
phone: +1 502 589 5150
www.commercialkentucky.com

Independently Owned and Operated / A Member of the Cushman & Wakefield Alliance
©2018 Cushman & Wakefield. All rights reserved. The information contained in this communication is strictly confidential. This information has been obtained from sources believed to be reliable but has not been verified. NO WARRANTY OR REPRESENTATION, EXPRESS OR IMPLIED, IS MADE AS TO THE CONDITION OF THE PROPERTY (OR PROPERTIES) REFERENCED HEREIN OR AS TO THE ACCURACY OR COMPLETENESS OF THE INFORMATION CONTAINED HEREIN, AND SAME IS SUBMITTED SUBJECT TO ERRORS, OMISSIONS, CHANGE OF PRICE, RENTAL OR OTHER CONDITIONS, WITHDRAWAL WITHOUT NOTICE, AND TO ANY SPECIAL LISTING CONDITIONS IMPOSED BY THE PROPERTY OWNER(S). ANY PROJECTIONS, OPINIONS OR ESTIMATES ARE SUBJECT TO UNCERTAINTY AND DO NOT SIGNIFY CURRENT OR FUTURE PROPERTY PERFORMANCE.