



T Ø M M E R



OFFICE SPACE FOR LEASE

5101 14TH AVE NW | SEATTLE, WA 98117

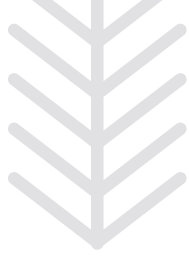

THE BUILDING

MODERN SCANDINAVIAN DESIGN

The four-story Tømmer Building will feature cedar cladding with a clean, Scandinavian aesthetic, heavy timber brick & beam construction, and flexible open floor plates.



EXPOSED 12'8" CEILINGS



SOLAR ARRAY



LARGE 9' WINDOWS
(INCLUDING OPERABLE)



±2,500 SF COMMUNAL
GREEN ROOFTOP DECK



±21,951 RSF

OFFICE SPACE

Q4 2020

DELIVERY

AVAILABILITY

FLOOR 3 9,302 RSF

FLOOR 2 9,299 RSF

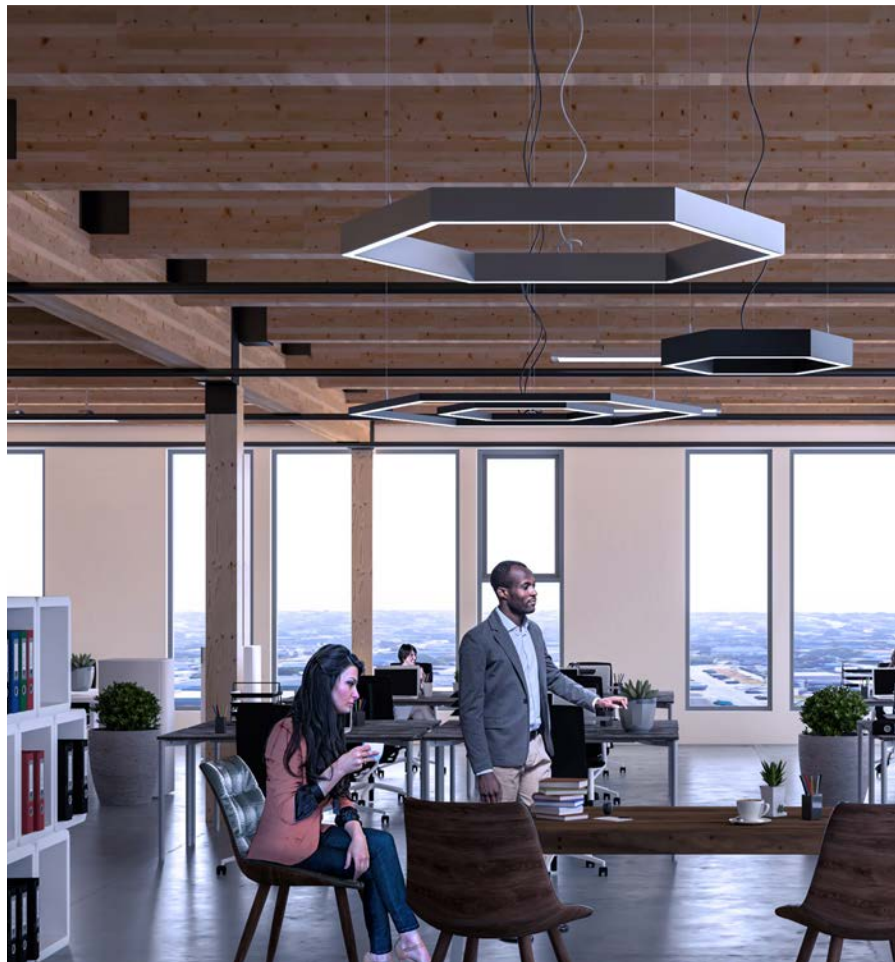



GROUND-FLOOR
RETAIL



15 PARKING
STALLS



BIKE
STORAGE

THE NEIGHBORHOOD

WORK IN ONE OF THE CITY'S MOST STORIED AND SOUGHT- AFTER NEIGHBORHOODS.

Ballard's prosperity first came from the timber and cedar mills located along the ship canal that leads to Lake Union. Today the neighborhood is known for the old Seattle Scandinavian + maritime culture and its mix of award-winning northwestern breweries, coffee shops, and restaurants.

Norwegian
for "timber,"
Tømmer is

DESIGNED
WITH ITS
ROOTS IN
MIND.



THE LOCATION

NEIGHBORHOOD AMENITIES

92
WALK SCORE

◆ Next door to 10 breweries and tap rooms, some of Seattle's classic quick breakfast stops, Trader Joe's, Amazon Fresh, New Seasons Market, and a host of retail and fitness options just a few blocks away on Market Street

83
BIKE SCORE

◆ Transit development: benefit from the Burke Gilman Missing Link trail connection and the future RapidRide Ballard - Fremont bus line and light rail station



■ RapidRide expansion ■ Missing Link connection



tommerbuilding.com



Tim Jones
+1 206 971 7011
tim.jones@am.jll.com

jll.com/seattle

DISCLAIMER © 2020 Jones Lang LaSalle IP, Inc. All rights reserved. All information contained herein is from sources deemed reliable; however, no representation or warranty is made to the accuracy thereof.