



**CUSHMAN &
WAKEFIELD**

FOR LEASE

16958 N. Freeway, Bldg. D

Houston, Texas 77090



- 2019 construction insulated 6,000 sq. ft. building
- Clear span: 100' x 600' on .46 acres
- Eave height: 24'
- Build-to-Suit office
- Grade level loading; two 12' x 14' OH doors
- Harris County permitting
- Located in 45 North Commerce Park
- 3 phase / 480 volt / 200 amps
- Monument signage available on I-45
- Lease Rate: Call Broker (may consider a sale)

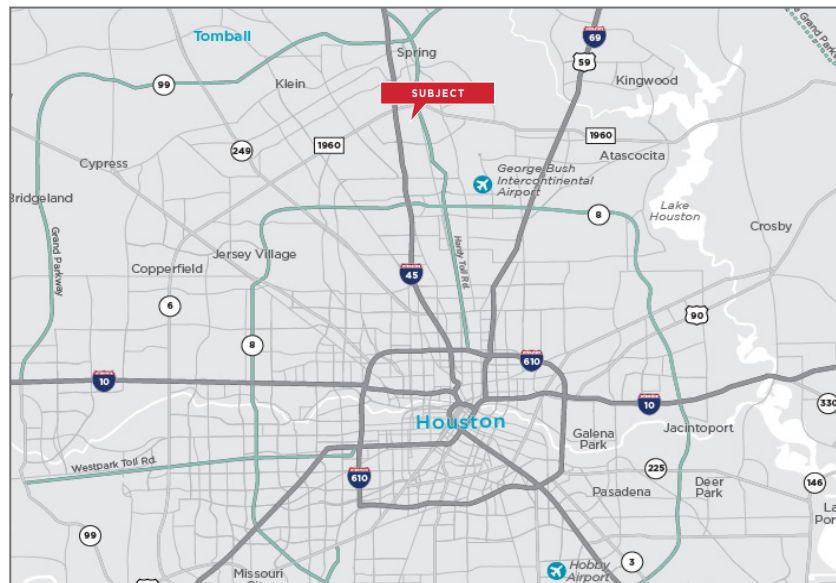

John F. Littman, SIOR
Executive Managing Director
+1 713 963 2862
john.littman@cushwake.com

Coe Parker, SIOR
Senior Director
+1 713 963 2825
coe.parker@cushwake.com

B. Kelley Parker III, SIOR
Vice Chairman
+1 713 963 2896
kelley.parker@cushwake.com

1330 Post Oak Lane, Suite 2700
Houston, Texas 77056
Main +1 713 877 1700
Fax +1 713 877 1965
cushmanwakefield.com



**CUSHMAN &
WAKEFIELD**

FOR LEASE

16958 N. Freeway, Bldg. D

Houston, Texas 77090



John F. Littman, SIOR
Executive Managing Director
+1 713 963 2862
john.littman@cushwake.com

Coe Parker, SIOR
Senior Director
+1 713 963 2825
coe.parker@cushwake.com

B. Kelley Parker III, SIOR
Vice Chairman
+1 713 963 2896
kelley.parker@cushwake.com

1330 Post Oak Lane, Suite 2700
Houston, Texas 77056
Main +1 713 877 1700
Fax +1 713 877 1965
cushmanwakefield.com



**CUSHMAN &
WAKEFIELD**

FOR LEASE

16958 N. Freeway, Bldg. D

Houston, Texas 77090

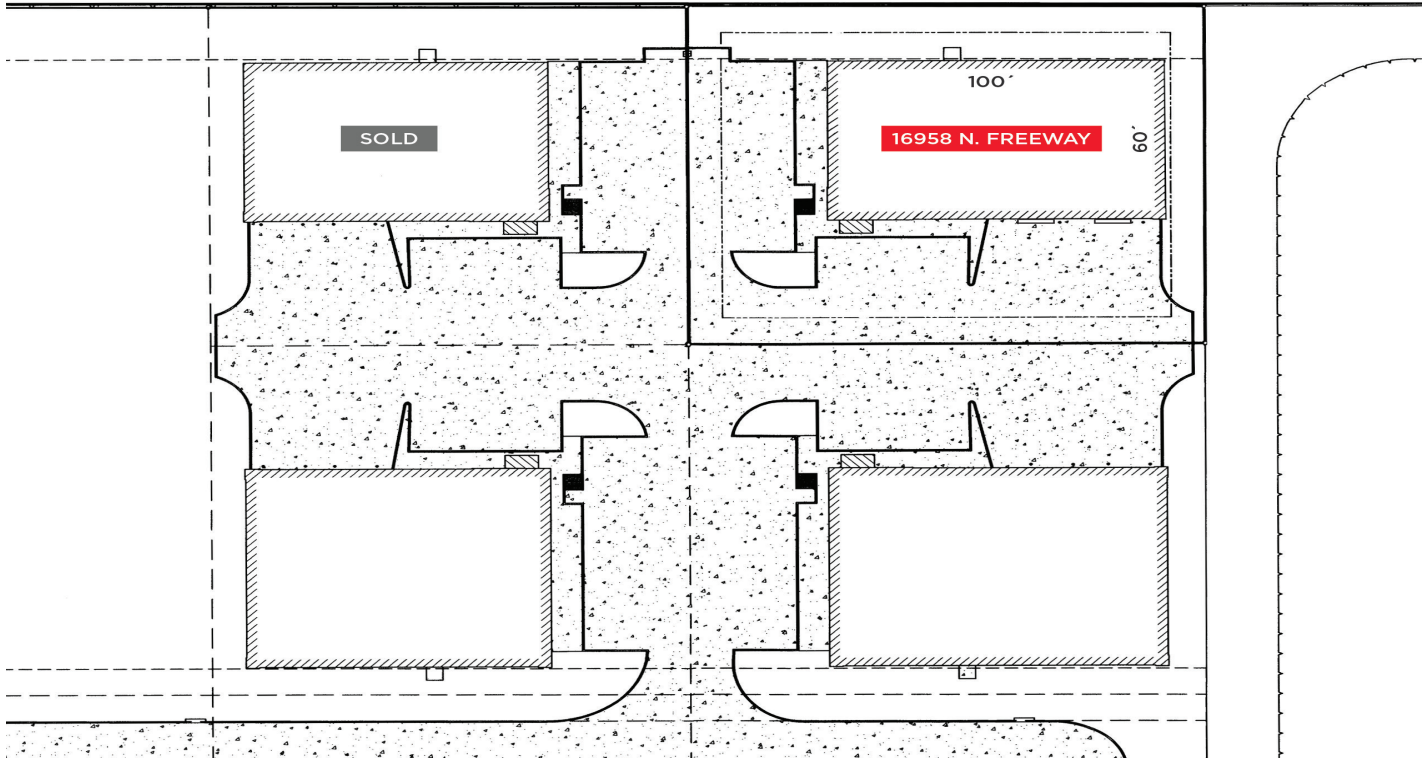

John F. Littman, SIOR
Executive Managing Director
+1 713 963 2862
john.littman@cushwake.com

Coe Parker, SIOR
Senior Director
+1 713 963 2825
coe.parker@cushwake.com

B. Kelley Parker III, SIOR
Vice Chairman
+1 713 963 2896
kelley.parker@cushwake.com

1330 Post Oak Lane, Suite 2700
Houston, Texas 77056
Main +1 713 877 1700
Fax +1 713 877 1965
cushmanwakefield.com