

75 Spring Street

SOHO
NEW YORK, NY

SOHO HISTORIC DISTRICT
Crosby St

NO STOPPING
Anytime
← →

NEWMARK

75 SPRING STREET

Property Details

Location

Northeast corner of Spring and Crosby Streets

Approximate Size

| | |
|--------------|----------|
| Ground Floor | 5,000 SF |
| Lower Level | 4,000 SF |
| Total | 9,000 SF |

Term

Long term

Frontage

45 FT on Spring Street
100 FT on Crosby Street

Ceiling Height

| | |
|--------------|------------|
| Ground Floor | 15 FT 6 IN |
| Lower Level | 12 FT 6 IN |

Possession

February 2023

Site Status

Currently Aerie

Neighbors

MoMA, Balthazar, Starbucks, Aritzia, Nike and Museum of Ice Cream

Ground Floor

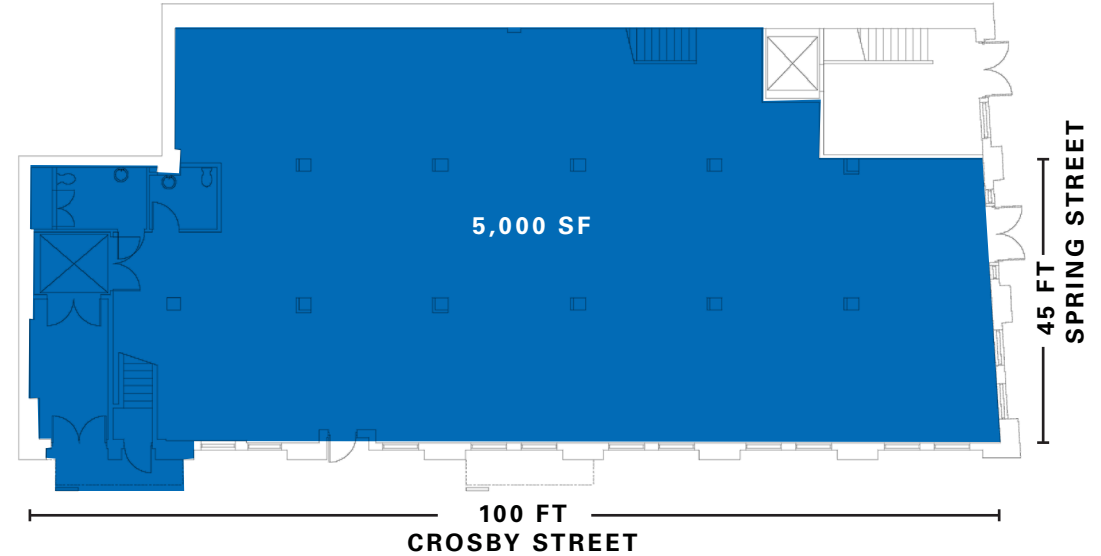

Lower Level

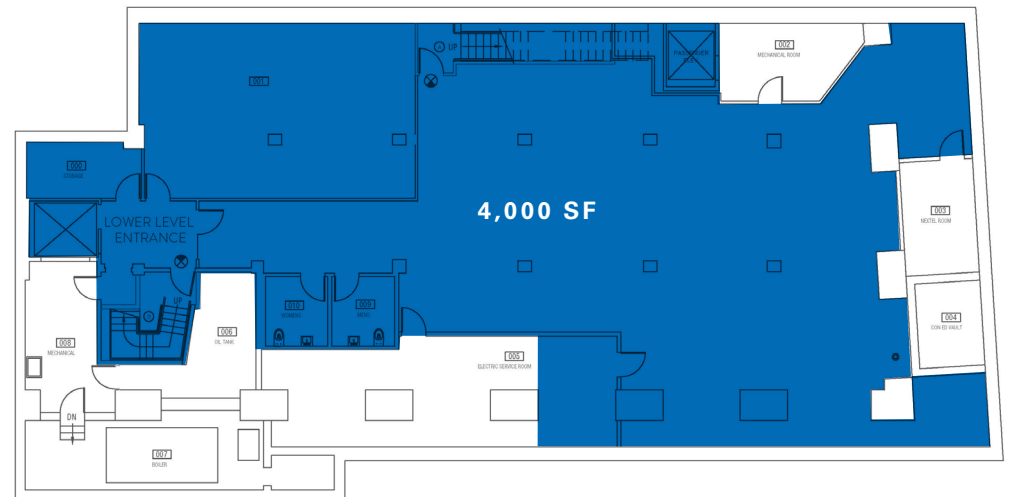

75 SPRING STREET



+ COMING SOON

CONTACT

Karen Bellantoni
 t 212-331-0116
 karen.bellantoni@nmrk.com

Jackie Totolo
 t 212-916-3392
 jackie.totolo@nmrk.com

nmrk.com

©2022 NEWMARK The information contained herein has been obtained from sources deemed reliable but has not been verified and no guarantee, warranty or representation, either express or implied, is made with respect to such information. Terms of sale or lease and availability are subject to change or withdrawal without notice.