



Peninsula Boardwalk

200 – 400 Walnut Street | Redwood City, California

NOW LEASING

<u>SPACE#</u>	<u>SF</u>	<u>RENT</u>	<u>NNN</u>
340 Walnut Street	4,292	Call	\$4.50

For information, contact:

Emily Murtha, CA BRE #01891284
emurtha@crosspointrealty.com

Thomas N. Klein, CA DRE #00840486
tklein@crosspointrealty.com

Phone: 415-288-6888
Fax: 415-288-6877

Crosspoint Realty Services, Inc.
303 Sacramento Street, 3rd Floor
San Francisco, CA 94111
www.crosspointrealty.com



SITE PLAN

Contact: Thomas N. Klein (CA BRE#00840486), tklein@crosspointrealty.com Phone 415.288.6888

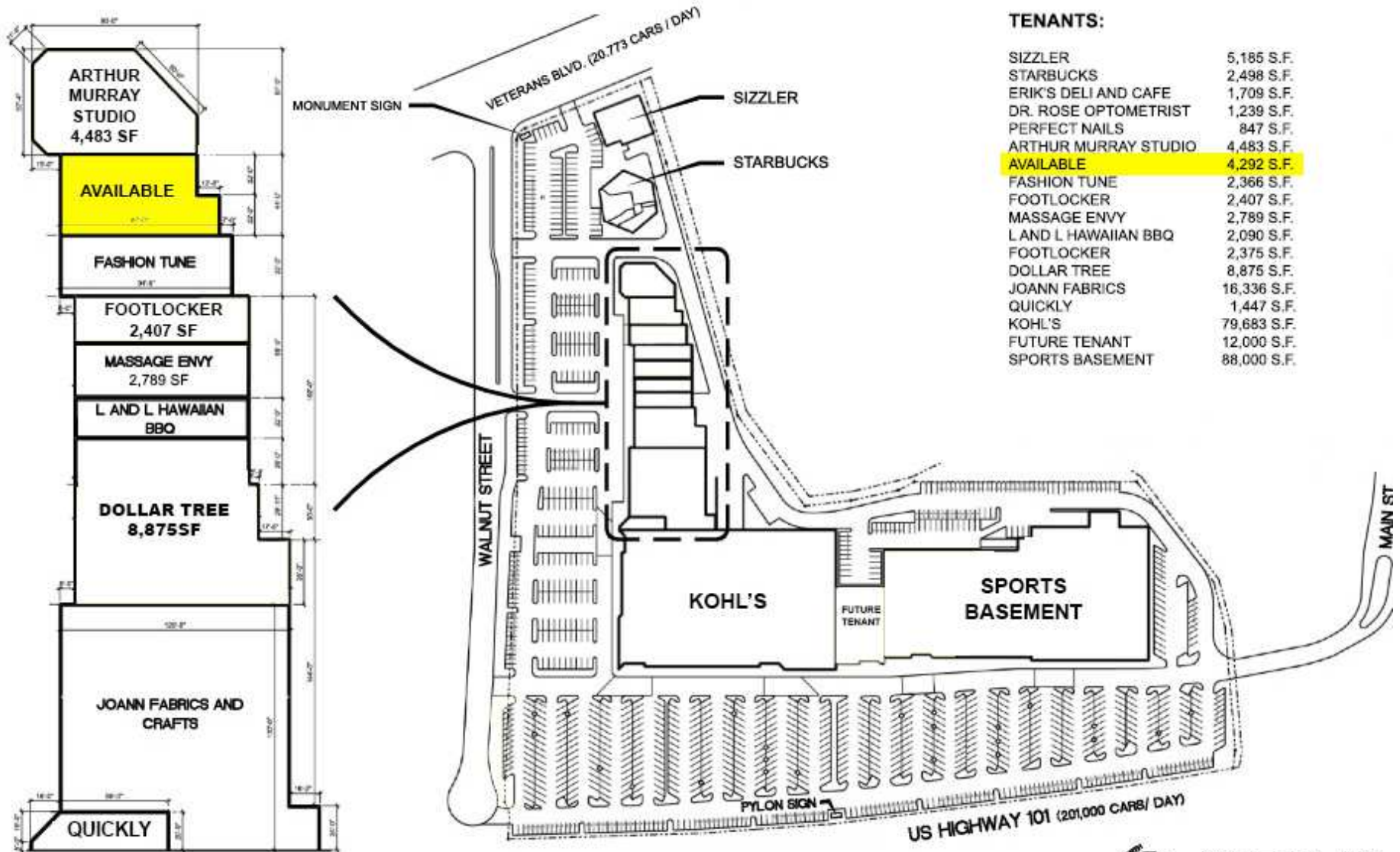

TENANTS:

SIZZLER	5,185 S.F.
STARBUCKS	2,498 S.F.
ERIK'S DELI AND CAFE	1,709 S.F.
DR. ROSE OPTOMETRIST	1,239 S.F.
PERFECT NAILS	847 S.F.
ARTHUR MURRAY STUDIO	4,483 S.F.
AVAILABLE	4,292 S.F.
FASHION TUNE	2,366 S.F.
FOOTLOCKER	2,407 S.F.
MASSAGE ENVY	2,789 S.F.
L AND L HAWAIIAN BBQ	2,090 S.F.
FOOTLOCKER	2,375 S.F.
DOLLAR TREE	8,875 S.F.
JOANN FABRICS	16,336 S.F.
QUICKLY	1,447 S.F.
KOHL'S	79,683 S.F.
FUTURE TENANT	12,000 S.F.
SPORTS BASEMENT	88,000 S.F.



SITE PLAN

N.T.S.

0 50' 100' 200'

SPACE PLAN

Contact: Thomas N. Klein (CA BRE#00840486), tklein@crosspointrealty.com Phone 415.288.6888

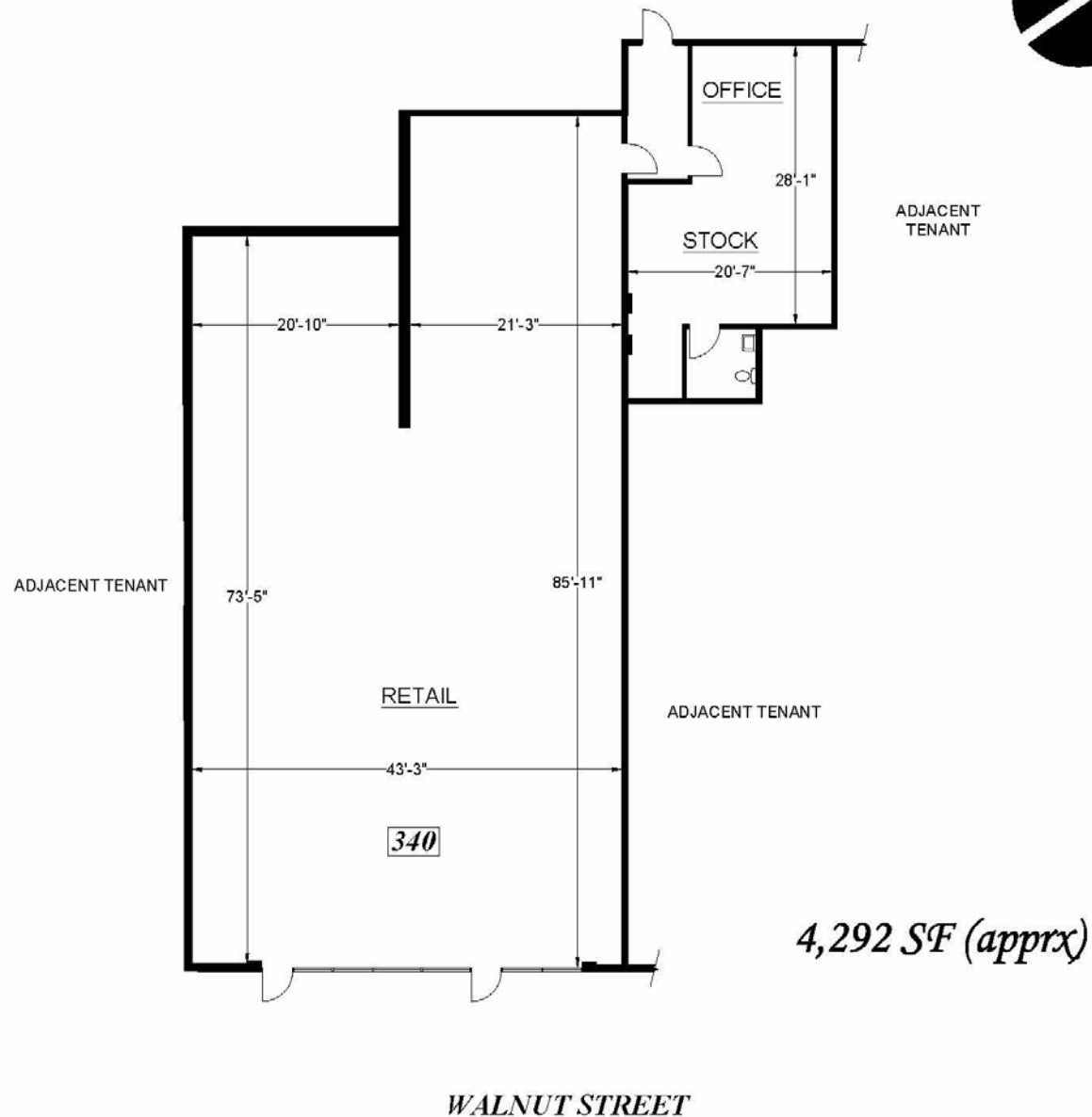

Peninsula Boardwalk

200 – 400 Walnut Street | Redwood City, California

MARKET DESCRIPTION

Peninsula Boardwalk Tenants Include:

Sports Basement	L&L Hawaiian BBQ
Dollar Tree	Massage Envy
Erik's Deli	Perfect Nails
Fashion Tune	Quickly USA
Footlocker	Sizzler
Jo Ann Fabrics	Starbucks
Kohl's	

For information, contact:

Emily Murtha, CA BRE #01891284
emurtha@crosspointrealty.com

Thomas N. Klein, CA DRE #00840486
tklein@crosspointrealty.com

Phone: 415-288-6888
Fax: 415-288-6877

Crosspoint Realty Services, Inc.
303 Sacramento Street, 3rd Floor
San Francisco, CA 94111
www.crosspointrealty.com



Peninsula Boardwalk

200 – 400 Walnut Street | Redwood City, California

MAP & INFORMATION

Description:

High profile 236,000 square foot promotional center on 19 acres fronting the Bayshore Freeway (US 101). The Bay Area's largest Sports Basement store anchors the center which also includes a strong line up of shops and several restaurants in an environment that offers abundant parking and a pleasant shopping experience.

Location:

200 – 400 Walnut Street. Redwood City, CA 94063
Located at the corner of Veterans Blvd. and Walnut Street, adjacent to US Highway 101.

For information, contact:

Emily Murtha, CA BRE #01891284
emurtha@crosspointrealty.com

Thomas N. Klein, CA DRE #00840486
tklein@crosspointrealty.com

Phone: 415-288-6888
Fax: 415-288-6877

Crosspoint Realty Services, Inc.
303 Sacramento Street, 3rd Floor
San Francisco, CA 94111
www.crosspointrealty.com

