



MULTI-TENANT SUITES WITH OFFICE AND WAREHOUSE IN A VARIETY OF SIZES

EXCELLENT VISIBILITY AT ALTON PARKWAY AND JERONIMO ROAD

MINUTES TO IRVINE SPECTRUM CENTER® WITH RESTURANTS, SHOPPING AND ENTERTAINMENT

EASY ACCESS TO THE 5, 405 AND 133 FREEWAYS AND THE 241 TOLL ROAD

BEAUTIFUL LANDSCAPING AND WELCOMING PEOPLE SPACES

AMPLE AND CONVENIENT SURFACE PARKING

9272 JERONIMO ROAD

Multi-Tenant Units from 1,234 sq. ft.

IRVINE SPECTRUM®

9272 JERONIMO ROAD

Multi-Tenant Units from 1,234 sq. ft.

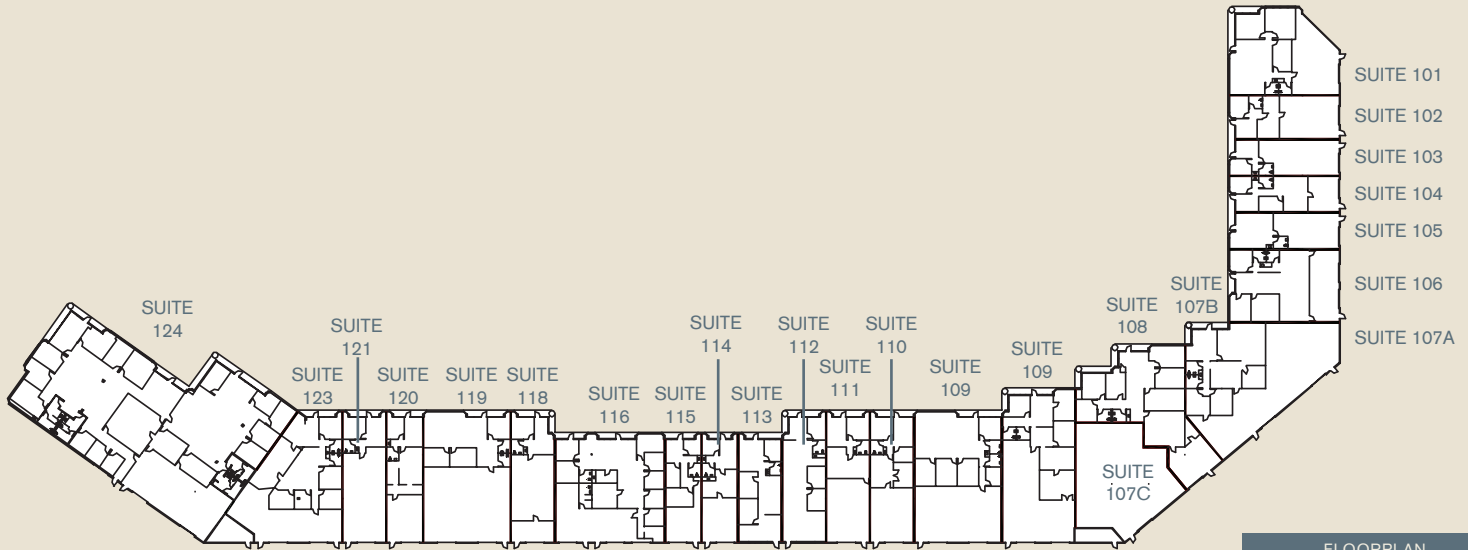

FLOORPLAN

FEATURES

- Office and warehouse space available in a variety sizes
- Air conditioning and heating in offices
- Minimum Clearance Height: 14'
- Parking: 3,100 sq. ft.
- Electrical: 200 AMPS
- Fully Sprinklered

EASY ACCESS

- Located on highly-traveled Alton Parkway
- Easy access to the 5, 405 and 133 Freeways and 241 Toll Road
- Minutes to John Wayne Airport
- Minutes to Irvine Spectrum Center®
- AMTRAK and Metrolink service at nearby Irvine Transportation Center

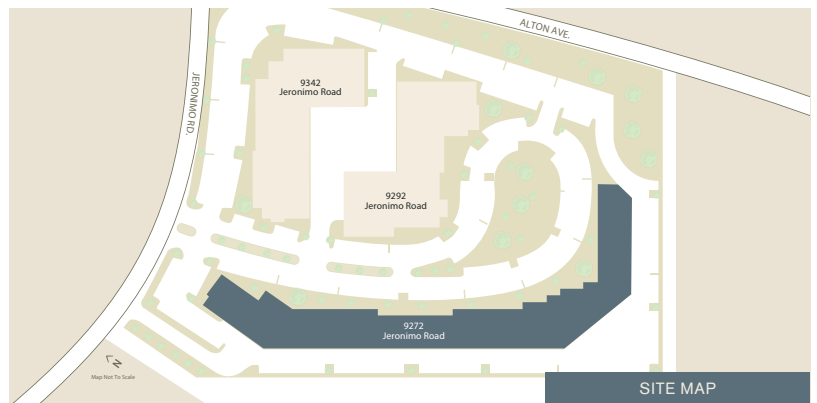

SITE MAP

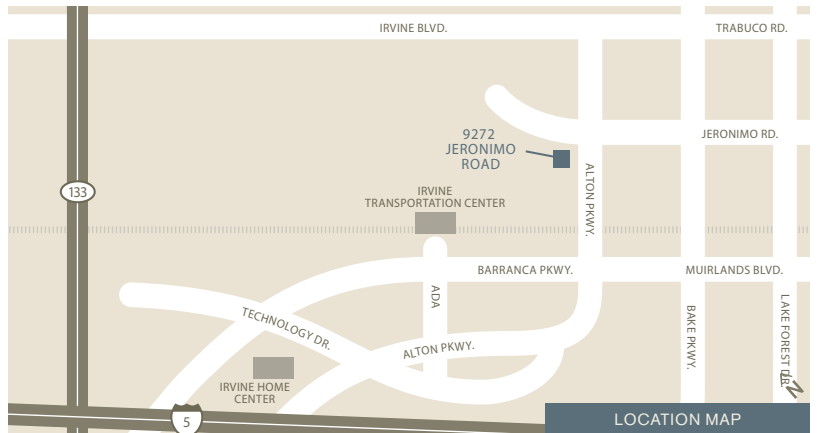

LOCATION MAP



IRVINECOMPANYOFFICE.COM

FOR LEASING INFORMATION, CONTACT LAURA DRACHMAN
949.720.4484 | LDRACHMAN@IRVINECOMPANY.COM
LIC. 01843643

PREMIER ENVIRONMENTS WHERE YOUR BUSINESS CAN PROSPER

A commitment to long-term ownership, the highest standards of service and the opportunity to move and expand within our diverse portfolio are just a few of the reasons to lease with Irvine Company Office Properties.