

- Building Area Summary (Existing) -

Building A	155,174 sf	Building D	17,560 sf
First Floor	92,940 sf	Building E	17,790 sf
Second Floor	57,650 sf	First Floor	5,930 sf
Third Floor	4,584 sf	Second Floor	5,930 sf
Building B	29,340 sf *	Third Floor	5,930 sf
Building C	78,510 sf	Building F	9,960 sf
First Floor	74,325 sf		
Second Floor	4,005 sf		

* Estimated

2 KEY PLAN
EX-1 SCALE: 1/32"=1'-0"

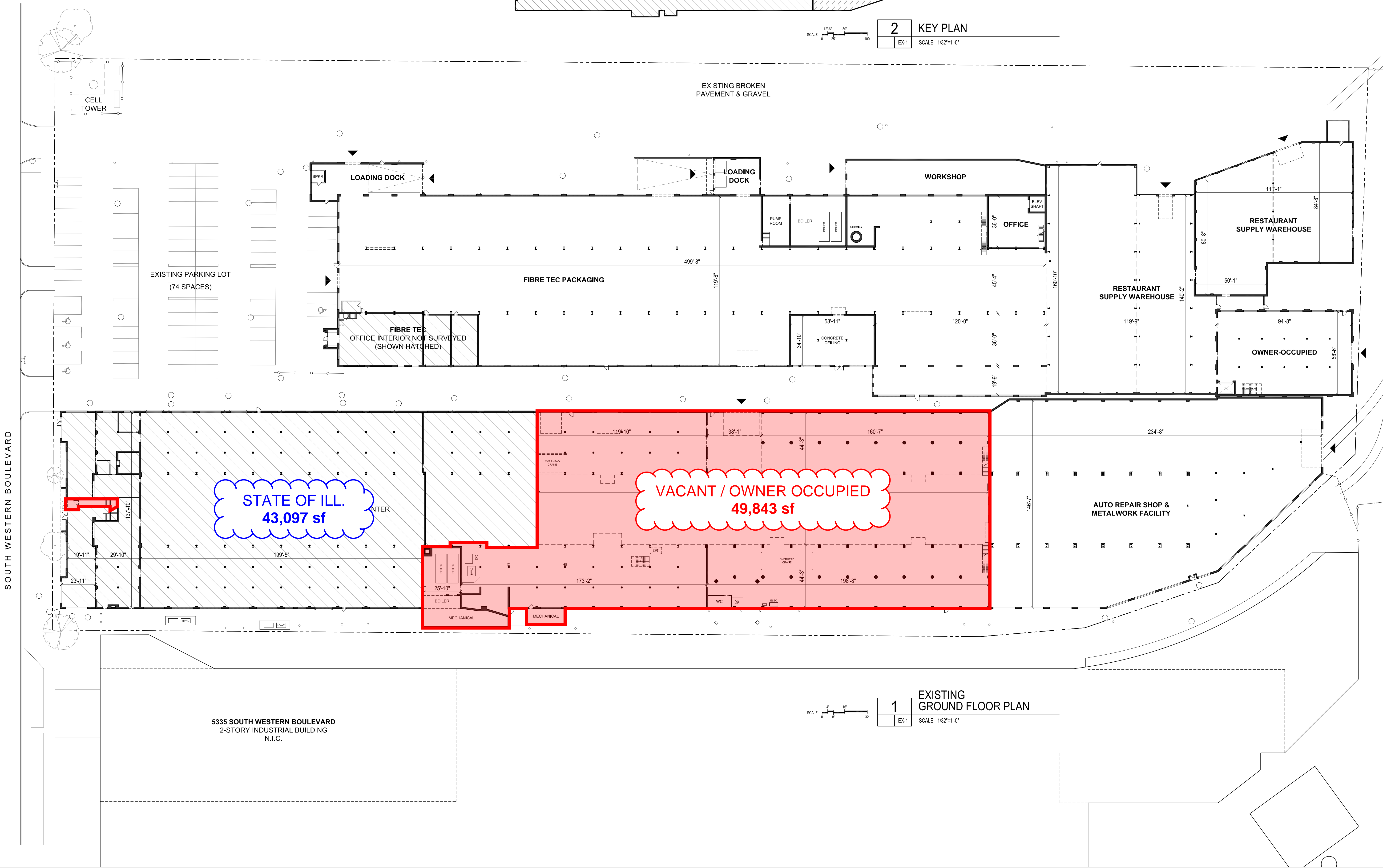

1 EXISTING GROUND FLOOR PLAN
EX-1 SCALE: 1/32"=1'-0"

5335 SOUTH WESTERN BOULEVARD
2-STORY INDUSTRIAL BUILDING
N.I.C.

#	Date	Description
1	09.19.2019	EXISTING CONDITIONS

Revisions

Copyright: Via Chicago, Ltd. expressly reserves its Common Law Copyright and other property rights in these plans. These plans shall not be reproduced, changed, or copied in any form or manner whatsoever, nor shall they be assigned to any third party, without first obtaining the expressed, written permission and consent of Via Chicago, Ltd.

These drawings may have been reproduced at a size different than originally drawn. Owner and Architect assume no responsibility for use of an incorrect scale.

Contractor shall verify existing conditions and review the documents in their entirety prior to proceeding with construction, and shall notify the Architect immediately of any discrepancies or conflicts.

Illinois Professional Design Firm
License No. 184.007298 - Exp. 04/2021

Via Chicago Architects x Diseñadores

Chicago, Illinois USA // 312 · 879 · 9828 // www.viachicagoarchitects.com

Project Location
Western Industrial Campus
5301-5323 South Western Blvd
Chicago, Illinois 60609

Drawing Title
EXISTING GROUND FLOOR PLAN

Seal	Date
	Project No. 1925

Drawing No.
EX-1