

2013 ORTHO AERIAL MAPS (Click here for Data Information)

Showing Parcel Lines & Labels



2013 Digital Orthophotos (Aerial Photographs)

The digital orthophotos (aerial photographs) displayed were acquired spring of 2013 with "leaf-off" conditions. The county-wide imagery consists of .5' (6 inch) pixel resolutions. Please contact Manistee County Equalization to obtain these digital images and/or detailed prints/maps of selected locations through-out Manistee County.

Manistee County Equalization 231-723-5957

What is a digital orthophoto? Digital orthophotos are just like a map, but with all of the ground features visible. It is a pictorial version of a map. The photographic image has been "draped" over an accurate map base so that the topography - such as hills and valleys - are part of the picture giving the photo a scale that can be measured with confidence.

Copyright © 2015 Land Information Access Association

- North Arrow
- 55 US Feet
- 2013 Digital Orthophotograph
- Municipal Name & Border
- Public Roads
- Property Lines

Image/Sketch for Parcel: 51-270-705-01

City of Manistee

Caption: No caption found

[Back to Non-Printer Friendly Version] [Send To Printer]

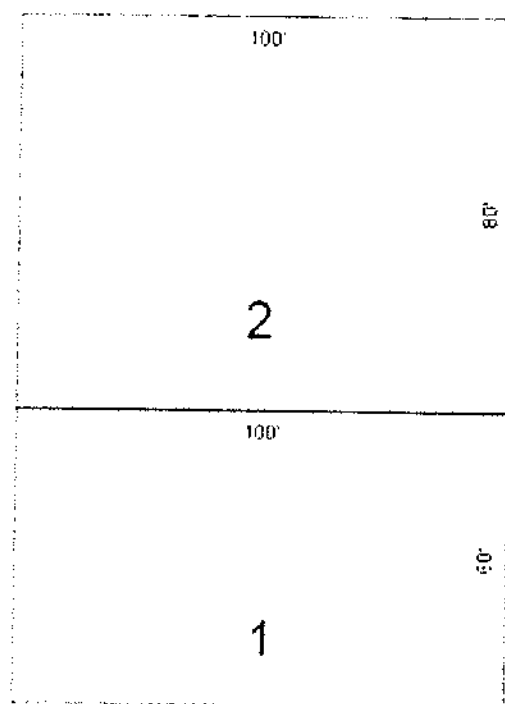

WASHINGTON STREET

SECOND AVENUE

© 2015 BSA Software

****Disclaimer:** BSA Software provides this Web Site as a way for municipalities to display information online and is not responsible for the content or accuracy of the data herein. This data is provided for reference only and WITHOUT WARRANTY of any kind, expressed or inferred. Please contact your local municipality if you believe there are errors in the data.
www.bsasoft.com

Image/Sketch for Parcel: 51-270-705-01

City of Manistee

[Back to Non-Printer Friendly Version] [Send To Printer]

Caption: No caption found

Sketch by: Scott Anderson

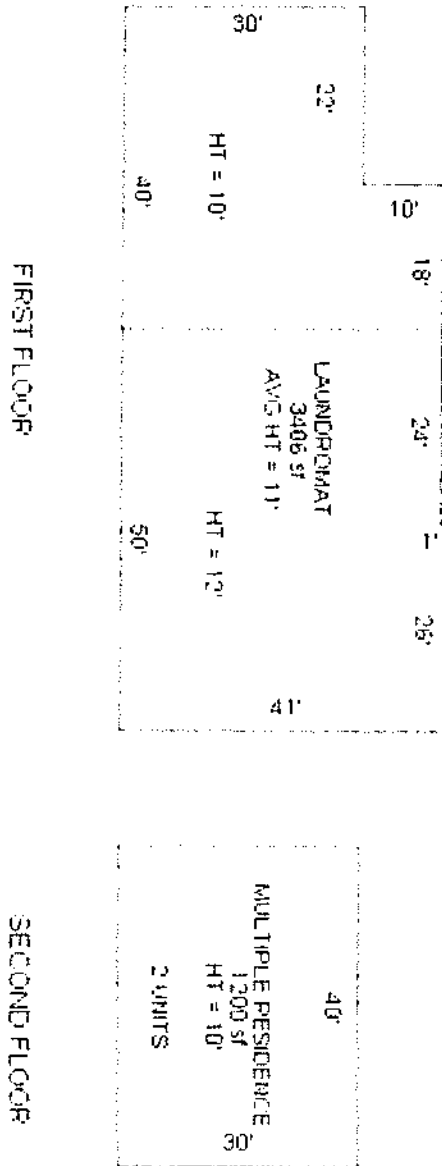

****Disclaimer:** BS&A Software provides this Web Site as a way for municipalities to display information online and is not responsible for the content or accuracy of the data herein. This data is provided for reference only and WITHOUT WARRANTY of any kind, expressed or inferred. Please contact your local municipality if you believe there are errors in the data.
[Print a Page](#)