



Rose Garden Commerce Center

2411 W Rose Garden, Phoenix, Arizona 85027



Rose Garden Commerce Center

2411 W Rose Garden, Phoenix, Arizona 85027

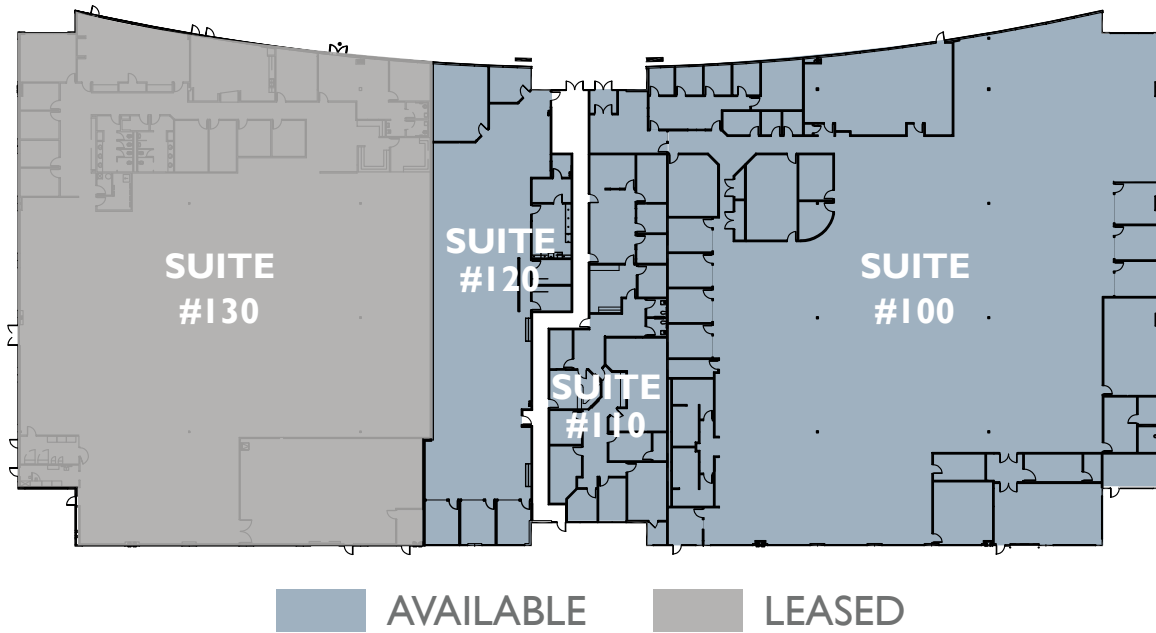







SUITE #	RSF
100	±30,125
110	±4,705
120	±7,405

Building Features

-  ±68,600 SF, single-story office building
-  7/1,000 parking ratio
-  Built in 1998, quality glass and brick exterior
-  12' dropped ceiling, 18' clear height
-  Building and monument signage opportunity
-  Large, efficient, single-floor plate
-  Cox and Century Link with power redundancy
-  Dedicated back-up generator in place, specific to premises
-  Institutional and responsive ownership

The Location

-  Located at the northeast corner of I-17 and Loop 101 on Rose Garden Lane
-  Adjacent to Valley Metro Bus Route 27, stops at 23rd Avenue and Rose Garden Lane
-  Proximity to strong labor force
-  Corporate neighbors include PetSmart HQ, Discover Card, Wells Fargo, Safeway Regional HQ, American Express, Best Western Data Center and others
-  One-half mile to Deer Valley Towne Square with ±350,000 SF of retail amenities, including casual and fine dining
-  2.5 miles to I-17 and Happy Valley Road, featuring over 1,000,000 SF of retail amenities

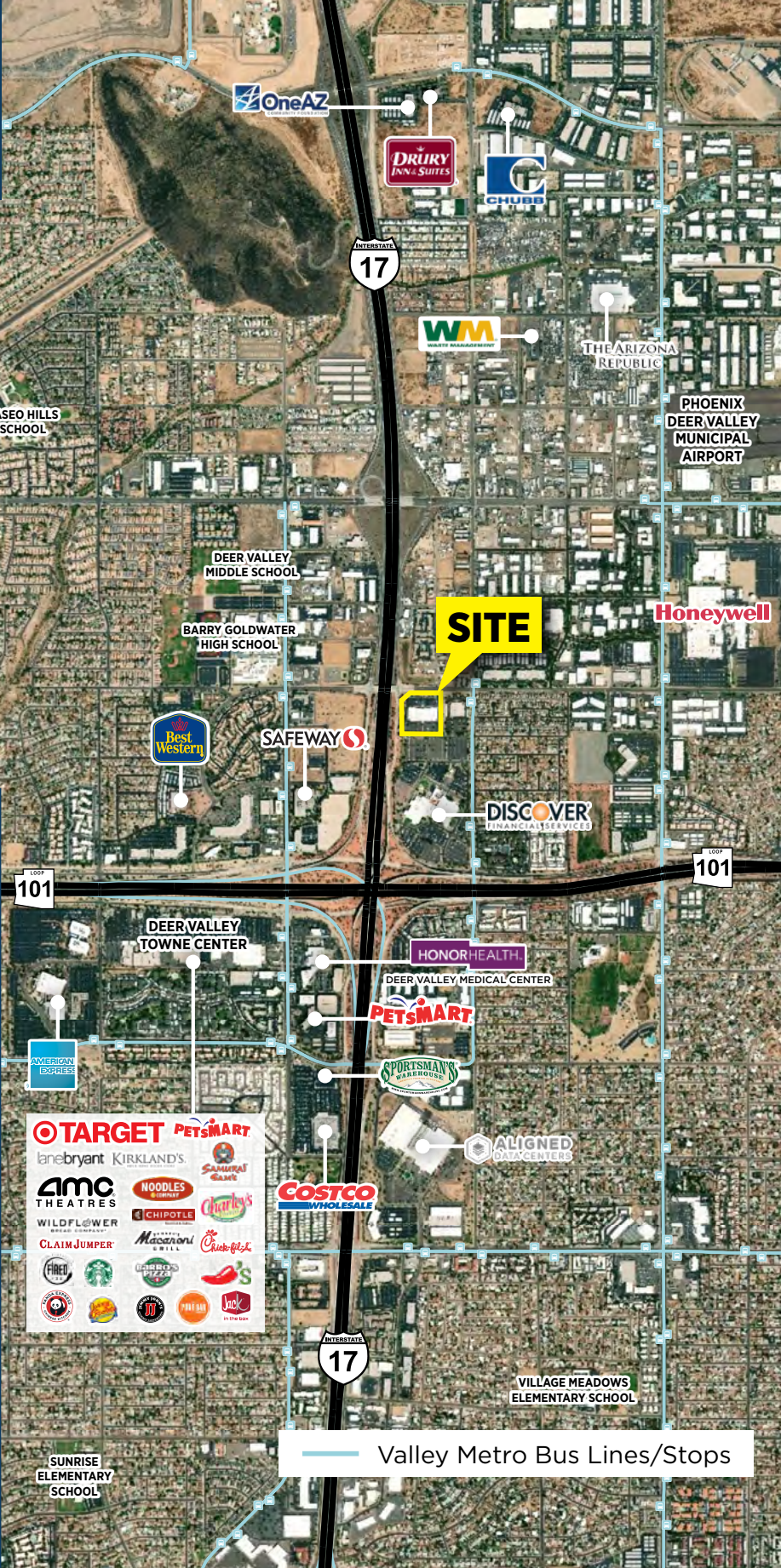

GREG MCMILLAN
 greg.mcmillan@cushwake.com
 +1 602 229 5922

JOHN POMPAY
 john.pompay@cushwake.com
 +1 602 224 4422



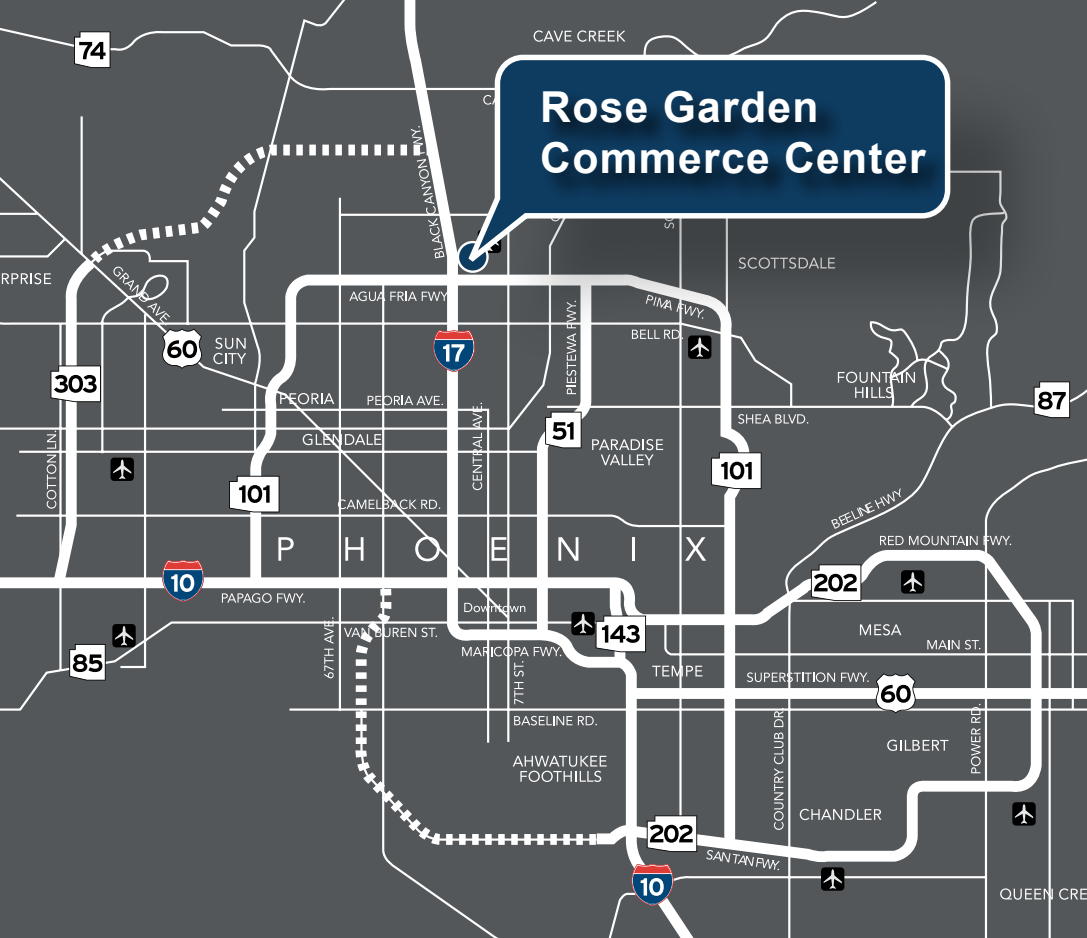

Broker Contact

GREG MCMILLAN

greg.mcmillan@cushwake.com
+1 602 229 5922

JOHN POMPAY

john.pompay@cushwake.com
+1 602 224 4422



2555 E Camelback Road | Suite 400 | Phoenix, AZ 85016

Cushman & Wakefield Copyright 2022. No warranty or representation, express or implied, is made to the accuracy or completeness of the information contained herein, and same is submitted subject to errors, omissions, change of price, rental or other conditions, withdrawal without notice, and to any special listing conditions imposed by the property owner(s). As applicable, we make no representation as to the condition of the property (or properties) in question. 04-15-19