

3140 TROY SCHENECTADY ROAD NISKAYUNA, NEW YORK



Class A Professional Office Building.

Available Spaces from 2,133 rentable square feet up to 5,469 rentable square feet.

Environmentally and Technologically Advanced, State of The Art Office Building.

Located on Troy-Schenectady Road at Latham/Niskayuna border.

Excellent location with Attentive, On-Site Landlord.

Beautiful Finishes and Windows Everywhere.

Asking: \$16.50 PSF Gross plus utilities + Increase in base year



Exclusive Leasing Agents:
TITAN Commercial Realty Group, LLC
40 Beaver Street, 5th Floor
Albany, New York 12207
O: (518) 400-0668 F: (518) 400-0668
www.titancommercialrealtygroup.com
NYS Licensed Real Estate Broker

HELPING BUILD EMPIRES ONE DEAL AT A TIME™

NYS Fair Housing Notice: https://www.dos.ny.gov/licensing/re_broker/re_broker.html

Contact:

Todd J. Drowlette
Managing Director
NYS Licensed Real Estate Broker
(518) 400-0668 Ext: 702
tdrowlette@titancommercialrealtygroup.com



3140 TROY SCHENECTADY ROAD NISKAYUNA, NEW YORK

at Albany County/Schenectady County Border



**3140 TROY SCHENECTADY ROAD
NISKAYUNA, NEW YORK**

at Albany County/Schenectady County Border

FLOOR PLANS

First Floor

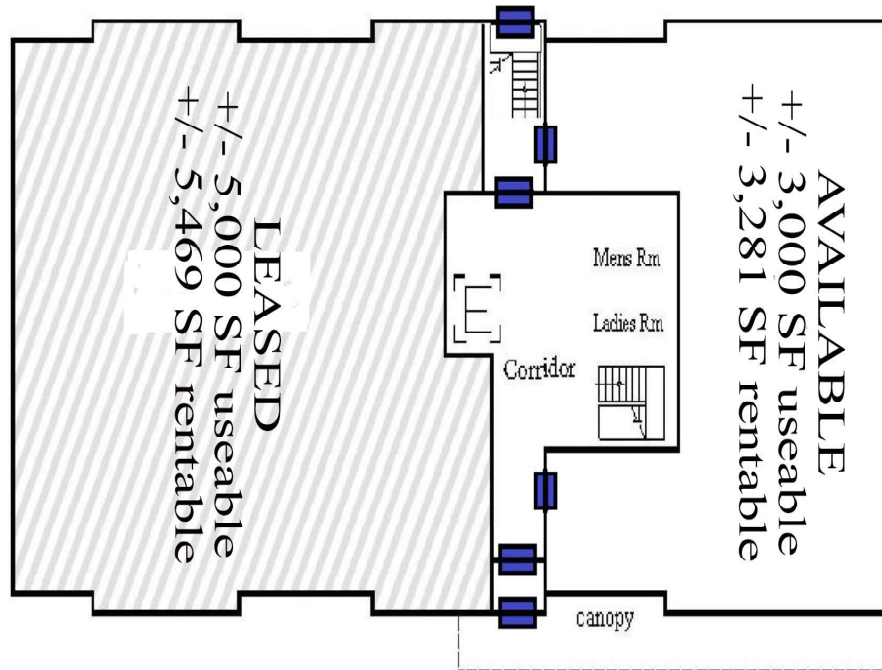

**(Lower Level)
Mezzanine Level**

