

AVAILABLE IMMEDIATELY

±277,637 SF
**FOR SALE/
LEASE**

201
**ELIZABETH
STREET**

BORDENTOWN, NJ

bai

bai Warehouse & Distribution Center

- ±277,637 SF Warehouse and Distribution Center
- Includes ±9,108 SF of Office
- ±113,797 SF of Approved Expansion
- Located Within the Best Regional Submarket

CBRE

FLOOR PLAN



Existing Building Size	277,637 SF
Expansion Building A	51,509 SF
Expansion Building B	62,288 SF
TOTAL SF	391,434 SF

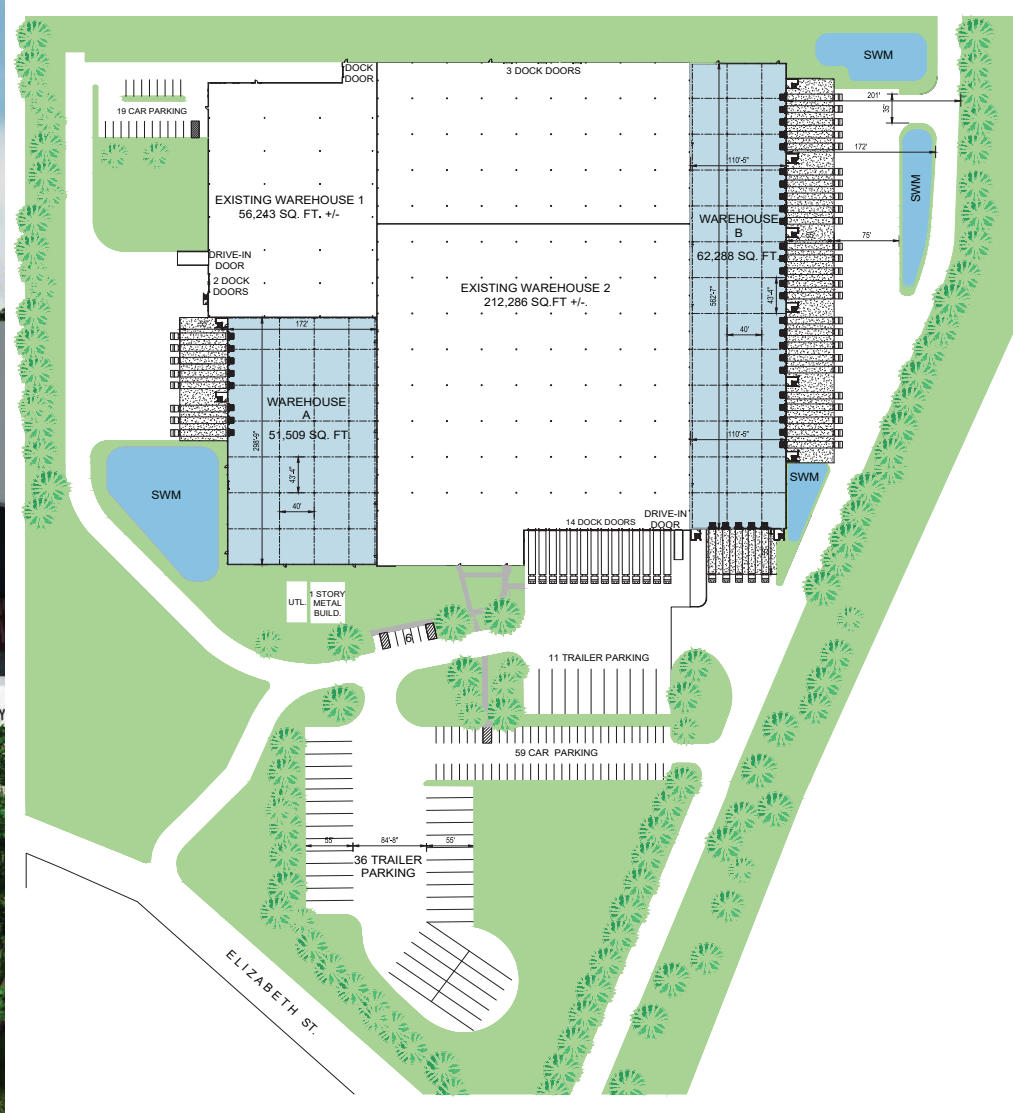

PROPERTY DETAILS

Address	201 Elizabeth Street, Bordentown, NJ 08505		
Block / Lot	1601/1 & 2		
Land Area	33.9 AC useable; 39.3 AC total		
Existing Building Size	Warehouse Area	268,529 SF	97%
	Office Area	9,108 SF	3%
	Total	277,637 SF	
Expansion Size	Bldg A	51,509 SF	
	Bldg B	62,288 SF	
	Total	113,797 SF	
Total Potential Size	391,434 SF		
Year Built / Renovated	± 1985; ± 1995; ± 2015		
Leased (%)	100%		
Tenancy	Single		
Exterior Walls	Concrete block		
Floor Construction	Slab on grade		

201

ELIZABETH STREET

BORDENTOWN, NJ

Located just off Exit 7 of the New Jersey Turnpike (I-95) in Bordentown, Burlington County, NJ



Ceiling Height	24'
Column Spacing	40' W x 43' D
Loading Docks	54 total tailgate doors with full dock package (loading levelers, dock lock, weather seal & lights)
Drive-in	2 drive-in doors (8' x 10') & (14' x 16')
Rail	2 rail car positions
Power	New 26 KVA distributes 13 KVA to Park Street & Elizabeth Street substations (built in 2000)(PSE&G)
Natural Gas	PSE&G
Water and Sewer	City
Sprinklers	Wet
HVAC	Gas, Split & RTU AC
Parking*	Car Spaces 84 Trailer Spaces 99
Zoning	C/I (Commercial/Industrial)
Real Estate Taxes	\$1.35/PSF

TOTAL DOCK DOORS

WAREHOUSE A

8 - 9' x 10' Dock Doors

EXISTING WAREHOUSE 1

2 - 9' x 10' Dock Doors
1 - 12' x 14" Dock Door
1 - 14' x 16' Drive-In Door

DOCK DOORS

8 Warehouse A
30 Warehouse B
2 Existing Warehouse 1
14 Existing Warehouse 2

WAREHOUSE B

30 - 9' x 10' Dock Doors

EXISTING WAREHOUSE 2

14 - 8' x 10' Dock Doors
3 - 9' x 10' Dock Doors
1 - 8' x 10' Drive-In Door

54
TOTAL DOCK DOORS



CBRE

* Parking can be revised to offer 63 trailers and 234 cars



CONTACT US

Mindy Lissner, SIOR

Executive Vice President
+1 732 509 2831
mindy.lissner@cbre.com

David Gheriani

First Vice President
+1 732 509 8942
david.gheriani@cbre.com

Dan McGovern

First Vice President
+1 856 359 9406
dan.mcgovern@cbre.com

Andrew Green

Vice President
+1 610 251 0820
andrew.green@cbre.com

201
ELIZABETH
STREET

BORDENTOWN, NJ

CBRE

© 2020 CBRE, Inc. All rights reserved. This information has been obtained from sources believed reliable, but has not been verified for accuracy or completeness. You should conduct a careful, independent investigation of the property and verify all information. Any reliance on this information is solely at your own risk. CBRE and the CBRE logo are service marks of CBRE, Inc. All other marks displayed on this document are the property of their respective owners. Photos herein are the property of their respective owners and use of these images without the express written consent of the owner is prohibited.