

3016-3026 S. 24<sup>TH</sup> STREET  
KANSAS CITY, KANSAS 66106

INDUSTRIAL FOR LEASE | 24,300± SF

## PROPERTY FEATURES

- Landlord willing to demise
- 15'-16' clear height
- Dock and drive-in loading
- Updated lighting
- Heavy Power: (3-167 kVA), 277/480V, 3ph
- Fenced parking lot
- Great access to I-35, I-635, & I-70

### ADDITIONAL INFO

TOTAL SIZE	24,300± SF
OFFICE SPACE	1,500± SF
LEASE RATE	\$4.95-\$5.50 PSF Net
TAXES (2018)	\$1.12



For more information, please contact:

**MATTHEW SEVERNS, SIOR, CCIM**  
Industrial Brokerage  
816.936.8543 direct  
[mseverns@kessingerhunter.com](mailto:mseverns@kessingerhunter.com)

**KURT JENSEN**  
Industrial Brokerage  
816.936.8508 direct  
[kjensen@kessingerhunter.com](mailto:kjensen@kessingerhunter.com)

**KESSINGER/HUNTER & COMPANY, LC**  
2600 Grand Boulevard, Suite 700  
Kansas City, MO 64108  
816.842.2690  
[www.kessingerhunter.com](http://www.kessingerhunter.com)

# 3016-3026 S. 24<sup>TH</sup> STREET, KANSAS CITY, KANSAS 66106

## Industrial for Lease

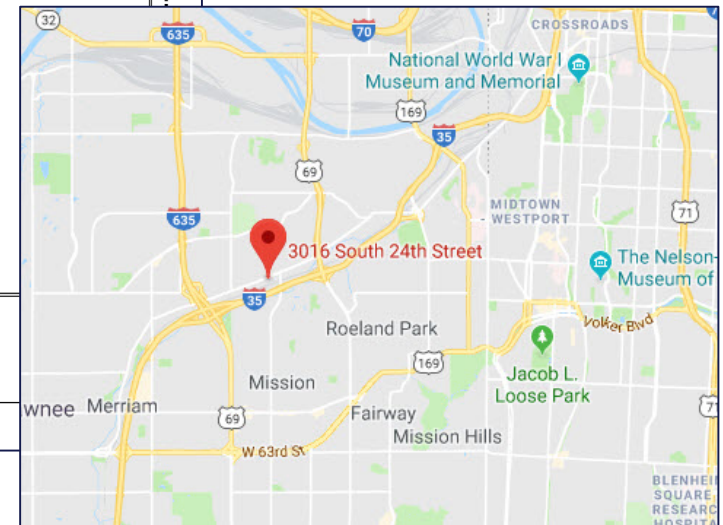
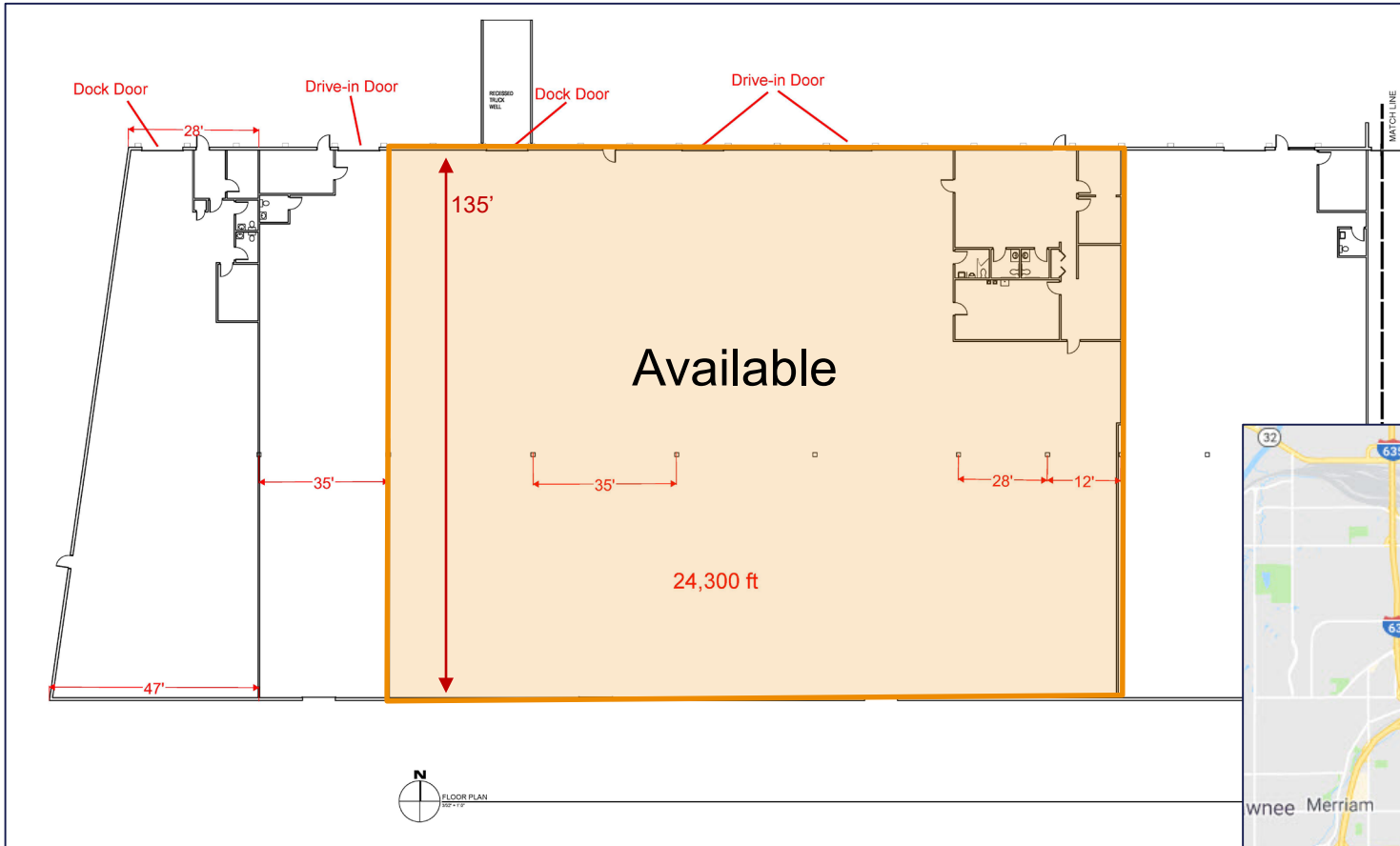

For more information, please contact:

**MATTHEW SEVERNS, SIOR, CCIM**  
Industrial Brokerage  
816.936.8543 direct  
[mseverns@kessingerhunter.com](mailto:mseverns@kessingerhunter.com)

**KURT JENSEN**  
Industrial Brokerage  
816.936.8508 direct  
[kjensen@kessingerhunter.com](mailto:kjensen@kessingerhunter.com)

**KESSINGER/HUNTER & COMPANY, LC**  
2600 Grand Boulevard, Suite 700  
Kansas City, MO 64108  
816.842.2690  
[www.kessingerhunter.com](http://www.kessingerhunter.com)