

Prologis Itasca

1601 Glenlake Avenue

Itasca, IL 60143 USA

54,690 Square Feet Industrial Space For Lease



PROLOGIS®

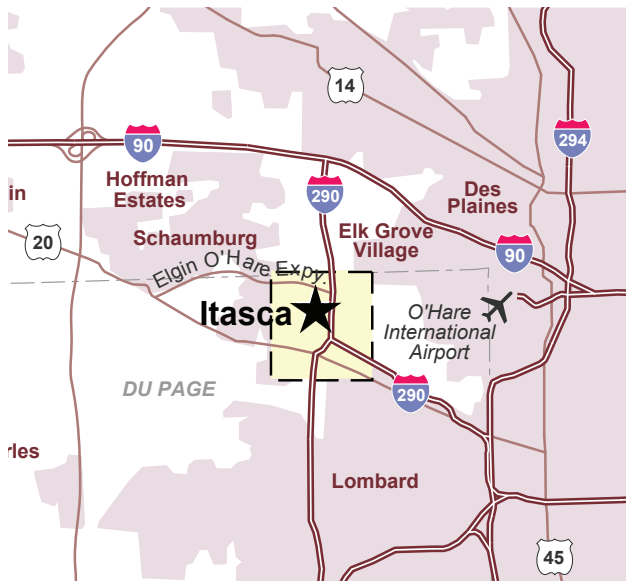

location

- DuPage County

facility

- 54,690 SF building
- ±3124 SF office
- 40' x 32'6" typical bays
- 20'9" clear height
- 4 interior docks with levelers
- 1 drive in door (10' x 12')
- wet sprinkler system
- 400 amps @ 120 / 208v
- 30 days possession
- renovated office space (2016)
- parking expansion potential on west side of property
- brand new server room
- office space includes "clean" room



Lee & Associates
Jeffrey J. Janda, SIOR
jjanda@lee-associates.com
ph +1 773.355.3015
fax +1 847.233.0068
cell +1 847.736.7338
9450 W Bryn Mawr Ave
Suite 550
Rosemont, IL 60018 USA

Lee & Associates
Michael J. Plumb
mplumb@lee-associates.com
ph +1 773.355.3019
fax +1 847.233.0068
cell +1 847.560.0481
9450 W Bryn Mawr Ave
Suite 550
Rosemont, IL 60018 USA

Prologis
Scott Gibbel
sgibbel@prologis.com
ph +1 847.292.3912
fax +1 847.556.0465
cell +1 224.808.2294
6250 N. River Road
Suite 1100
Rosemont, IL 60018 USA

Prologis Itasca

1601 Glenlake Avenue

Itasca, IL 60143 USA

54,690 Square Feet Industrial Space For Lease



PROLOGIS

Potential parking expansion / subject to Village approval

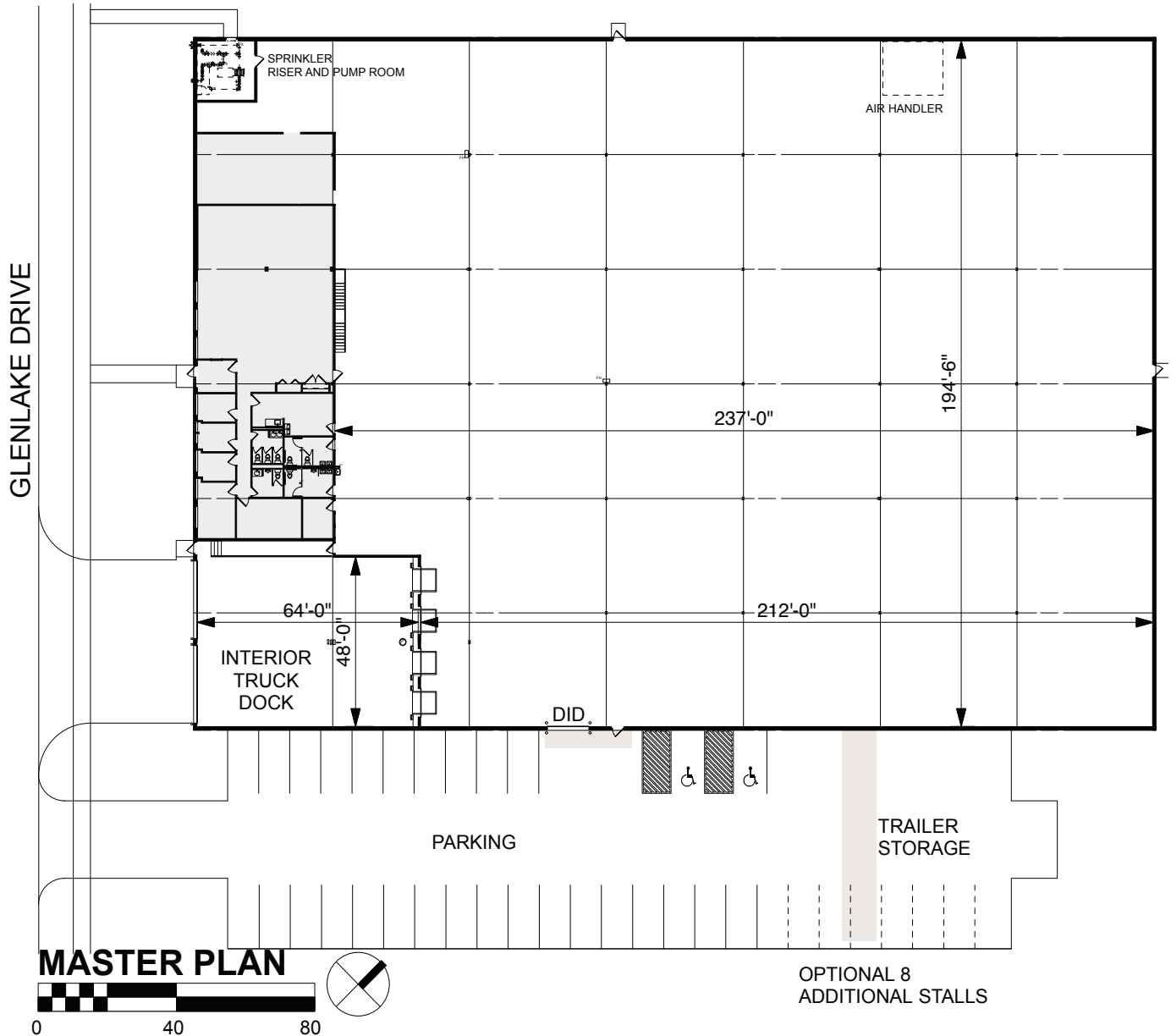

Lee & Associates
Jeffrey J. Janda, SIOR
jjanda@lee-associates.com
ph +1 773.355.3015
fax +1 847.233.0068
cell +1 847.736.7338
9450 W Bryn Mawr Ave
Suite 550
Rosemont, IL 60018 USA

Lee & Associates
Michael J. Plumb
mplumb@lee-associates.com
ph +1 773.355.3019
fax +1 847.233.0068
cell +1 847.560.0481
9450 W Bryn Mawr Ave
Suite 550
Rosemont, IL 60018 USA

Prologis
Scott Gibbel
sgibbel@prologis.com
ph +1 847.292.3912
fax +1 847.556.0465
cell +1 224.808.2294
6250 N. River Road
Suite 1100
Rosemont, IL 60018 USA