

215 E. WARM SPRINGS RD. SUITE 106
LAS VEGAS, NEVADA 89119



OFFICE SPACE FOR LEASE

1,600 Sq. Ft. Office
\$0.90 NNN (\$1440.00)
\$0.36 CAMS (\$576.00)
Total (\$2016.00)

- ◆ 5 Offices
- ◆ 1 Reception / Waiting Room
- ◆ 1 Open Area
- ◆ Conference Room
- ◆ Copy Room
- ◆ Data Room
- ◆ Community Restrooms
just out the back door in
the courtyard

Easy access to I-15 & I-215
Excellent Landscaping
Close to Las Vegas Blvd &
McCarran International Airport



PRIORITY ONE COMMERCIAL
REAL ESTATE BROKERAGE

7259 W. SAHARA AVE. STE. 110
LAS VEGAS, NV. 89117

WWW.PRIORITYONECOMMERCIAL.COM

CYNTHIA A. INMAN
Owner/Corporate Broker
Certified Property Manager
702.228.7464
cinman@pocl.com

THE INFORMATION CONTAINED HEREIN WAS OBTAINED BY SOURCES WE BELIEVE TO BE RELIABLE, HOWEVER, NO WARRANTY OR GUARANTEE EITHER EXPRESSED OR IMPLIED IS MADE TO ACCURACY HEREOF. ALL SUCH INFORMATION IS SUBMITTED, SUBJECT TO ERRORS, OMISSIONS OR CHANGES IN CONDITION PRIOR TO SALE, LEASE OR WITHDRAWAL WITHOUT NOTICE. ALL INFORMATION CONTAINED HEREIN SHOULD BE VERIFIED.

215 E. WARM SPRINGS RD. SUITE 106
LAS VEGAS, NEVADA 89119

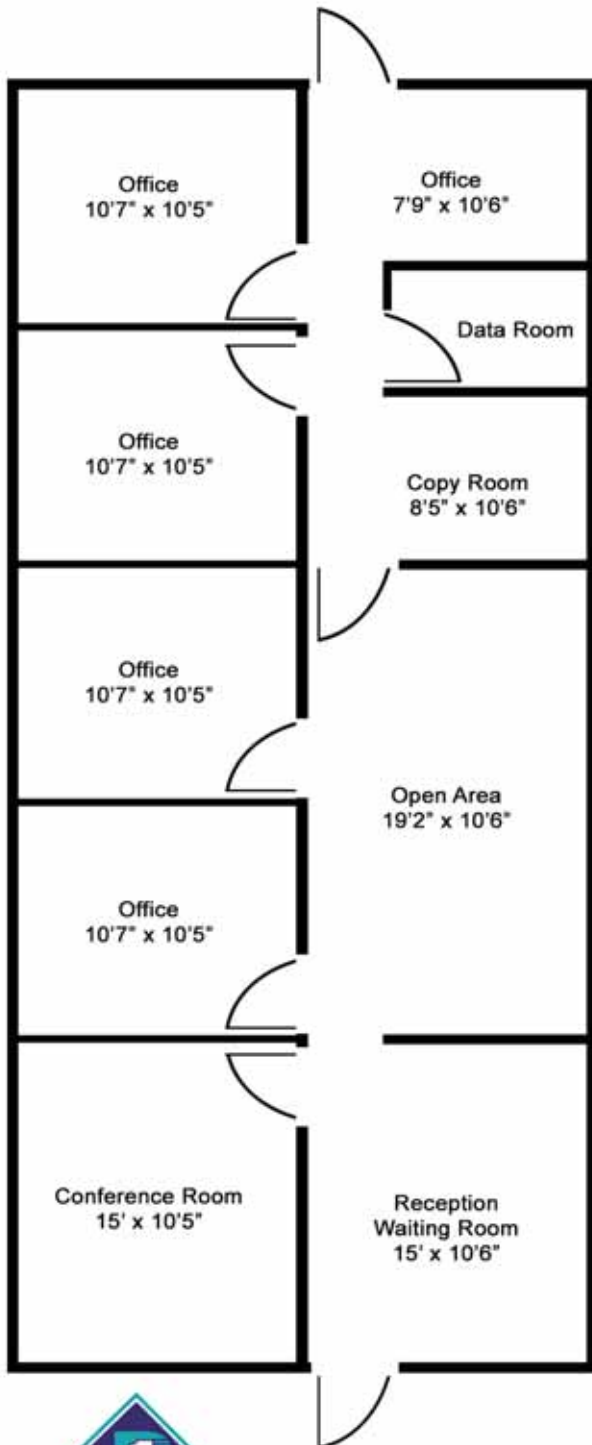

**OFFICE SPACE
FOR LEASE**

1,600 Sq. Ft. Office
\$0.90 NNN (\$1440.00)
\$0.36 CAMS (\$576.00)
Total (\$2016.00)

- ◆ 5 Offices
- ◆ 1 Reception / Waiting Room
- ◆ 1 Open Area
- ◆ Conference Room
- ◆ Copy Room
- ◆ Data Room
- ◆ Community Restrooms
just out the back door in
the courtyard

Easy access to I-15 & I-215
Excellent Landscaping
Close to Las Vegas Blvd &
McCarran International Airport

**LANDLORD
WILL DO
TENANT
IMPROVEMENTS**



PRIORITY ONE COMMERCIAL
REAL ESTATE BROKERAGE

7259 W. SAHARA AVE. STE. 110
LAS VEGAS, NV. 89117

WWW.PRIORITYONECOMMERCIAL.COM

CYNTHIA A. INMAN
Owner/Corporate Broker
Certified Property Manager
702.228.7464
cinman@poclvr.com

THE INFORMATION CONTAINED HEREIN WAS OBTAINED BY SOURCES WE BELIEVE TO BE RELIABLE, HOWEVER, NO WARRANTY OR GUARANTEE EITHER EXPRESSED OR IMPLIED IS MADE TO ACCURACY HEREOF. ALL SUCH INFORMATION IS SUBMITTED, SUBJECT TO ERRORS, OMISSIONS OR CHANGES IN CONDITION PRIOR TO SALE, LEASE OR WITHDRAWAL WITHOUT NOTICE. ALL INFORMATION CONTAINED HEREIN SHOULD BE VERIFIED.