

MAJESTIC AIRPORT CENTER #5

1414 South Gladiola Street, Suite 300, Salt Lake City, Utah 84104

DEVELOPED BY:



MAJESTIC REALTY CO.



FOR LEASE

20,012 SF

PROPERTY FEATURES

- 20,012 Total Square Feet
- 3,486 Office Square Feet including will call area / counter
- 16,526 Warehouse Square Feet
- Six (6) Dock High Doors with Five (5) Bumpers, Three (3) Seals and Three (3) Edge of Dock Levelers
- One (1) 12' x 14' Ground Level Door
- 225 Amp / 480 / 277 / 3 Phase Power Supply
- 28' Clear Height
- Class A Bulk Distribution Building
- Concrete Tilt Construction
- ESFR Fire Suppression System
- Skylights Throughout Warehouse
- Energy Efficient High Bay Lighting in Warehouse with Motion Sensors
- Minutes to Salt Lake International Airport
- Excellent Access to I-215, I-15, and I-80
- Near Salt Lake City Intermodal Hub

FOR MORE
INFORMATION
CONTACT

KYLE ROBERTS, CCIM, SIOR
801.578.5525
kyle.roberts@ngkf.com

KELSIE AKIYAMA
801.578.5504
kelsie.akiyama@ngkf.com

ELI PRIEST
801.746.4746
eli.priest@ngkf.com



376 East 400 South, Suite 120 | Salt Lake City, Utah 84111 | 801.578.5555 | www.ngacres.com

This document has been prepared by Newmark Knight Frank for advertising and general information purposes only. While the information contained herein has been obtained from what are believed to be reliable sources, the same has not been verified for accuracy or completeness. Newmark Knight Frank accepts no responsibility or liability for the information contained in this document. Any interested party should conduct an independent investigation to verify the information contained herein.

MAJESTIC AIRPORT CENTER #5

1414 South Gladiola Street, Suite 300, Salt Lake City, Utah 84104

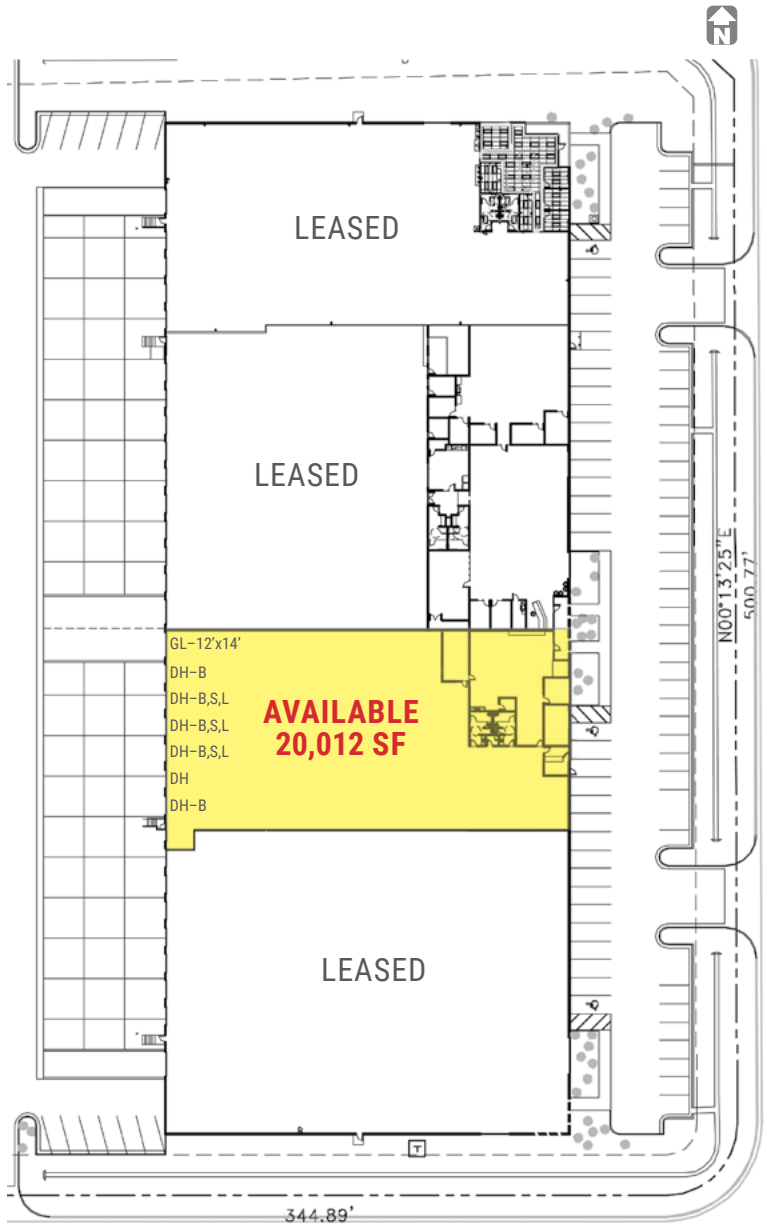
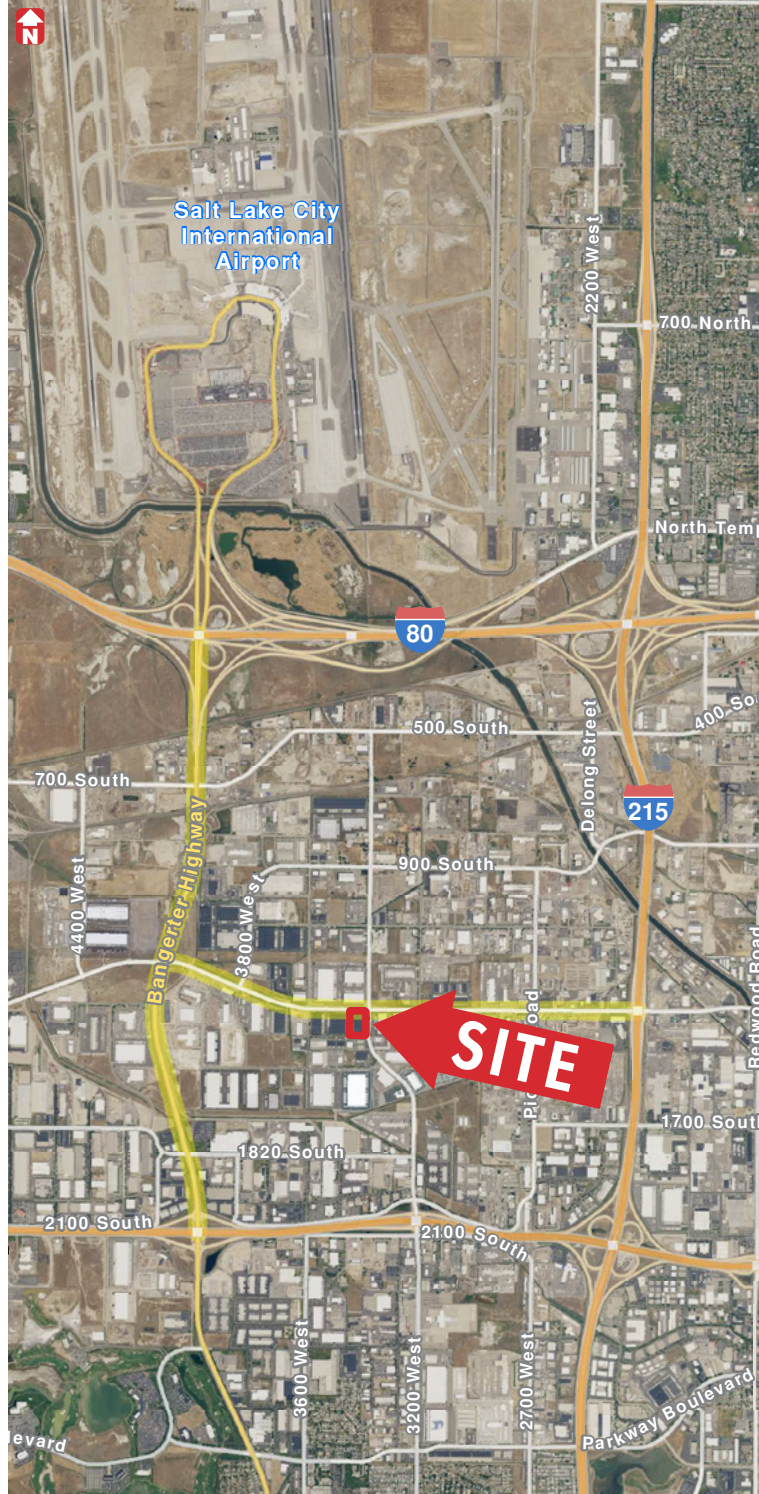

GL - Grade Level Door
S - Seal on Door
L - Levelor on Door
B - Bumper on Door