

36,400 Square Feet Available



LOCATION:

- Northwest Dallas Submarket
- Access to Dallas North Tollway, I-635 & George Bush Turnpike

FACILITY:

- 36,400 SF Available
- Office/Showroom: 1,637 SF
- 24' Clear Height
- 3 - Dock High Doors
- 1 - Ramp
- T-5 Lighting
- Rail Served
- Fully Sprinklered
- Available 12/1/2018

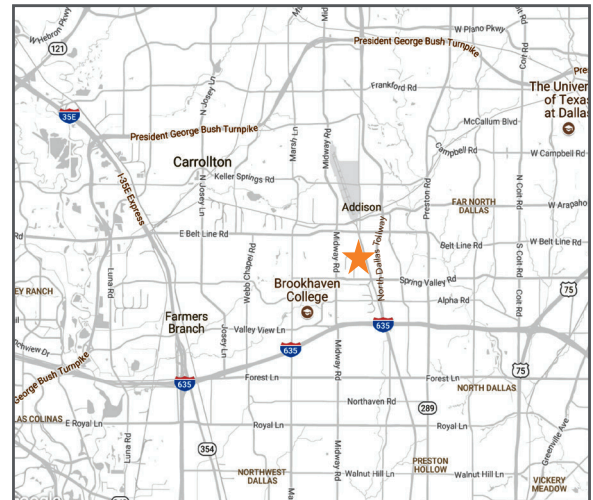

Transwestern

Brett Owens, SIOR
brett.owens@transwestern.com

5001 Spring Valley Rd., Ste. 400W
Dallas, Texas 75244
Office 972.774.2568

Timothy Veler, CCIM
timothy.veler@transwestern.com

5001 Spring Valley Rd., Suite 400W
Dallas, Texas 75244
Office 972.774.2541

Colony Industrial

Jerod Hangartner
jhangartner@clns.com

13727 Noel Road, Suite 750
Dallas, Texas 75240
Office 972.893.7000

36,400 Square Feet Available

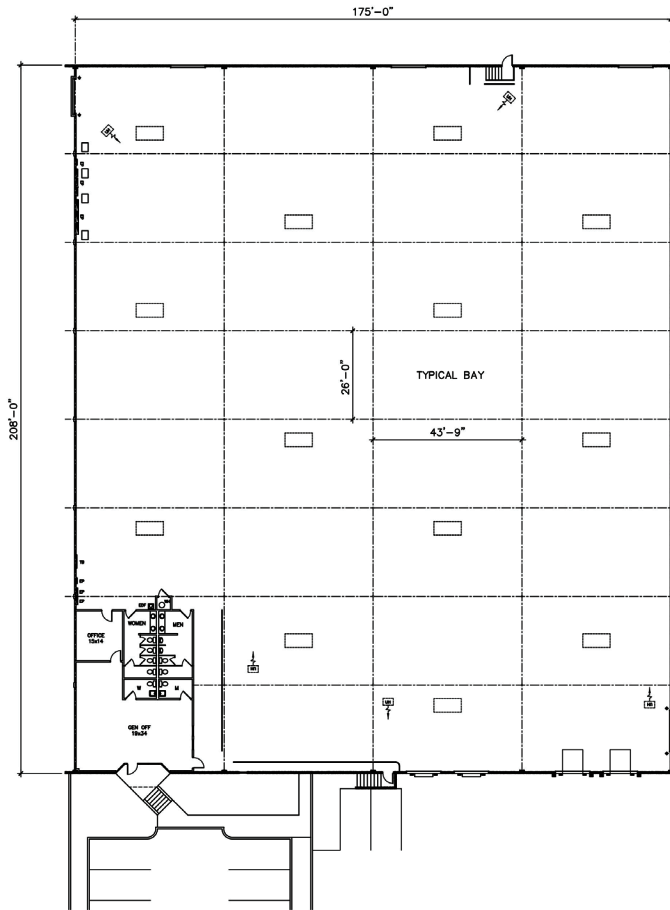

FLOOR PLAN

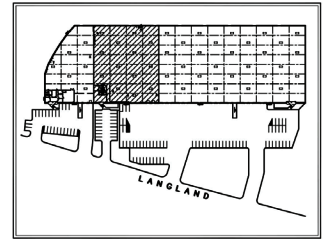

SITE PLAN

**4547 LANGLAND
FARMERS BRANCH, TX**

BUILDING SUMMARY

OFFICE	1,637 SF
WAREHOUSE	34,763 SF
TOTAL	36,400 SF

Transwestern

Brett Owens, SIOR
brett.owens@transwestern.com

Timothy Veler, CCIM
timothy.veler@transwestern.com

Colony Industrial

Jerod Hangartner
jhangartner@clns.com

5001 Spring Valley Rd., Ste. 400W
Dallas, Texas 75244
Office 972.774.2568

5001 Spring Valley Rd., Suite 400W
Dallas, Texas 75244
Office 972.774.2541

13727 Noel Road, Suite 750
Dallas, Texas 75240
Office 972.893.7000