

FOR LEASE

3526 N. Comotara, Wichita, Kansas



Comotara Industrial Building

Located in NE Wichita, and less than half a mile away from K-96, the Comotara Industrial Building grants its users easy access to all of Wichita and the surrounding areas from one convenient location. This spacious warehouse features roll-up doors, dock-high doors, overhead doors and can be efficiently used as an office/warehouse/distribution center for any business of all industries.

- 18' Clear Height
- Approx. 1,500 SF of office space
- External Roll-up/Overhead Doors
- Dock Doors

Space Available:
Suite 4 – 100'x200' (20,000 SF)

Lease Rate: Negotiable
Lease Type: NNN
NNN Rate: \$2.00



FRED ELMER
fred@occmgmt.com
T: 316-262-3331
C: 620-687-4059

8111 E. 32nd St. N., Suite 101
Wichita, KS 67226

www.occmgmt.com
occidental@occmgmt.com

FLOOR PLAN

3526 N. Comotara, Wichita, Kansas

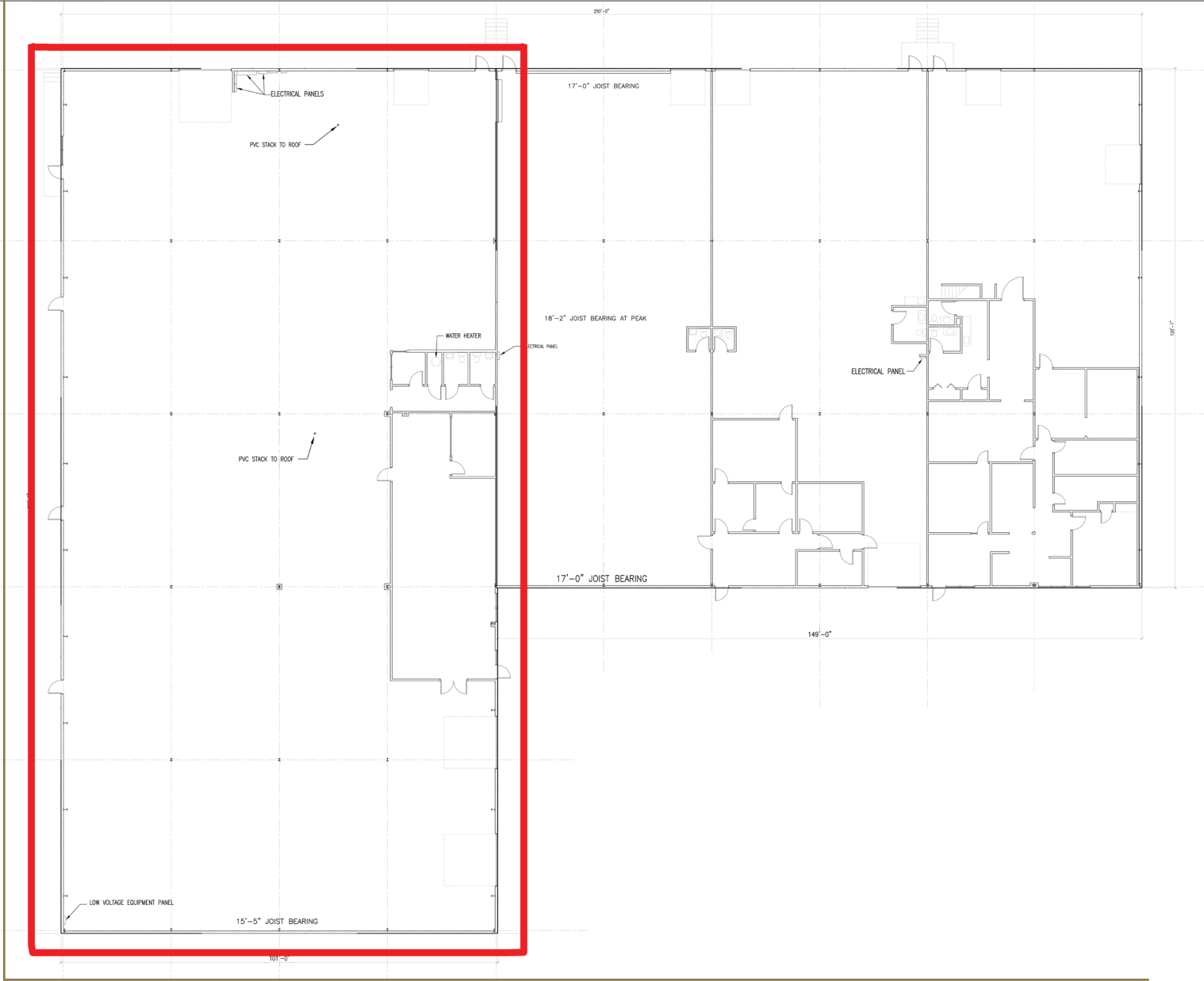

FRED ELMER
fred@occmgmt.com
T: 316-262-3331
C: 620-687-4059

8111 E. 32nd St. N., Suite 101
Wichita, KS 67226

www.occmgmt.com
occidental@occmgmt.com

PHOTOS

3526 N. Comotara, Wichita, Kansas



FRED ELMER
fred@occmgmt.com
T: 316-262-3331
C: 620-687-4059

8111 E. 32nd St. N., Suite 101
Wichita, KS 67226

www.occmgmt.com
occidental@occmgmt.com

AERIAL

3526 N. Comotara, Wichita, Kansas



FRED ELMER
fred@occmgmt.com
T: 316-262-3331
C: 620-687-4059

8111 E. 32nd St. N., Suite 101
Wichita, KS 67226

www.occmgmt.com
occidental@occmgmt.com